

### SOIL/SITE EVALUATION for ON-SITE WASTEWATER SYSTEM

Owner:

Applicant:

Address:

Date Evaluated:

Proposed Facility: \_\_\_\_\_ Design Flow (.1949): \_\_\_\_\_

Property Size: \_\_\_\_\_

Location of Site:

Property Recorded:

Water Supply:  Public  Individual  Well

Spring  Other

Evaluation Method:  Auger Boring  Pit

Cut

Type of Wastewater:  Sewage  Industrial Process

Mixed

P R O F I L E #	1940 Landscape Position/ Slope%	Horizon Depth (IN.)	SOIL MORPHOLOGY .1941		OTHER PROFILE FACTORS				Profile Class & LTAR
			.1941 Structure/ Texture	.1941 Consistence Mineralogy	.1942 Soil Wetness/ Color	.1943 Soil Depth (IN.)	.1956 Sapro Class	.1944 Restr Horiz	
1		0-12	G SL	VFR NS/np					PS 3
		12-30	SBK SL	F S/P					
		30"	250' (6.1M)						
2		0-24	G SL						PS 7
		24-32"	SBK SL	F S/P	BELOW TERR. @ 32"				

Description	Initial System	Repair System
Available Space (.1945)		
System Type(s)		
Site LTAR		

Other Factors (.1946): \_\_\_\_\_

Site Classification (.1948): \_\_\_\_\_

Evaluated By: \_\_\_\_\_

Others Present: \_\_\_\_\_

COMMENTS: \_\_\_\_\_  
 \_\_\_\_\_  
 \_\_\_\_\_

<u>LANDSCAPE POSITIONS</u>	<u>GROUP</u>	<u>TEXTURES</u>	<u>.1955 LTAR</u>	<u>CONSISTENCE MOIST</u>	<u>WET</u>
R-RIDGE	I	S-SAND	1.2 - 0.8	VFR-VERY FRIABLE FR-FRIABLE FI-FIRM VFI-VERY FIRM EFI-EXTREMELY FIRM	NS-NON-STICKY SS-SLIGHTLY STICKY S-STICKY VS-VERY STICKY NP-NON-PLASTIC SP-SLIGHTLY STICKY P-PLASTIC VP-VERY PLASTIC
S-SHOULDER SLOPE		LS-LOAMY SAND			
L-LINEAR SLOPE	II	SL-SANDY LOAM	0.8 - 0.6		
FS-FOOT SLOPE		L-LOAM			
N-NOSE SLOPE	III	SI-SILT-	0.6 - 0.3		
H-HEAD SLOPE		SIL-SILT LOAM			
CC-CONCLAVE SLOPE		CL-CLAY LOAM			
CV-CONVEX SLOPE		SCL-SANDY CLAY LOAM			
T-TERRACE	IV	SIC-SILTY CLAY	0.4 - 0.1		
FP-FLOOD PLAN		C-CLAY			
		SC-SANDY CLAY			

STRUCTURE  
 SG-SINGLE GRAIN  
 M-MASSIVE  
 CR-CRUMB  
 GR-GRANULAR  
 SBK-SUBANGULAR BLOCKY  
 ABK-ANGULAR BLOCKY  
 PL-PLATY  
 PR-PRISMATIC

MINERALOGY  
 SLIGHTLY EXPANSIVE  
 EXPANSIVE

Show profile locations and other site features (dimensions, reference or benchmark, and North).

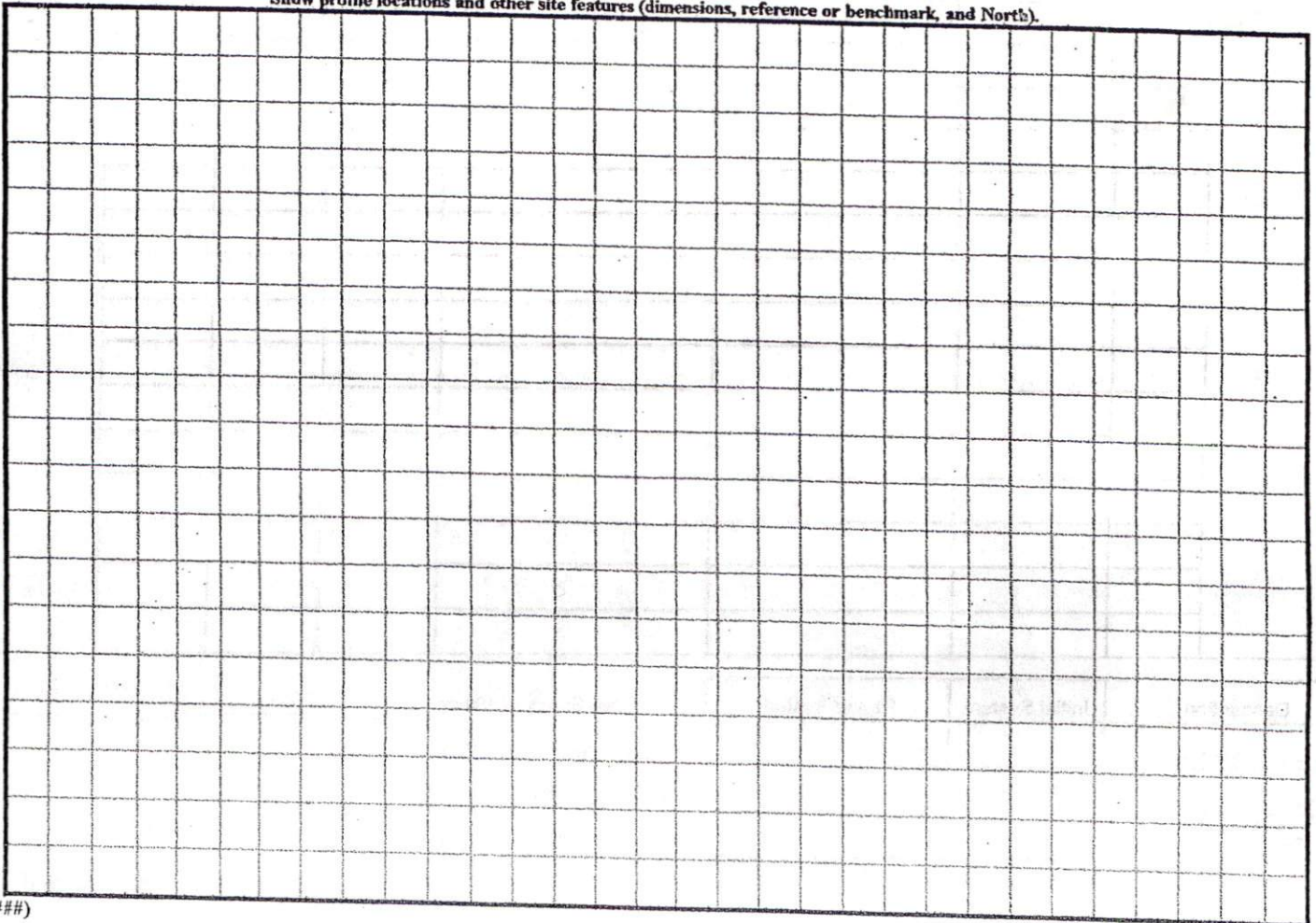

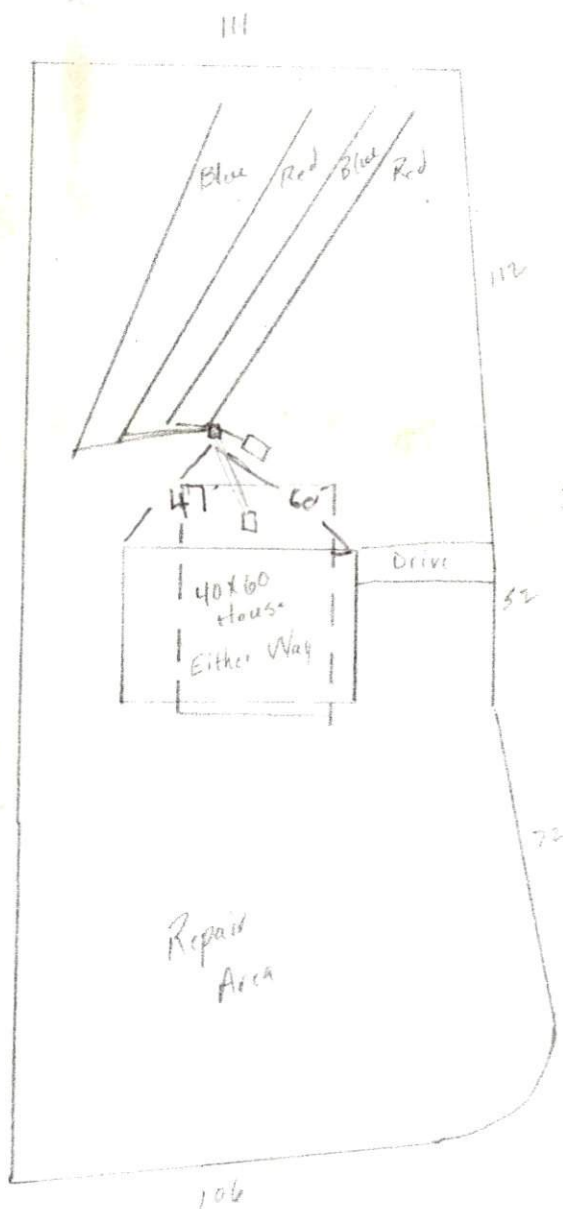

Wild Winds

Lot 12

Scale 1" = 250'

Subdivision Rd



HWY 55