

IMPROVEMENT PERMIT

21110

HTE 03-5-8340

Be it ordained by the Harnett County Board of Health as follows: Section III, Item B. "No Person shall begin construction of any building at which a septic tank system is to be used for disposal of sewage without first obtaining a written permit from the Harnett County Health Department."

Name: (owner) Atkins Place LLC New Installation Septic Tank
 Property Location: SR# 1448 Atkins Place Rd. Repairs Nitrification Line

Subdivision Atkins Place Lot # 4

Tax ID # _____ Quadrant # _____

Number of Bedrooms Proposed: 3 Lot Size: .35 Ac

Basement with Plumbing: Garage:

Water Supply: Well Public Community

Distance From Well: 50 in ft.

Following is the minimum specifications for sewage disposal system on above captioned property. Subject to final approval.

Type of system: Conventional Other 25% Reduction System

Size of tank: Septic Tank: 1000 gallons Pump Tank: _____ gallons

Subsurface Drainage Field No. of ditches 3 exact length of each ditch 70 ft. width of ditches 3 ft. depth of ditches 24-18 in.

French Drain Required: _____ Linear feet

Date: 12/29/2007

This permit is subject to revocation if site plans or intended use change.

Signed: Bryan McSwain D.S.
 Environmental Health Specialist

- * Maintain all setbacks
- * Start ditches at 24 inches
- ↓ Run to 18 inches

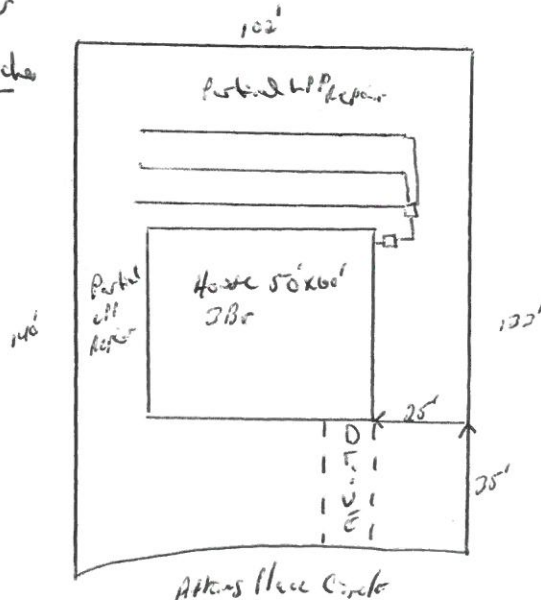

**HARNETT COUNTY HEALTH DEPARTMENT
AUTHORIZATION TO CONSTRUCT**

Authorization is hereby given to construct a wastewater system to the specifications described by Harnett County Health Department, Improvement Permit # 21110. This authorization shall be valid for a period not to exceed five (5) years from the date of issuance. *This authorization will be invalid if ownership, site plans, or intended use change.*

Name Atkins Place LLC Telephone# 919-639-7424 Keith

Address 72 Overlook Court Ayden, N.C. 27501

Property Location SR# 1448 Road Name Atkins

Subdivision Atkins Place Lot # 4 # Bedrooms Proposed 3 Lot Size .35 Ac

TYPE OF SYSTEM

New Installation Repair Septic Tank Nitrification Lines

Conventional Other 25% Reduction System

Basement With Plumbing Without Plumbing

Water Supply: Well Public Water Supply Minimum Well Setback: 50 Ft.

Septic Tank 1000 gal Pump Chamber gal

NITRIFICATION FIELD SPECIFICATIONS

Number of fields 1 # of lines per field 3 Length of lines 70 Ft.

Width of ditches 3 ft. Depth of ditches 24-18 inches

French Drain: Linear feet required Depth of gravel

No wastewater system shall be covered or placed into use by any person until an inspection by the Harnett County Health Department has determined that the system has been installed according to the conditions of the Improvement Permit and that a valid Operations Permit has been issued.

Byron McLean R.S.
Signature of Authorized Agent for Harnett County of Harnett

12/29/2007
Date