

HTE 03-5-8250

IMPROVEMENT PERMIT

21104

Be it ordained by the Harnett County Board of Health as follows: Section III, Item B. "No Person shall begin construction of any building at which a septic tank system is to be used for disposal of sewage without first obtaining a written permit from the Harnett County Health Department."

Name: (owner) Eric Flowers☒ New Installation☒ Septic TankProperty Location: SR# 2013 Avery Rd☐ Repairs☒ Nitrification LineSubdivision Della LaneLot # 3

Tax ID # _____

Quadrant # _____

Number of Bedrooms Proposed: 3Lot Size: 2.39 AcBasement with Plumbing: ☐Garage: ☒Water Supply: ☐ Well☒ Public☐ CommunityDistance From Well: 50 m ft.

Following is the minimum specifications for sewage disposal system on above captioned property. Subject to final approval.

Type of system:

☐ Conventional☒ Other Pump to Conventional

Size of tank:

Septic Tank: 1000 gallonsPump Tank: 1000 gallons

Subsurface

No. of

Drainage Field

ditches 4

exact length

of each ditch 90 ft.

width of

ditches 3 ft.

depth of

ditches 18-22 in.

French Drain Required: _____ Linear feet

Date: 12/3/2003

This permit is subject to revocation if site plans or intended use change.

Signed: Bryon McSwain R.S.

Environmental Health Specialist

* Maintain all setbacks
* Run ditches on contour

* Area for system was
Flagged on 1/14/2004 to prevent
vehicular traffic

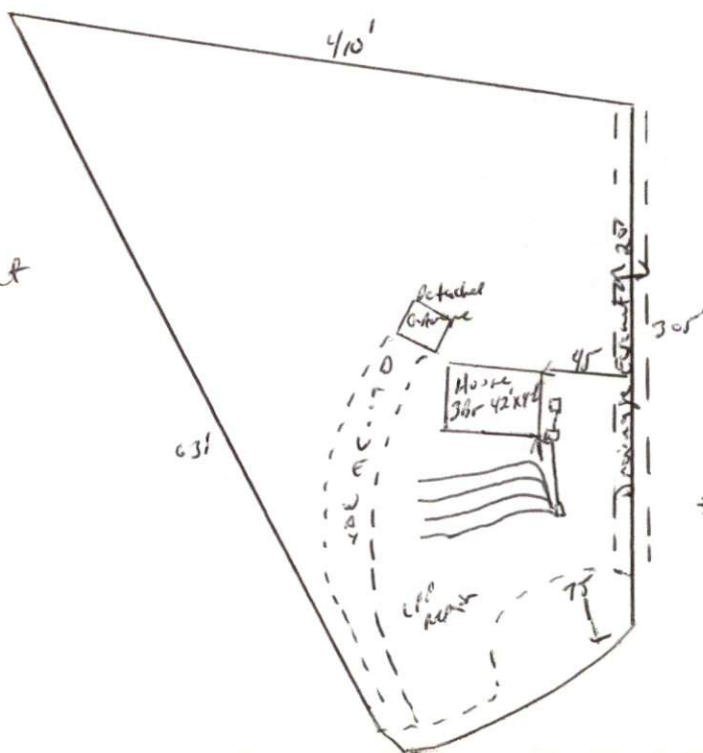

HARNETT COUNTY HEALTH DEPARTMENT
AUTHORIZATION TO CONSTRUCT

Authorization is hereby given to construct a wastewater system to the specifications described by Harnett County Health Department, Improvement Permit # 21104. This authorization shall be valid for a period not to exceed five (5) years from the date of issuance. This authorization will be invalid if ownership, site plans, or intended use change.

Name Eric Flowers Telephone# 893-4692
Address P.O. 1482 Lillington, N.C. 27546
Property Location SR# 2013 Road Name Avery
Subdivision Della Lane Lot # 3 # Bedrooms Proposed 3 Lot Size 2.39 Ac.

TYPE OF SYSTEM

☒ New Installation ☐ Repair ☐ Septic Tank ☐ Nitrification Lines
☐ Conventional ☒ Other Pump to Conventional
☐ Basement ☐ With Plumbing ☐ Without Plumbing

Water Supply: ☐ Well ☒ Public Water Supply Minimum Well Setback: 50 Ft.
Septic Tank 1000 gal Pump Chamber 1000 gal

NITRIFICATION FIELD SPECIFICATIONS

Number of fields 1 # of lines per field 4 Length of lines 90 Ft.
Width of ditches 3 ft. Depth of ditches 18-22 inches
French Drain: Linear feet required _____ Depth of gravel _____

No wastewater system shall be covered or placed into use by any person until an inspection by the Harnett County Health Department has determined that the system has been installed according to the conditions of the Improvement Permit and that a valid Operations Permit has been issued.

Bryan McLean R. I.
Signature of Authorized Agent for Harnett County of Harnett

12/15/2007
Date