

HTE03-5-8223

IMPROVEMENT PERMIT

Be it ordained by the Harnett County Board of Health as follows: Section III, Item B. "No Person shall begin construction of any building at which a septic tank system is to be used for disposal of sewage without first obtaining a written permit from the Harnett County Health Department."

Name: (owner) WILLIAM BELLINGS New Installation Septic Tank
 Property Location: SR# 1443 LAFAYETTE Repairs Nitrification Line

Subdivision Victoria Hills Lot # 177

Tax ID # _____ Quadrant # _____

Number of Bedrooms Proposed: 3 Lot Size: 1.75 acres

Basement with Plumbing: Garage:

Water Supply: Well Public Community

Distance From Well: 50' ft.

Following is the minimum specifications for sewage disposal system on above captioned property. Subject to final approval.

Type of system: Conventional Other _____

Size of tank: Septic Tank: 1000 gallons Pump Tank: _____ gallons

Subsurface Drainage Field No. of ditches 3 exact length of each ditch 100 ft. width of ditches 3 ft. depth of ditches 22-28 in.

French Drain Required: - Linear feet

Date: 12-17-03

This permit is subject to revocation if site plans or intended use change.

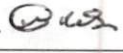
Signed: James E. Mawhart 
 Environmental Health Specialist

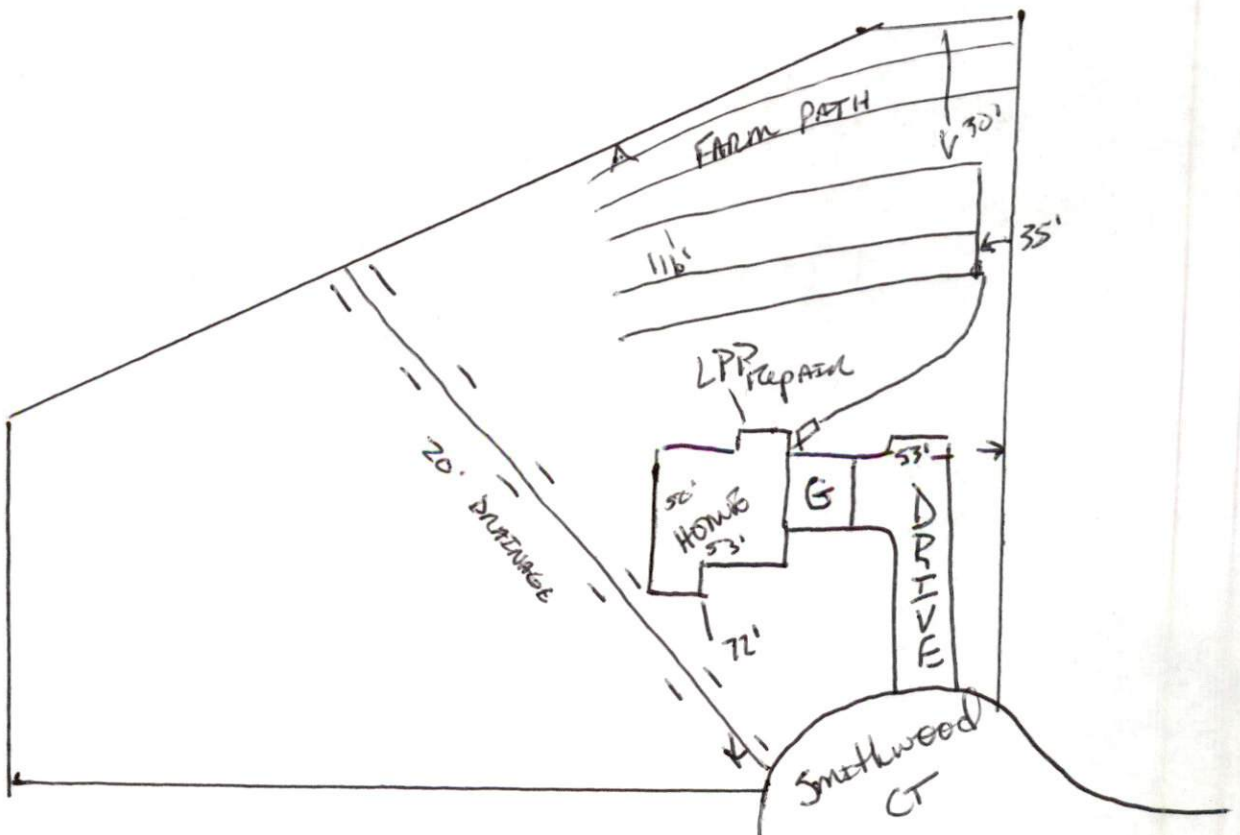

#03-5-8223

HARNETT COUNTY HEALTH DEPARTMENT AUTHORIZATION TO CONSTRUCT

Authorization is hereby given to construct a wastewater system to the specifications described by Harnett County Health Department, Improvement Permit # 20332. This authorization shall be valid for a period not to exceed five (5) years from the date of issuance. This authorization will be invalid if ownership, site plans, or intended use change.

Name William Bellows Telephone# 919-795-9464

Address 10012 Crews Chapel Hill N.C. 27517

Property Location SR# 1443 Road Name Lafayette

Subdivision Victoria Hills Lot # 177 # Bedrooms Proposed 3 Lot Size 1.75

TYPE OF SYSTEM

New Installation Repair Septic Tank Nitrification Lines

Conventional Other _____

Basement With Plumbing Without Plumbing

Water Supply: Well Public Water Supply Minimum Well Setback: _____ Ft.

Septic Tank 1000 gal Pump Chamber _____ gal

NITRIFICATION FIELD SPECIFICATIONS

Number of fields 2 # of lines per field 3 Length of lines 100 Ft.

Width of ditches 3 ft. Depth of ditches 22-218 inches

French Drain: Linear feet required _____ Depth of gravel _____

No wastewater system shall be covered or placed into use by any person until an inspection by the Harnett County Health Department has determined that the system has been installed according to the conditions of the Improvement Permit and that a valid Operations Permit has been issued.

Signature of Authorized Agent for Harnett County of Harnett James C. Marham

Date 12-17-03