

HTE 03-5-8097

IMPROVEMENT PERMIT

Be it ordained by the Harnett County Board of Health as follows: Section III, Item B. "No Person shall begin construction of any building at which a septic tank system is to be used for disposal of sewage without first obtaining a written permit from the Harnett County Health Department."

Name: (owner) Weaver Dev.
Property Location: SR# 1141
New Installation, Septic Tank, Repairs, Nitrification Line

Subdivision The Summit Lot # 26

Tax ID # Quadrant #

Number of Bedrooms Proposed: 3(32x48) Lot Size: 1/3 ac

Basement with Plumbing: Garage:
Water Supply: Well, Public, Community
Distance From Well: 50 ft.

Following is the minimum specifications for sewage disposal system on above captioned property. Subject to final approval.

Type of system: Conventional, Other

Size of tank: Septic Tank: 1000 gallons Pump Tank: gallons

Subsurface Drainage Field No. of ditches, exact length of each ditch, width of ditches, depth of ditches

French Drain Required: Linear feet

Date: 11-17-03

Signed: [Signature] Environmental Health Specialist

This permit is subject to revocation if site plans or intended use change.

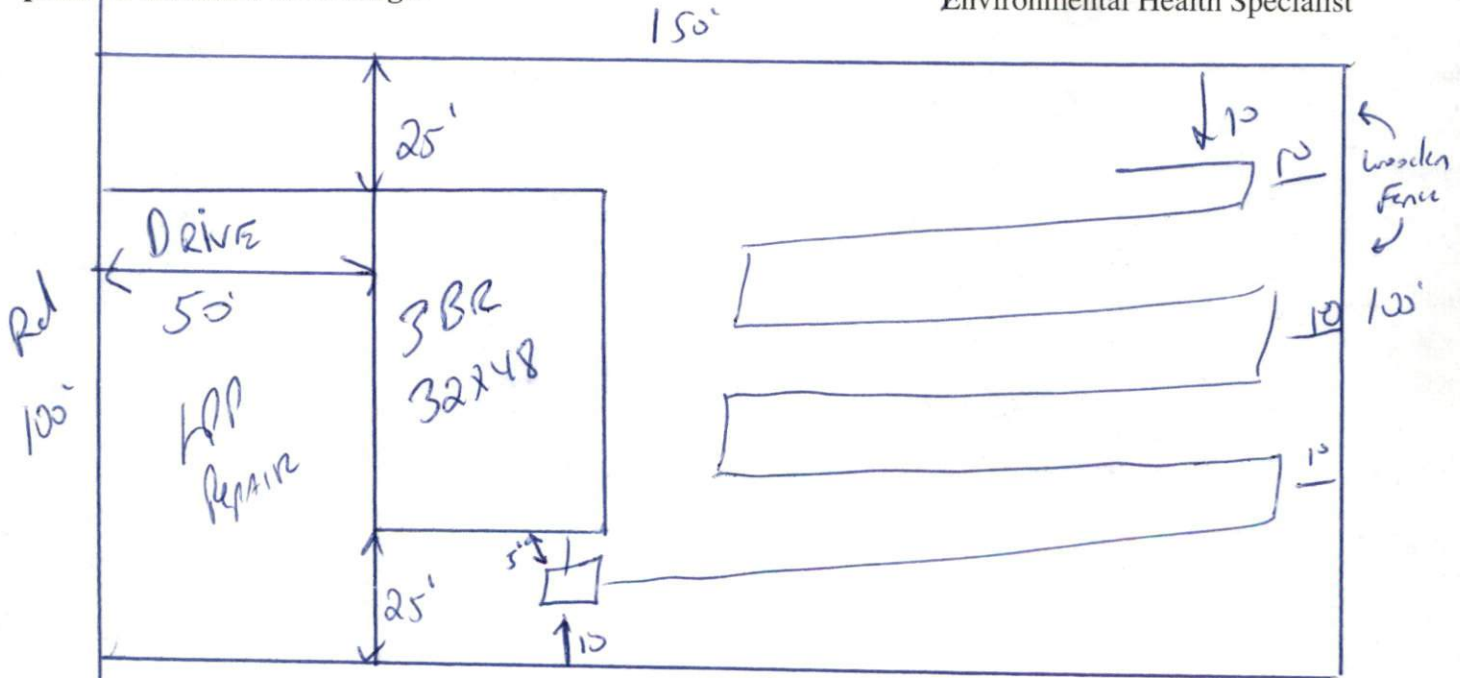

Stud out Plumbing shallow where shown. Maintain All set Back

HARNETT COUNTY HEALTH DEPARTMENT  
AUTORIZATION TO CONSTRUCT

Authorization is hereby given to construct a wastewater system to the specifications described by Harnett County Health Department, Improvement Permit # 20380. This authorization shall be valid for a period not to exceed five (5) years from the date of issuance. This authorization will be invalid if ownership, site plans, or intended use change.

Weaver Desi  
Name \_\_\_\_\_ Telephone# \_\_\_\_\_

Address \_\_\_\_\_

1141

Property Location SR# \_\_\_\_\_ Road Name \_\_\_\_\_

The Summit 26 3 (32x48) BR  
Subdivision Lot # # Bedrooms Proposed Lot Size

TYPE OF SYSTEM

New Installation  Repair  Septic Tank  Nitrification Lines

Conventional  Other \_\_\_\_\_

Basement  With Plumbing  Without Plumbing

Water Supply:  Well  Public Water Supply Minimum Well Setback: \_\_\_\_\_ Ft.

Septic Tank 1000' gal Pump Chamber \_\_\_\_\_ gal

NITIRIFICATION FIELD SPECIFICATIONS

Number of fields 1 # of lines per field 1 Length of lines 200 Ft.

Width of ditches 3 ft. Depth of ditches 18.24 inches

French Drain: Linear feet required \_\_\_\_\_ Depth of gravel \_\_\_\_\_

No wastewater system shall be covered or placed into use by any person until an inspection by the Harnett County Health Department has determined that the system has been installed according to the conditions of the Improvement Permit and that a valid Operations Permit has been issued.

[Signature] \_\_\_\_\_ 11-17-07  
Signature of Authorized Agent for Harnett County of Harnett Date