

HTE 03-5 800

# IMPROVEMENT PERMIT

Be it ordained by the Harnett County Board of Health as follows: Section III, Item B. "No Person shall begin construction of any building at which a septic tank system is to be used for disposal of sewage without first obtaining a written permit from the Harnett County Health Department."

Name: (owner) Danny Norris  New Installation  Septic Tank  
Property Location: SR# 1115  Repairs  Nitrification Line

Subdivision Peach Tree Lot # 74

Tax ID # \_\_\_\_\_ Quadrant # \_\_\_\_\_

Number of Bedrooms Proposed: 3 (46x41) Lot Size: .482 Ac

Basement with Plumbing:  Garage:  NOTE CHANGES IN HOUSE LOCATION.  
Water Supply:  Well  Public  Community  
Distance From Well: 50 ft.

Following is the minimum specifications for sewage disposal system on above captioned property. Subject to final approval.

Type of system:  Conventional  Other Pump to Conventional

Size of tank: Septic Tank: 1000 gallons Pump Tank: 1000 gallons

Subsurface Drainage Field No. of ditches 4 exact length of each ditch 60 ft. width of ditches 3 ft. depth of ditches 18 1/4 in.

French Drain Required: \_\_\_\_\_ Linear feet Date: 11-11-03

This permit is subject to revocation if site plans or intended use change.

Signed: Joe W. [Signature]  
Environmental Health Specialist

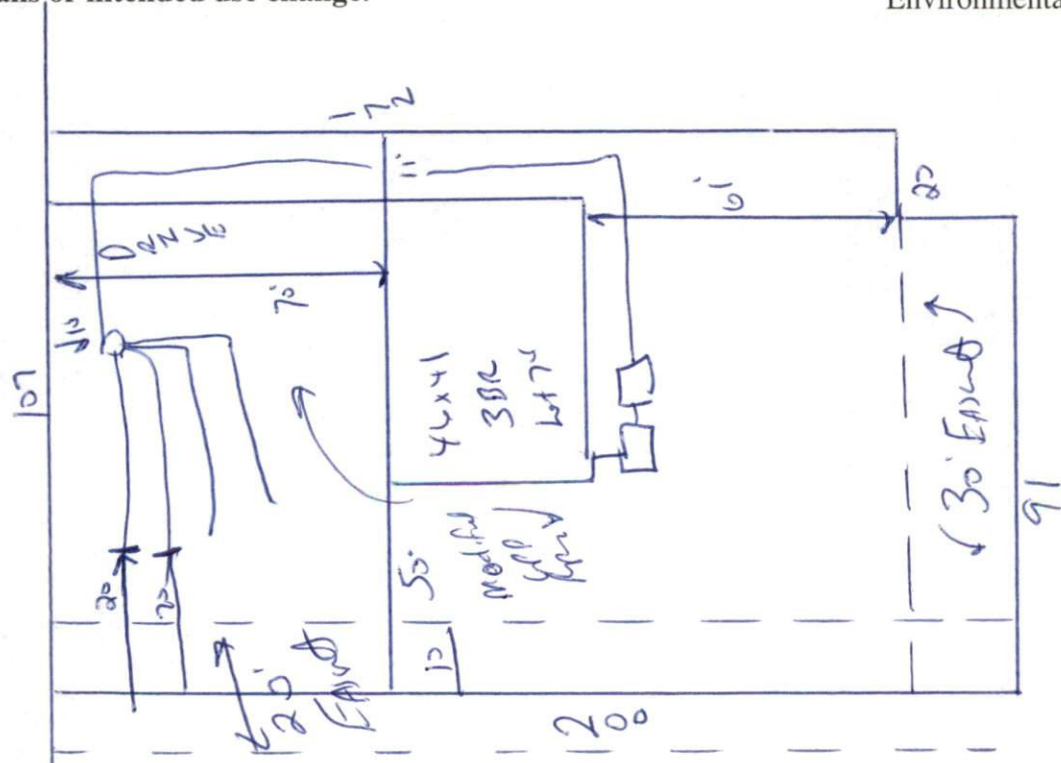

NOTE CHANGES IN HOUSE LOCATION MAINTAIN ALL SET BACKS MUST MEET ON SITE

HARNETT COUNTY HEALTH DEPARTMENT  
AUTORIZATION TO CONSTRU

Authorization is hereby given to construct a wastewater system to the specifications described by Harnett County Health Department, Improvement Permit # 20372. This authorization shall be valid for a period not to exceed five (5) years from the date of issuance. This authorization will be invalid if ownership, site plans, or intended use change.

Danny W. Greer  
Name \_\_\_\_\_ Telephone# \_\_\_\_\_

Address \_\_\_\_\_

1115  
Property Location SR# \_\_\_\_\_ Road Name \_\_\_\_\_

Peachtree 24 3 (46x41) 48200  
Subdivision Lot # # Bedrooms Proposed Lot Size

**TYPE OF SYSTEM**

New Installation  Repair  Septic Tank  Nitrification Lines

Conventional  Other Pump to Conventional

Basement  With Plumbing  Without Plumbing

Water Supply:  Well  Public Water Supply Minimum Well Setback: 50 Ft.

Septic Tank 1000 gal Pump Chamber 1000 gal

**NITRIFICATION FIELD SPECIFICATIONS**

Number of fields 1 # of lines per field 4 Length of lines 60 Ft.

Width of ditches 3 ft. Depth of ditches 18-24 inches

French Drain: Linear feet required \_\_\_\_\_ Depth of gravel \_\_\_\_\_

No wastewater system shall be covered or placed into use by any person until an inspection by the Harnett County Health Department has determined that the system has been installed according to the conditions of the Improvement Permit and that a valid Operations Permit has been issued.

[Signature] \_\_\_\_\_ 11-11-07  
Signature of Authorized Agent for Harnett County of Harnett Date