

HTE 03-5-7999

# IMPROVEMENT PERMIT

Be it ordained by the Harnett County Board of Health as follows: Section III, Item B. "No Person shall begin construction of any building at which a septic tank system is to be used for disposal of sewage without first obtaining a written permit from the Harnett County Health Department."

Name: (owner) WILSON BUILT HOMES  New Installation  Septic Tank  
Property Location: SR# 1437 BALLARD RD  Repairs  Nitrification Line

Subdivision BALLARD WOODS Lot # 45

Tax ID # \_\_\_\_\_ Quadrant # \_\_\_\_\_

Number of Bedrooms Proposed: 3 Lot Size: .574 ac

Basement with Plumbing:  Garage:

Water Supply:  Well  Public  Community

Distance From Well: 100 ft.

**Following is the minimum specifications for sewage disposal system on above captioned property. Subject to final approval.**

Type of system:  Conventional  Other \_\_\_\_\_

Size of tank: Septic Tank: 1000 gallons Pump Tank: \_\_\_\_\_ gallons

Subsurface Drainage Field No. of ditches 4 exact length of each ditch 75 ft. width of ditches 3 ft. depth of ditches 24 in.

French Drain Required: \_\_\_\_\_ Linear feet

Date: 10/17/03

Signed: [Signature] RS  
Environmental Health Specialist

**This permit is subject to revocation if site plans or intended use change.**

\*MAINTAIN ALL SETBACKS

\*CALL WITH ANY QUESTIONS PRIOR TO INSTALLATION

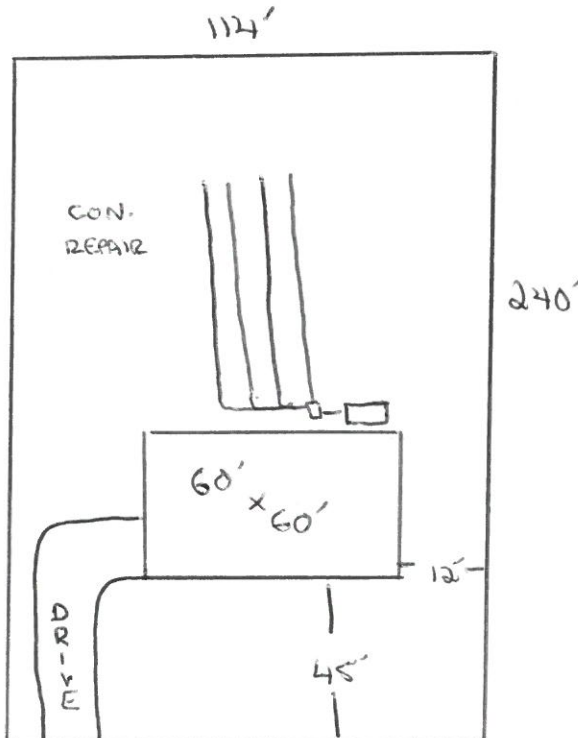

HARNETT COUNTY HEALTH DEPARTMENT  
AUTORIZATION TO CONSTRUCT

Authorization is hereby given to construct a wastewater system to the specifications described by Harnett County Health Department, Improvement Permit # 20241. This authorization shall be valid for a period not to exceed five (5) years from the date of issuance. This authorization will be invalid if ownership, site plans, or intended use change.

Name WILSON BUILT HOMES Telephone# 919-215-9861  
Address PO BOX 6127 RALEIGH NC 27501  
Property Location SR# 1437 BALLARD RD Road Name  
Subdivision BALLARD WOODS Lot # 45 # Bedrooms Proposed 3 Lot Size 574 AC

TYPE OF SYSTEM

New Installation [ ] Repair  Septic Tank  Nitrification Lines

Conventional [ ] Other \_\_\_\_\_

[ ] Basement [ ] With Plumbing [ ] Without Plumbing

Water Supply: [ ] Well  Public Water Supply Minimum Well Setback: 100 Ft.

Septic Tank 1000 gal Pump Chamber \_\_\_\_\_ gal

NITRIFICATION FIELD SPECIFICATIONS

Number of fields 1 # of lines per field 4 Length of lines 75 Ft.

Width of ditches 3 ft. Depth of ditches 24 inches

French Drain: Linear feet required \_\_\_\_\_ Depth of gravel \_\_\_\_\_

No wastewater system shall be covered or placed into use by any person until an inspection by the Harnett County Health Department has determined that the system has been installed according to the conditions of the Improvement Permit and that a valid Operations Permit has been issued.

[Signature] RS  
Signature of Authorized Agent for Harnett County of Harnett

10/17/03  
Date