

**SOIL/SITE EVAL ION**  
**for ON-SITE WASTEWATER SYSTEM**

Owner: \_\_\_\_\_ Applicant: \_\_\_\_\_  
 Address: \_\_\_\_\_ Date Evaluated: \_\_\_\_\_  
 Proposed Facility: \_\_\_\_\_ Design Flow (.1949): \_\_\_\_\_ Property Size: \_\_\_\_\_  
 Location of Site: \_\_\_\_\_ Property Recorded: \_\_\_\_\_  
 Water Supply:  Public  Individual  Well  Spring  Other  
 Evaluation Method:  Auger Boring  Pit  Cut  
 Type of Wastewater:  Sewage  Industrial Process  Mixed

P R O F I L E #	1940 Landscape Position/ Slope%	SOIL MORPHOLOGY 1941		OTHER PROFILE FACTORS					Profile Class & LTAR
		Horizon Depth (IN.)	1941 Structure/ Texture	1941 Consistence Mineralogy	1942 Soil Wetness/ Color	1943 Soil Depth (IN.)	1956 Sapro- Class	1944 Restr. Horiz	
5		0-20"	G SL						R5 4
		20-36"	SBK SL		CR2 @ 36"				
6		0-8"	G SL						R5 4
		8-30"	SBK SCL		CR2 @ 24"				

Description	Initial System	Repair System
Available Space (.1945)		
System Type(s)		
Site LTAR		

Other Factors (.1946): \_\_\_\_\_  
 Site Classification (.1948): \_\_\_\_\_  
 Evaluated By: \_\_\_\_\_  
 Others Present: \_\_\_\_\_

COMMENTS:

LANDSCAPE POSITIONS	GROUP	TEXTURES	.1955 LTAR	CONSISTENCE MOIST	WET
R-RIDGE	I	S-SAND	1.2 - 0.8	VFR-VERY FRIABLE	NS-NON-STICKY
S-SHOULDER SLOPE		LS-LOAMY SAND			
L-LINEAR SLOPE	II	SL-SANDY LOAM	0.8 - 0.6	FR-FRIABLE	SS-SLIGHTLY STICKY
FS-FOOT SLOPE		L-LOAM		FI-FIRM	S-STICKY
N-NOSE SLOPE				VFI-VERY FIRM	VS-VERY STICKY
H-HEAD SLOPE	III	SI-SILT-	0.6 - 0.3	EFI-EXTREMELY FIRM	NP-NON-PLASTIC
CC-CONCLAVE SLOPE		SIL-SILT LOAM			SP-SLIGHTLY STICKY
CV-CONVEX SLOPE		CL-CLAY LOAM			P-PLASTIC
T-TERRACE		SCL-SANDY CLAY LOAM			VP-VERY PLASTIC
FP-FLOOD PLAN		SICL-SILTY CLAY LOAM			
	IV	SIC-SILTY CLAY	0.4 - 0.1		
		C-CLAY			
		SC-SANDY CLAY			

STRUCTURE

- SG-SINGLE GRAIN
- M-MASSIVE
- CR-CRUMB
- GR-GRANULAR
- SBK-SUBANGULAR BLOCKY
- ABK-ANGULAR BLOCKY
- PL-PLATY
- PR-PRISMATIC

MINERALOGY

- SLIGHTLY EXPANSIVE
- EXPANSIVE

Show profile locations and other site features (dimensions, reference or benchmark, and North).

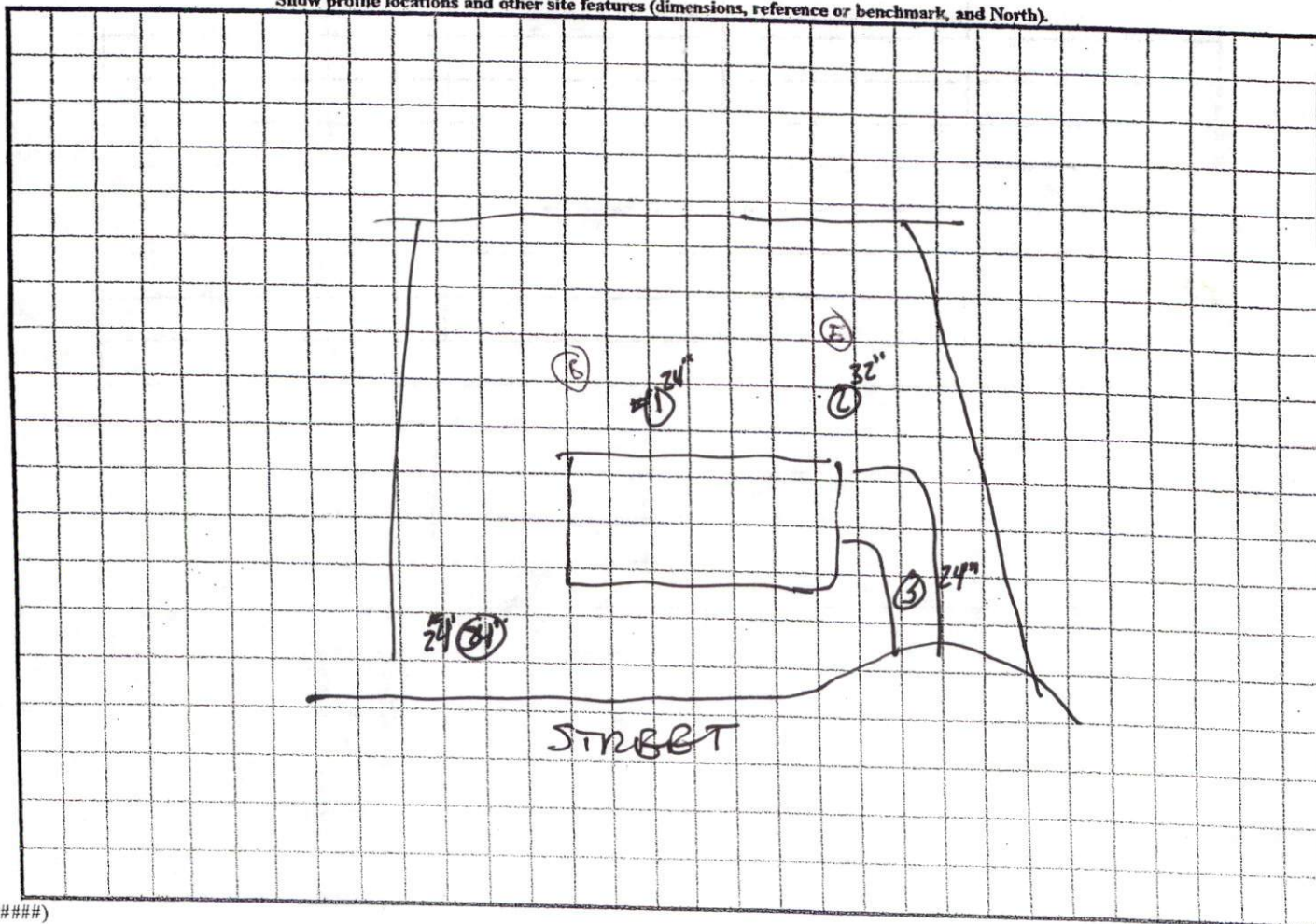

Malliss  
P. 6

D. B. 834, Pg. 943  
D. B. 1004, Pg. 768

Judy Frances Tripp  
D. B. 349, Pg. 288

Collins Tripp  
D. B. 642, Pg. 846

Control Point  
57°E 292.88' (Total)  
187.80'

Easement

15  
0.601 Ac.

14  
0.710 Ac.

12  
1.021 Ac.

10  
0.461 Ac.

11  
0.461 Ac.

18  
0.461 Ac.

19  
0.461 Ac.

20  
0.461 Ac.

21  
0.461 Ac.

60

The Plantation of  
Vineyard Green  
Phase One  
Sheet Two of Two

te:  
t 13 has been deleted.

8-15-03

Zoning Administrator

Future Development

