

HARNETT COUNTY HEALTH DEPARTMENT

No 19327

IMPROVEMENT PERMIT

Be it ordained by the Harnett County Board of Health as follows: Section III, Item B. "No Person shall begin construction of any building at which a septic tank system is to be used for disposal of sewage without first obtaining a written permit from the Harnett County Health Department."

Name: (owner) Michael Anderson Homes Inc
Property Location: SR# 1412 Christian Light
New Installation
Septic Tank
Repairs
Nitrification Line

Subdivision Mels Meadows Lot # 42

Tax ID # Quadrant #

Number of Bedrooms Proposed: 3 Lot Size: 39,798 sq ft

Basement with Plumbing: Garage:

Water Supply: Well Public Community

Distance From Well: 50 ft.

Following is the minimum specifications for sewage disposal system on above captioned property. Subject to final approval.

Type of system: Conventional Other

Size of tank: Septic Tank: 1000 gallons Pump Tank: gallons

Subsurface Drainage Field No. of ditches 4 exact length of each ditch 60 ft. width of ditches 3 ft. depth of ditches 18-20 in.

French Drain Required: Linear feet

Date: 8-18-03

This permit is subject to revocation if site plans or intended use change.

Signed: James E. Manhart Environmental Health Specialist

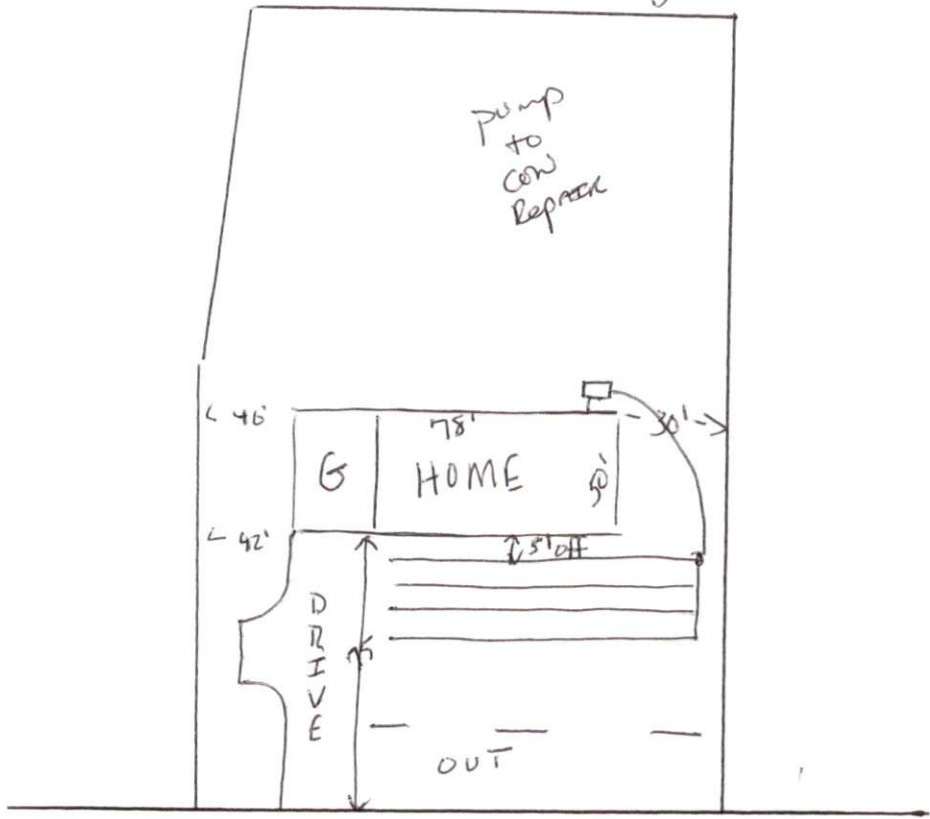

MELS MEADOW

#03-5-7598

HARNETT COUNTY HEALTH DEPARTMENT AUTORIZATION TO CONSTRUCT

Authorization is hereby given to construct a wastewater system to the specifications described by Harnett County Health Department, Improvement Permit # 19327. This authorization shall be valid for a period not to exceed five (5) years from the date of issuance. *This authorization will be invalid if ownership, site plans, or intended use change.*

Name Michael Anderson Homes Inc Telephone# 919-552-1790

Address 180 Woodland Ridge Drive F.V. N.C. 27526

Property Location SR# 1412 Road Name Christen Light

Subdivision Mels Meadow Lot # 42 # Bedrooms Proposed 3 Lot Size 39,798 sq ft

TYPE OF SYSTEM

- New Installation Repair Septic Tank Nitrification Lines
- Conventional Other FEEL 222 LAY TUNDS-SS-3R
- Basement With Plumbing Without Plumbing

Water Supply: Well Public Water Supply Minimum Well Setback: _____ Ft.

Septic Tank 1000 gal Pump Chamber _____ gal

NITRIFICATION FIELD SPECIFICATIONS

Number of fields 2 # of lines per field 4 Length of lines 60 Ft.

Width of ditches 3 ft. Depth of ditches 18-20 inches

French Drain: Linear feet required _____ Depth of gravel _____

No wastewater system shall be covered or placed into use by any person until an inspection by the Harnett County Health Department has determined that the system has been installed according to the conditions of the Improvement Permit and that a valid Operations Permit has been issued.

James S. Markert
Signature of Authorized Agent for Harnett County of Harnett

8-18-03
Date