

HTE 03-5-7291R

20388

IMPROVEMENT PERMIT

Be it ordained by the Harnett County Board of Health as follows: Section III, Item B. "No Person shall begin construction of any building at which a septic tank system is to be used for disposal of sewage without first obtaining a written permit from the Harnett County Health Department."

Name: (owner) Custom Contracting New Installation Septic Tank
Property Location: SR# 1201 Repairs Nitrification Line
Hunter's Ridge

Subdivision CAROLINA SEASON Lot # V-7

Tax ID # _____ Quadrant # _____

Number of Bedrooms Proposed: 3 (42x52) Lot Size: .42 AC

Basement with Plumbing: Garage:

Water Supply: Well Public Community

Distance From Well: 50 ft.

Following is the minimum specifications for sewage disposal system on above captioned property. Subject to final approval.

Type of system: Conventional Other _____

Size of tank: Septic Tank: 1000 gallons Pump Tank: _____ gallons

Subsurface Drainage Field No. of ditches 2 exact length of each ditch 120 ft. width of ditches 3 ft. depth of ditches 18 1/4 in.

French Drain Required: _____ Linear feet

Date: 11-19-03

This permit is subject to revocation if site plans or intended use change.

Signed: Jim White
Environmental Health Specialist

Meet onsite Before
INSTALLING
STUB out Plumbing
shallow (ground level)

MAINTAIN ALL
set Back

LPP
Repair

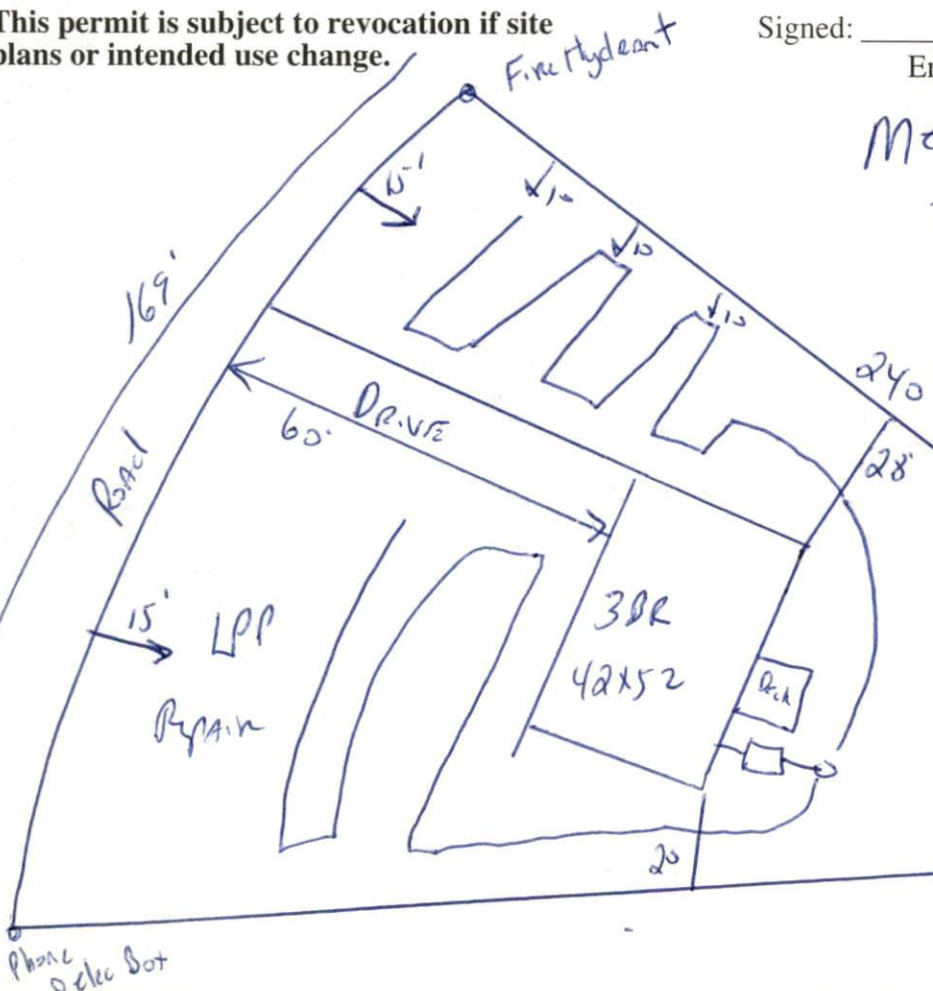

HARNETT COUNTY HEALTH DEPARTMENT
AUTORIZATION TO CONSTRU

Authorization is hereby given to construct a wastewater system to the specifications described by Harnett County Health Department, Improvement Permit # 20388. This authorization shall be valid for a period not to exceed five (5) years from the date of issuance. This authorization will be invalid if ownership, site plans, or intended use change.

Name Custom Contracting Telephone# _____

Address _____

Property Location SR# _____ Road Name _____

Subdivision Carolina Seawall Lot # V-7 # Bedrooms Proposed 3(42x52) Lot Size .42AC

TYPE OF SYSTEM

New Installation Repair Septic Tank Nitrification Lines

Conventional Other _____

Basement With Plumbing Without Plumbing

Water Supply: Well Public Water Supply Minimum Well Setback: 50 Ft.

Septic Tank 1000 gal Pump Chamber _____ gal

NITRIFICATION FIELD SPECIFICATIONS

Number of fields 6 # of lines per field 2 Length of lines 60 Ft.

Width of ditches 3 ft. Depth of ditches 1824 inches

French Drain: Linear feet required _____ Depth of gravel _____

No wastewater system shall be covered or placed into use by any person until an inspection by the Harnett County Health Department has determined that the system has been installed according to the conditions of the Improvement Permit and that a valid Operations Permit has been issued.

Signature of Authorized Agent for Harnett County of Harnett [Signature] Date 11-19-03