

Initial Application Date: 4/17/03

Application # 03-5-6937

COUNTY OF HARNETT LAND USE APPLICATION

Central Permitting

102 E. Front Street, Lillington, NC 27546

Phone: (910) 893-4759

Fax: (910) 893-2793

LANDOWNER: Mr. Kent Pierre Inc. Mailing Address: P.O. Box 42535  
City: Fayetteville State: NC Zip: 28309 Phone #: 910-424-1294

APPLICANT: Mr. Kent Pierre Inc. Mailing Address: P.O. Box 42535  
City: Fayetteville State: NC Zip: 28309 Phone #: 910-424-1294

PROPERTY LOCATION: SR #: 1115 SR Name: Buttala Lake Rd.  
Parcel: 02958908 0020 08 PIN: 9587-40-2176-000  
Zoning: R20R Subdivision: Peachtree Crossing Lot #: 80 Lot Size: .471 A  
Flood Plain: X Panel: 0075 Watershed: X Deed Book/Page: 01605/056 Plat Book/Page: 2000 761A

DIRECTIONS TO THE PROPERTY FROM LILLINGTON: Peachtree Crossing - Peachtree  
Ln - turn on Ribbon Oak Dr.  
1st down on left

PROPOSED USE:

- Sg. Family Dwelling (Size 50 x 30) # of Bedrooms 3 # Baths 2 1/2 Basement (w/wo bath) no Garage 24x24 Deck 12'x14'
- Multi-Family Dwelling No. Units \_\_\_\_\_ No. Bedrooms/Unit \_\_\_\_\_
- Manufactured Home (Size \_\_\_\_\_ x \_\_\_\_\_) # of Bedrooms \_\_\_\_\_ Garage \_\_\_\_\_ Deck \_\_\_\_\_
- Comments: \_\_\_\_\_
- Number of persons per household \_\_\_\_\_
- Business Sq. Ft. Retail Space \_\_\_\_\_ Type \_\_\_\_\_
- Industry Sq. Ft. \_\_\_\_\_ Type \_\_\_\_\_
- Home Occupation (Size \_\_\_\_\_ x \_\_\_\_\_) # Rooms \_\_\_\_\_ Use \_\_\_\_\_
- Accessory Building (Size \_\_\_\_\_ x \_\_\_\_\_) Use \_\_\_\_\_
- Addition to Existing Building (Size \_\_\_\_\_ x \_\_\_\_\_) Use \_\_\_\_\_
- Other \_\_\_\_\_

Water Supply:  County  Well (No. dwellings \_\_\_\_\_)  Other \_\_\_\_\_

Sewage Supply:  New Septic Tank  Existing Septic Tank  County Sewer  Other \_\_\_\_\_

Erosion & Sedimentation Control Plan Required? YES  NO

Structures on this tract of land: Single family dwellings one Manufactured homes \_\_\_\_\_ Other (specify) \_\_\_\_\_

Property owner of this tract of land own land that contains a manufactured home w/in five hundred feet (500') of tract listed above? YES  NO

Required Property Line Setbacks:	Minimum		Actual	
	Minimum	Actual	Minimum	Actual
Front	<u>35</u>	<u>45'</u>	Rear	<u>25</u>
Side	<u>10</u>	<u>24'</u>	Corner	<u>N/A</u>
Nearest Building	<u>N/A</u>	<u>N/A</u>		

If permits are granted I agree to conform to all ordinances and the laws of the State of North Carolina regulating such work and the specifications or plans submitted. I hereby swear that the foregoing statements are accurate and correct to the best of my knowledge.

[Signature]  
Signature of Applicant

4/17/03  
Date

\*\*This application expires 6 months from the date issued if no permits have been issued\*\*

A RECORDED SURVEY PLAT AND RECORDED DEED ARE REQUIRED WHEN APPLYING FOR A LAND USE PERMIT

297 4/30 S

1" = 30'

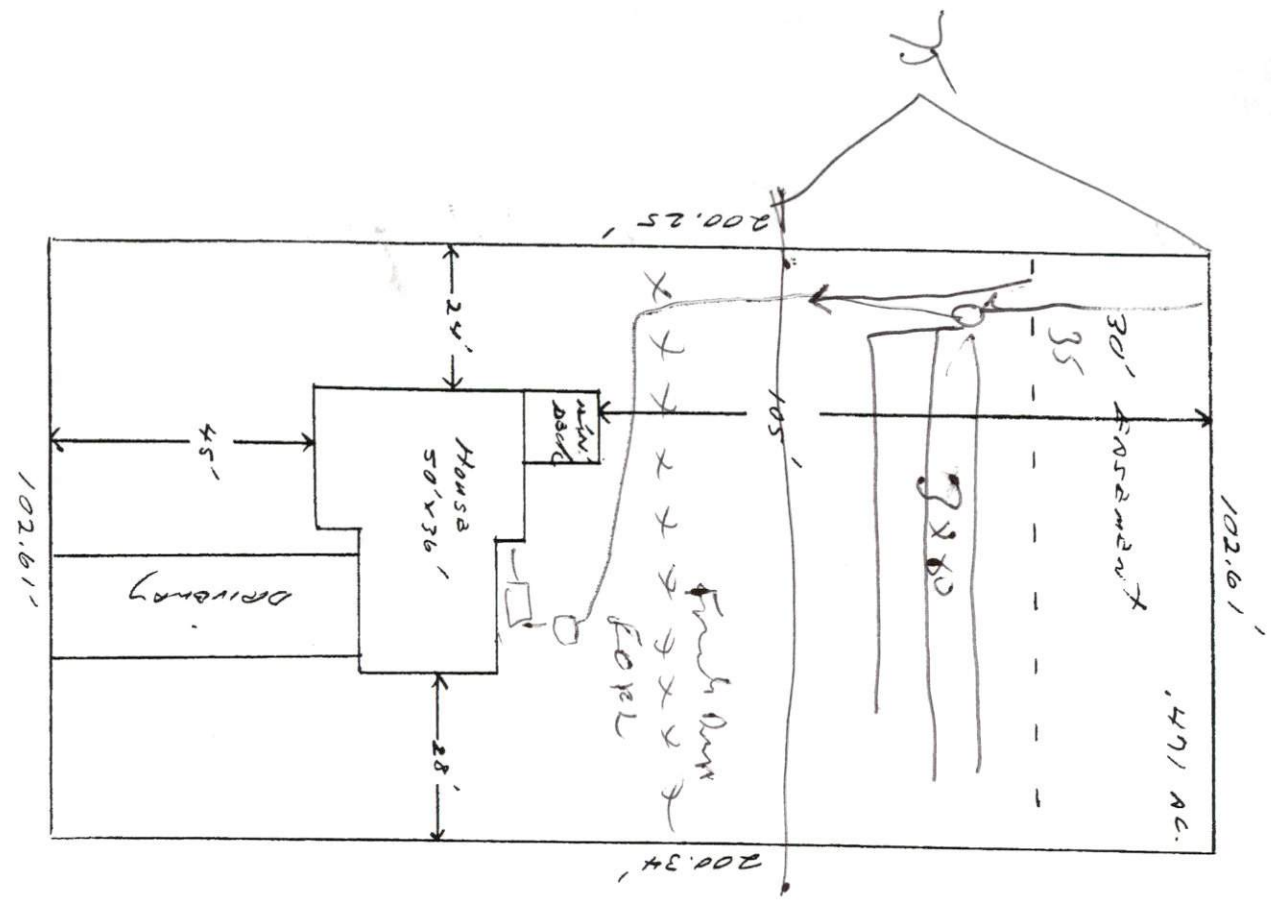

Wm. Kent Pierce Inc.  
Lot # 80 Birchwood Crossings

