

IMPROVEMENT PERMIT

03-5-6831

Be it ordained by the Harnett County Board of Health as follows: Section III, Item B. "No Person shall begin construction of any building at which a septic tank system is to be used for disposal of sewage without first obtaining a written permit from the Harnett County Health Department."

Name: (owner) STAFFORD Custom Homes
Property Location: SR# NC 87
New Installation
Septic Tank
Repairs
Nitrification Line

Subdivision STARWOOD @ Overhills Lot # 72

Tax ID # \_\_\_\_\_ Quadrant # \_\_\_\_\_

Number of Bedrooms Proposed: 3 (28x32) Lot Size: 1/3 AC.

Basement with Plumbing: [ ] Garage: [X]

Water Supply: [ ] Well [X] Public [ ] Community

Distance From Well: \_\_\_\_\_ ft.

Following is the minimum specifications for sewage disposal system on above captioned property. Subject to final approval.

Type of system: [X] Conventional [ ] Other \_\_\_\_\_

Size of tank: Septic Tank: 1000 gallons Pump Tank: \_\_\_\_\_ gallons

Subsurface Drainage Field No. of 1 exact length 240 width of 3 depth of 1824 in.
ditches of each ditch ft. ditches ft. ditches in.

French Drain Required: \_\_\_\_\_ Linear feet

Date: 04-14-03

This permit is subject to revocation if site plans or intended use change.

Signed: J. W. ... Environmental Health Specialist

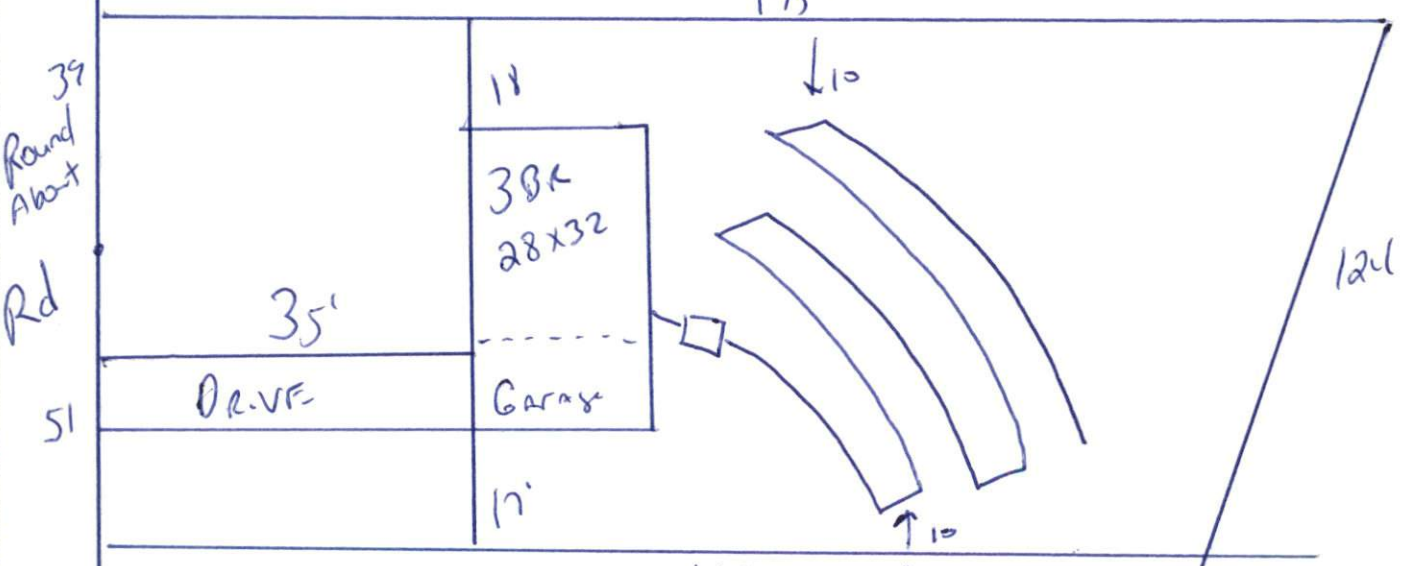

STUB OUT Plumbing As high & as shallow as possible
MAINTAIN ALL SET BACKS
DO NOT DRIVE OR PARK ON SEPTIC SYSTEM

HARNETT COUNTY HEALTH DEPARTMENT  
AUTHORIZATION TO CONSTRUCT

Authorization is hereby given to construct a wastewater system to the specifications described by Harnett County Health Department, Improvement Permit # 20001. This authorization shall be valid for a period not to exceed five (5) years from the date of issuance. This authorization will be invalid if ownership, site plans, or intended use change.

Stafford Custom Homes 910 692-9808  
Name Telephone#

NC 87  
Address

STARWOOD @ Overhill 72 3(28x72) 1/3AC  
Property Location SR# Road Name  
Subdivision Lot # # Bedrooms Proposed Lot Size

TYPE OF SYSTEM

New Installation  Repair  Septic Tank  Nitrification Lines  
 Conventional  Other \_\_\_\_\_

Basement  With Plumbing  Without Plumbing

Water Supply:  Well  Public Water Supply Minimum Well Setback: 50 Ft.

Septic Tank 1000 gal Pump Chamber \_\_\_\_\_ gal

NITRIFICATION FIELD SPECIFICATIONS

Number of fields 1 # of lines per field 1 Length of lines 240 Ft.

Width of ditches 3 ft. Depth of ditches 18-24 inches

French Drain: Linear feet required \_\_\_\_\_ Depth of gravel \_\_\_\_\_

No wastewater system shall be covered or placed into use by any person until an inspection by the Harnett County Health Department has determined that the system has been installed according to the conditions of the Improvement Permit and that a valid Operations Permit has been issued.

Joe W... 04-14-07  
Signature of Authorized Agent for Harnett County of Harnett Date