

# IMPROVEMENT PERMIT

Be it ordained by the Harnett County Board of Health as follows: Section III, Item B. "No Person shall begin construction of any building at which a septic tank system is to be used for disposal of sewage without first obtaining a written permit from the Harnett County Health Department."

Name: (owner) Habitat for Humanity Harnett CO.  New Installation  Septic Tank  
Property Location: SR# 1514 Mamie Upchurch Rd  Repairs  Nitrification Line

Subdivision NA Lot # NA

Tax ID # NA Quadrant # NA

Number of Bedrooms Proposed: 3 Lot Size: .65 acres

Basement with Plumbing:  Garage:

Water Supply:  Well  Public  Community

Distance From Well: 50 ft. +

Following is the minimum specifications for sewage disposal system on above captioned property. Subject to final approval.

Type of system:  Conventional  Other \_\_\_\_\_

Size of tank: Septic Tank: 1000 gallons Pump Tank: \_\_\_\_\_ gallons

Subsurface Drainage Field No. of ditches 4 exact length of each ditch 75 ft. width of ditches 3 ft. depth of ditches 18-24 in.

French Drain Required: \_\_\_\_\_ Linear feet

Date: 04/17/03

This permit is subject to revocation if site plans or intended use change.

Signed: J. H. Byrd R.S.  
Environmental Health Specialist

\* Contractor to meet on site prior to installation

\* Contractor to meet plumber on site to coordinate elevation of plumbing subsoil.

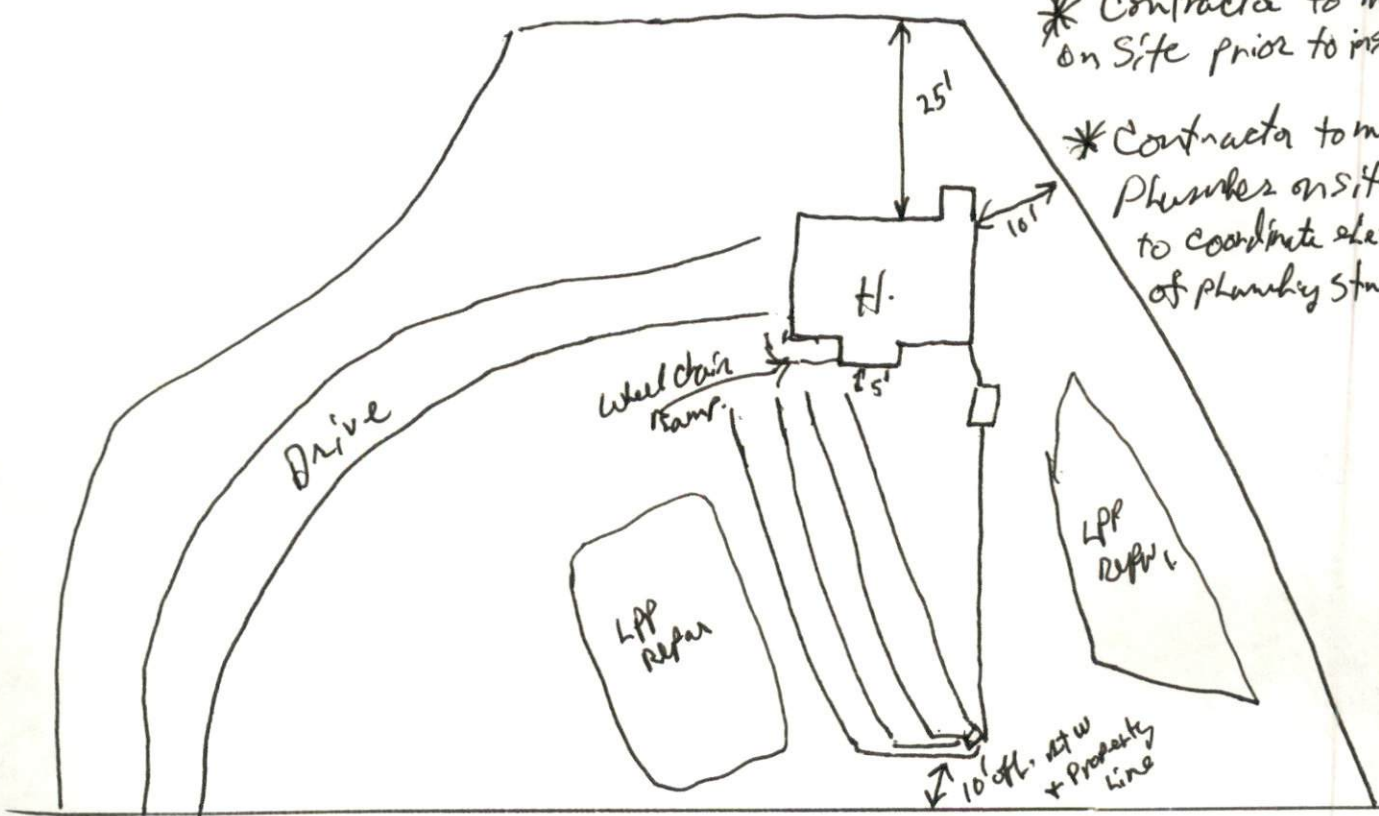

← Mamie Upchurch Rd. To Neils Creek Rd. .2 mi.

HARNETT COUNTY HEALTH DEPARTMENT  
AUTHORIZATION TO CONSTRUCT

Authorization is hereby given to construct a wastewater system to the specifications described by Harnett County Health Department, Improvement Permit # 19610. This authorization shall be valid for a period not to exceed five (5) years from the date of issuance. This authorization will be invalid if ownership, site plans, or intended use change.

Name Habitat For Humanity of Harnett CO. (891-1149)(892-7933) Telephone#

Address P.O. Box 2157 Dunn N.C. 28334

Property Location SR# 1514 Road Name Mamie Upchurch Rd.

Subdivision NA Lot # NA # Bedrooms Proposed 3 Lot Size .65 ac.

TYPE OF SYSTEM

New Installation [ ] Repair  Septic Tank  Nitrification Lines

Conventional [ ] Other \_\_\_\_\_

[ ] Basement [ ] With Plumbing [ ] Without Plumbing

Water Supply: [ ] Well  Public Water Supply Minimum Well Setback: 50 Ft. <sup>\*</sup>

Septic Tank 1000 gal Pump Chamber NA gal

NITRIFICATION FIELD SPECIFICATIONS

Number of fields 1 # of lines per field 4 Length of lines 75 Ft.

Width of ditches 3 ft. Depth of ditches 18-24 inches

French Drain: Linear feet required \_\_\_\_\_ Depth of gravel \_\_\_\_\_

No wastewater system shall be covered or placed into use by any person until an inspection by the Harnett County Health Department has determined that the system has been installed according to the conditions of the Improvement Permit and that a valid Operations Permit has been issued.

[Signature]  
Signature of Authorized Agent for Harnett County of Harnett

04/17/03  
Date