

SITE/SOIL EVALUATION FOR ON-SITE WASTEWATER

APPLICANT NAME _____

DATE _____

FACTORS		PROFILES												
		1	2	3	4	5	6	7	8	9	10			
LANDSCAPE POSITION	.1940													
SLOPE (%)	.1940													
HORIZON 1 DEPTH		0.42												
Texture Group	.1941(A)(1)	SCL												
Consistence	.1941													
Structure	.1941(A)(2)													
Mineralogy	.1941(A)(3)													
HORIZON 2 DEPTH		47.98												
Texture Group	.1941(A)(1)	SCL												
Consistence	.1941	Lo H												
Structure	.1941(A)(2)	Stagn												
Mineralogy	.1941(A)(3)	sand												
HORIZON 3 DEPTH		8cm												
Texture Group	.1941(A)(1)													
Consistence	.1941													
Structure	.1941(A)(2)													
Mineralogy	.1941(A)(3)													
HORIZON 4 DEPTH														
Texture Group	.1941(A)(1)													
Consistence	.1941													
Structure	.1941(A)(2)													
Mineralogy	.1941(A)(3)													
SOIL WETNESS	.1942													
RESTRICTIVE HORIZON	.1944													
SAPROLITE	.1943/.1956													
CLASSIFICATION	.1948													
LONG TERM ACCEPTANCE RATE	.1955	.5												

18240
1824 MAX

HARNETT COUNTY CENTRAL PERMITTING
 APPLICATION # _____
 JOB NAME _____
 DATE PLANS RECEIVED _____
 SITE PLANS APPROVED _____
 APPROVED BY _____

Handwritten notes: $126' 127'$, $100'$, $121' 126'$, $126' 127' = 30'$

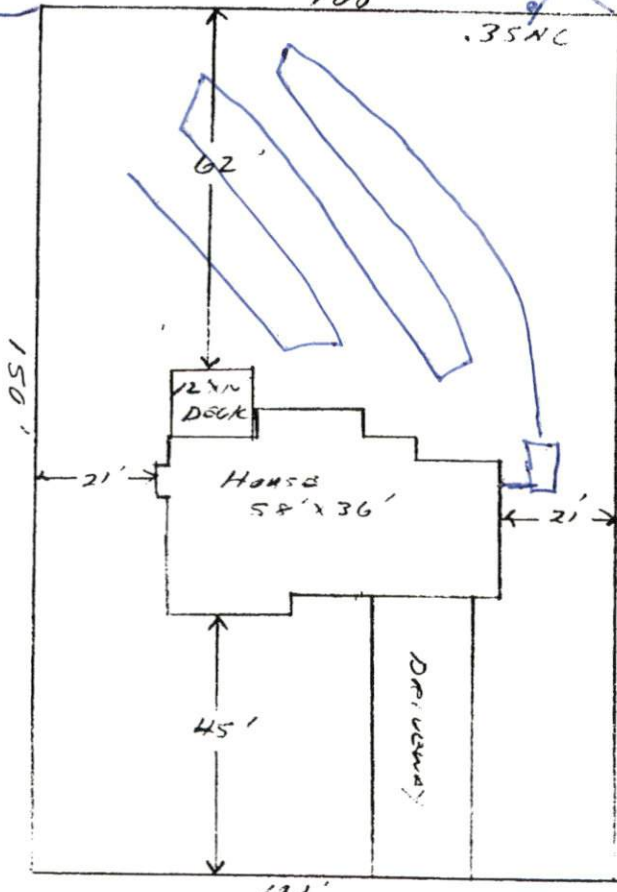

SITE PLAN APPROVAL
 DISTRICT R20R USE SFD
 # BEDROOMS 3
3-28-03
 Zoning Administrator

Handwritten notes: $122' 40'$, $18' 24'$ MAX

Lot # 134 Crestview
 Wm. Kent Pierce Inc.