

Initial Application Date: 3/24/03

Application # 03-5-6171

COUNTY OF HARNETT LAND USE APPLICATION

Central Permitting

102 E. Front Street, Lillington, NC 27546

Phone: (910) 893-4759

Fax: (910) 893-2793

LANDOWNER: Wm. Kent Pizzio Inc Mailing Address: P.O. Box 42535
City: Fayetteville State: NC Zip: 28309 Phone #: 910-424-1294

APPLICANT: Wm. Kent Pizzio Inc Mailing Address: P.O. Box 42535
City: Fayetteville State: NC Zip: 28309 Phone #: 910-424-1294

PROPERTY LOCATION: SR #: 1115 SR Name: Buttala Lake Rd
Parcel: 03958704-0020-98 PIN: 9587-80-4344-000 .35AC
Zoning: R20R Subdivision: Castview Estates Lot #: 133 Lot Size: 100x150
Flood Plain: X Panel: 0075 Watershed: X N/A Deed Book/Page: 01673/0389 Plat Book/Page: 2012/993

DIRECTIONS TO THE PROPERTY FROM LILLINGTON: NC 27 west Buttala Lake Rd
Castview Estates - Mountain View Dr.

PROPOSED USE:

Sg. Family Dwelling (Size 57 x 36) # of Bedrooms 3 # Baths 2 1/2 Basement (w/wo bath) no Garage 24x24 Deck 12x12

Multi-Family Dwelling No. Units _____ No. Bedrooms/Unit _____

Manufactured Home (Size ___ x ___) # of Bedrooms _____ Garage _____ Deck _____

Comments: _____
 Number of persons per household split

Business Sq. Ft. Retail Space _____ Type _____

Industry Sq. Ft. _____ Type _____

Home Occupation (Size ___ x ___) # Rooms _____ Use _____

Accessory Building (Size ___ x ___) Use _____

Addition to Existing Building (Size ___ x ___) Use _____

Other _____

Water Supply: County Well (No. dwellings _____) Other _____

Sewage Supply: New Septic Tank Existing Septic Tank County Sewer Other _____

Erosion & Sedimentation Control Plan Required? YES NO

Structures on this tract of land: Single family dwellings yes Manufactured homes _____ Other (specify) _____

Property owner of this tract of land own land that contains a manufactured home w/in five hundred feet (500') of tract listed above? YES NO

Required Property Line Setbacks:	Minimum	Actual	Minimum	Actual
Front	<u>35</u>	<u>45'</u>	Rear	<u>25</u>
Side	<u>10</u>	<u>20'</u>	Corner	<u>N/A</u>
Nearest Building	<u>20</u>	<u>N/A</u>		

If permits are granted I agree to conform to all ordinances and the laws of the State of North Carolina regulating such work and the specifications or plans submitted. I hereby swear that the foregoing statements are accurate and correct to the best of my knowledge.

Wm. Kent Pizzio
Signature of Applicant

3/24/03
Date

This application expires 6 months from the date issued if no permits have been issued

A RECORDED SURVEY PLAT AND RECORDED DEED ARE REQUIRED WHEN APPLYING FOR A LAND USE PERMIT

2254/15

Lot # 133
 Crestview
 Wm Kent Pierce Inc.

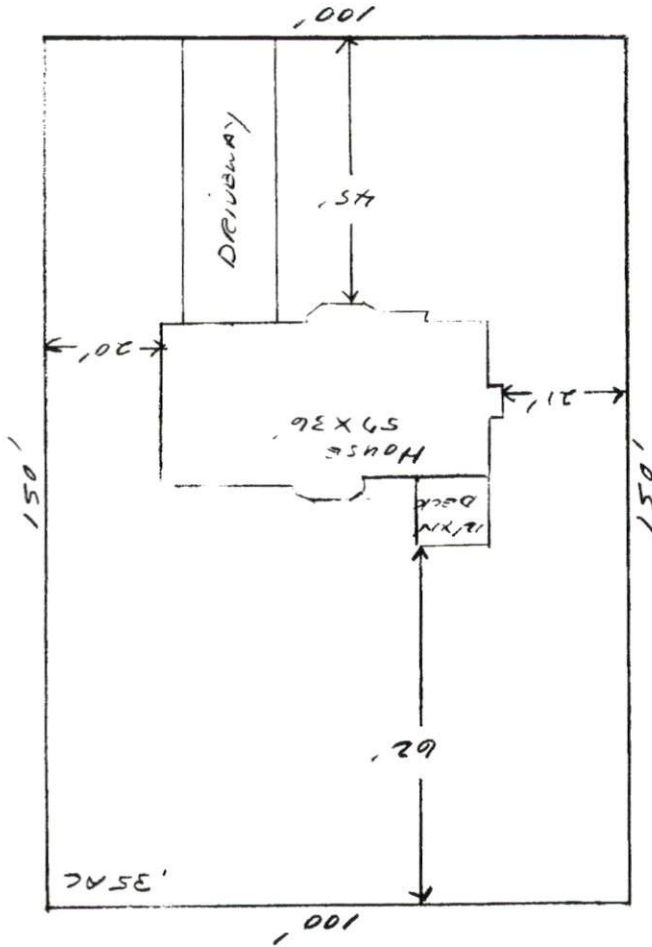

HARRETT COUNTY CENTRAL PERMITTING
 APPLICATION # _____
 JOB NAME _____
 DATE PLANS RECEIVED _____
 SITE PLANS APPROVED _____
 APPROVED BY _____

SITE PLAN APPROVAL USE
 RAYOR SED
 3
 # 8-28-03
 Zoning Administrator

1 = 30'