

#03-5-6722

HARNETT COUNTY HEALTH DEPARTMENT

No. 19964

IMPROVEMENT PERMIT

Be it ordained by the Harnett County Board of Health as follows: Section III, Item B. "No Person shall begin construction of any building at which a septic tank system is to be used for disposal of sewage without first obtaining a written permit from the Harnett County Health Department."

Name: (owner) Gary L. Hughes
Property Location: SR# Lafayette
New Installation [checked]
Septic Tank [checked]
Repairs [unchecked]
Nitrification Line [checked]

Subdivision Victoria Hills Lot # 106

Tax ID # \_\_\_\_\_ Quadrant # \_\_\_\_\_

Number of Bedrooms Proposed: 3 Lot Size: .34

Basement with Plumbing: [unchecked] Garage: [unchecked]

Water Supply: [unchecked] Well [checked] Public [checked] Community [unchecked]

Distance From Well: 50' ft.

Following is the minimum specifications for sewage disposal system on above captioned property. Subject to final approval.

Type of system: [checked] Conventional [unchecked] Other \_\_\_\_\_

Size of tank: Septic Tank: 1000 gallons Pump Tank: \_\_\_\_\_ gallons

Subsurface Drainage Field No. of ditches 4 exact length of each ditch 100 ft. width of ditches 3 ft. depth of ditches 30 in.

French Drain Required: \_\_\_\_\_ Linear feet

Date: 3-28-03

This permit is subject to revocation if site plans or intended use change.

Signed: James E. Mankart Environmental Health Specialist

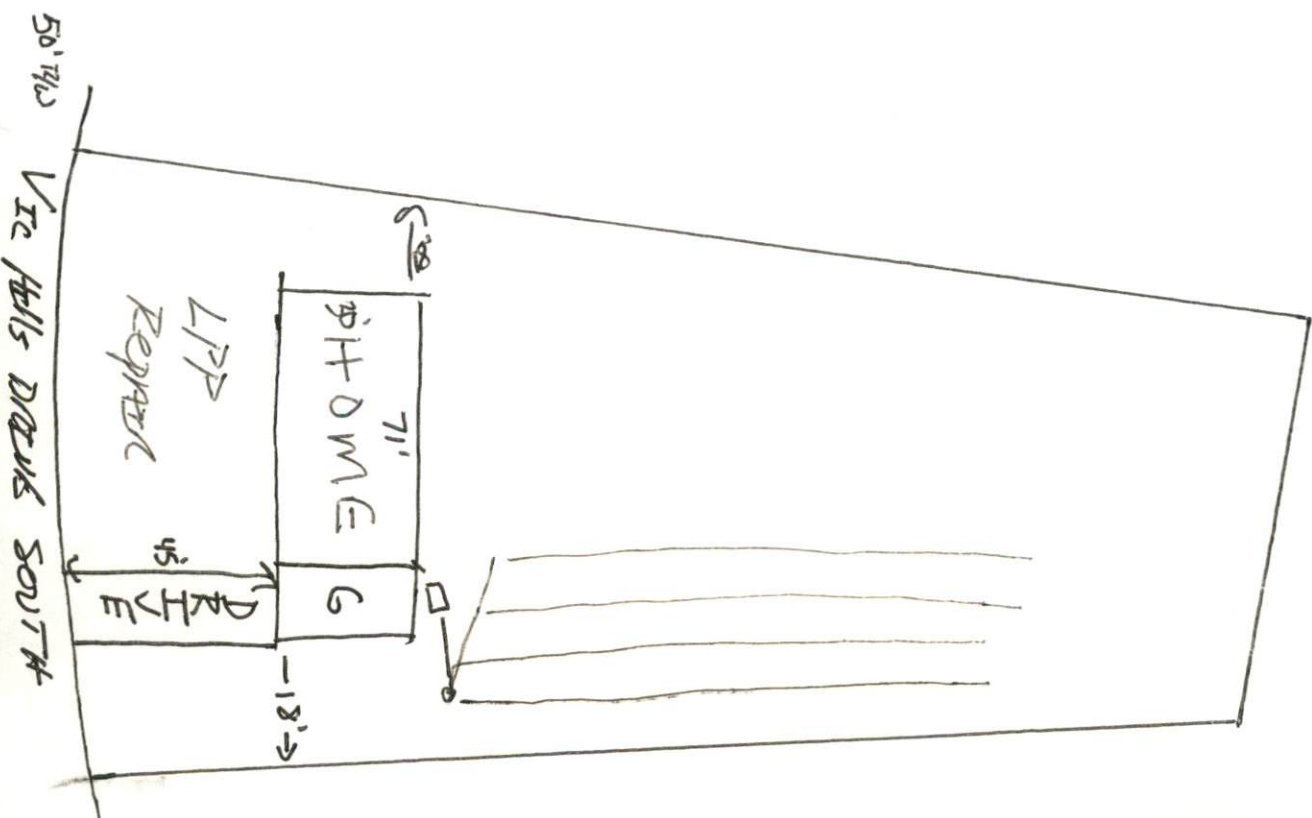

#03-5-6722

HARNETT COUNTY HEALTH DEPARTMENT  
AUTHORIZATION TO CONSTRUCT

Authorization is hereby given to construct a wastewater system to the specifications described by Harnett County Health Department, Improvement Permit # 19964. This authorization shall be valid for a period not to exceed five (5) years from the date of issuance. This authorization will be invalid if ownership, site plans, or intended use change.

Name Gary L Hughes Telephone# 639-6594

Address Angier NC 27501

Property Location SR# \_\_\_\_\_ Road Name Lafayette

Subdivision VEC Hells Lot # 106 # Bedrooms Proposed 3 Lot Size .34

TYPE OF SYSTEM

New Installation  Repair  Septic Tank  Nitrification Lines

Conventional  Other \_\_\_\_\_

Basement  With Plumbing  Without Plumbing

Water Supply:  Well  Public Water Supply Minimum Well Setback: 50 Ft.

Septic Tank 1000 gal Pump Chamber \_\_\_\_\_ gal

NITRIFICATION FIELD SPECIFICATIONS

Number of fields 2 # of lines per field 4 Length of lines 100 Ft.

Width of ditches 3 ft. Depth of ditches 30 inches

French Drain: Linear feet required \_\_\_\_\_ Depth of gravel \_\_\_\_\_

No wastewater system shall be covered or placed into use by any person until an inspection by the Harnett County Health Department has determined that the system has been installed according to the conditions of the Improvement Permit and that a valid Operations Permit has been issued.

James E. Markant  
Signature of Authorized Agent for Harnett County of Harnett

3-28-03  
Date