

#03-5-6627

HARNETT COUNTY HEALTH DEPARTMENT

No. 19982

IMPROVEMENT PERMIT

Be it ordained by the Harnett County Board of Health as follows: Section III, Item B. "No Person shall begin construction of any building at which a septic tank system is to be used for disposal of sewage without first obtaining a written permit from the Harnett County Health Department."

Name: (owner) Joyce B Young

New Installation

Septic Tank

Property Location: SR# 1563

Repairs

Nitrification Line

Subdivision Buckfield

Lot # 5

Tax ID # _____ Quadrant # _____

Number of Bedrooms Proposed: 3

Lot Size: 1.05 acres

Basement with Plumbing:

Garage:

Water Supply: Well Public

Community

Distance From Well: 50' ft.

Following is the minimum specifications for sewage disposal system on above captioned property. Subject to final approval.

Type of system: Conventional

Other _____

Size of tank: Septic Tank: 1000 gallons

Pump Tank: _____ gallons

Subsurface Drainage Field No. of ditches 2 exact length of each ditch 125 ft. width of ditches 3 ft. depth of ditches 18 in.

French Drain Required: - Linear feet

Date: 4-25-03

This permit is subject to revocation if site plans or intended use change.

Signed: James E. Mankin
Environmental Health Specialist

** French DRAIN
MAY BE
Required!*

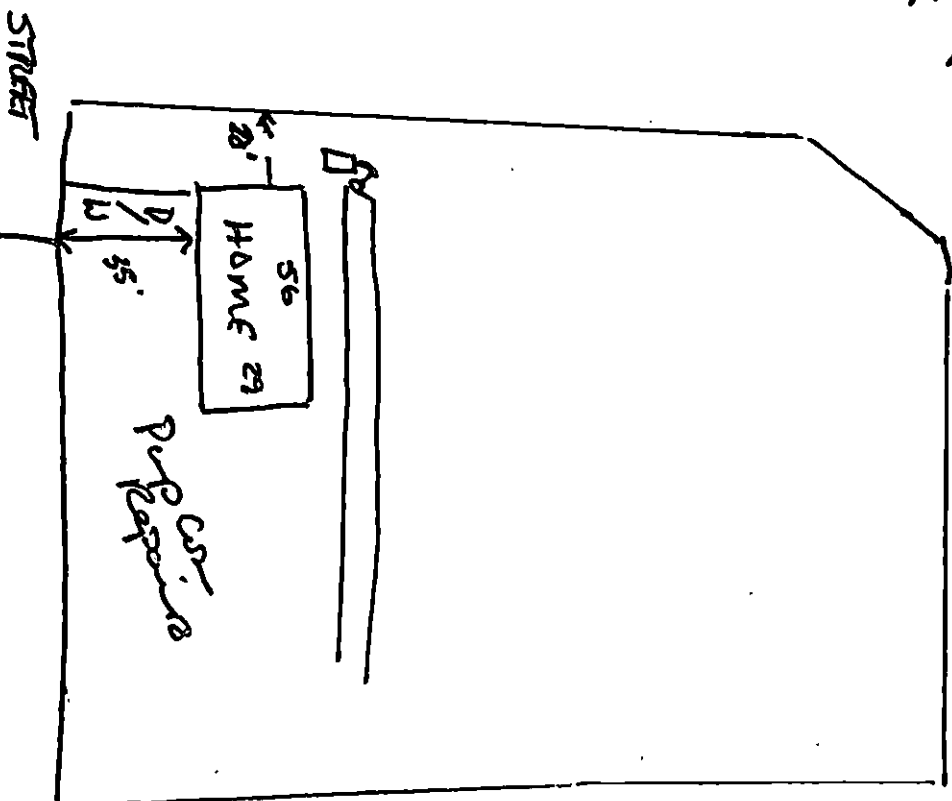

#03-5-6627

HARNETT COUNTY HEALTH DEPARTMENT
AUTORIZATION TO CONSTRUCT

Authorization is hereby given to construct a wastewater system to the specifications described by Harnett County Health Department, Improvement Permit # 19982. This authorization shall be valid for a period not to exceed five (5) years from the date of issuance. This authorization will be invalid if ownership, site plans, or intended use change.

Name Joyce B Young Telephone# 919-639-2934

Address 3435 Johnston County Rd Angier N.C. 27501

Property Location SR# 1563 Road Name Bill Arvey

Subdivision Birchfield Lot # 5 # Bedrooms Proposed 3 Lot Size 1.05

TYPE OF SYSTEM

New Installation Repair Septic Tank Nitrification Lines

Conventional Other _____

Basement With Plumbing Without Plumbing

Water Supply: Well Public Water Supply Minimum Well Setback: _____ Ft.

Septic Tank 1000 gal Pump Chamber _____ gal

NITRIFICATION FIELD SPECIFICATIONS

Number of fields 2 # of lines per field 2 Length of lines 125 Ft.

Width of ditches 3 ft. Depth of ditches 18 inches

French Drain: Linear feet required _____ Depth of gravel _____

No wastewater system shall be covered or placed into use by any person until an inspection by the Harnett County Health Department has determined that the system has been installed according to the conditions of the Improvement Permit and that a valid Operations Permit has been issued.

James E. Marshall
Signature of Authorized Agent for Harnett County of Harnett

4-25-03
Date