

03-5-6599

HARNETT COUNTY HEALTH DEPARTMENT

No 19958

IMPROVEMENT PERMIT

Be it ordained by the Harnett County Board of Health as follows: Section III, Item B. "No Person shall begin construction of any building at which a septic tank system is to be used for disposal of sewage without first obtaining a written permit from the Harnett County Health Department."

Name: (owner) Michael Anderson Homes INC

New Installation Septic Tank

Property Location: SR# 1443 Lafayette Rd

Repairs Nitrification Line

Subdivision Victoria Hills II Ph 4 Lot # 104

Tax ID # _____ Quadrant # _____

Number of Bedrooms Proposed: 3 Lot Size: 100 x 274

Basement with Plumbing: Garage:

Water Supply: Well Public Community

Distance From Well: 50' ft.

Following is the minimum specifications for sewage disposal system on above captioned property. Subject to final approval.

Type of system: Conventional Other Pump to Septic

Size of tank: Septic Tank: 1000 gallons Pump Tank: 1000 gallons

Subsurface Drainage Field No. of ditches 4 exact length of each ditch 80 ft. width of ditches 3 ft. depth of ditches 30 in.

French Drain Required: - Linear feet

Date: 3-25-03

This permit is subject to revocation if site plans or intended use change.

Signed: James E. Markham
Environmental Health Specialist

*Maintain all Setbacks

*Contractor to MEET ON SITE PRIOR TO STUB OUT OR INSTALLATION.

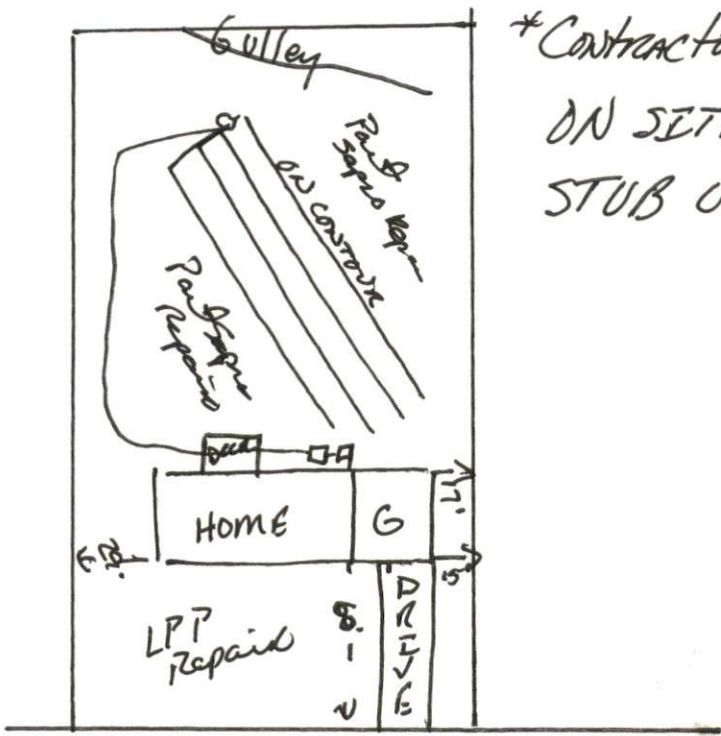

V.H. DRIVE SOUTH

HARNETT COUNTY HEALTH DEPARTMENT
AUTHORIZATION TO CONSTRUCT

Authorization is hereby given to construct a wastewater system to the specifications described by Harnett County Health Department, Improvement Permit # 19958. This authorization shall be valid for a period not to exceed five (5) years from the date of issuance. This authorization will be invalid if ownership, site plans, or intended use change.

Michael Anderson Homes INC 919-552-1790
Name Telephone#

180 Woodland Ridge Drive F.V. N.C. 27526
Address

1443 LAGAY CTR
Property Location SR# Road Name

Victoria Hill 104 3 100x274
Subdivision Lot # # Bedrooms Proposed Lot Size

TYPE OF SYSTEM

New Installation Repair Septic Tank Nitrification Lines

Conventional Other _____

Basement With Plumbing Without Plumbing

Water Supply: Well Public Water Supply Minimum Well Setback: 5'0" Ft.

Septic Tank 1000 gal Pump Chamber 1000 gal

NITRIFICATION FIELD SPECIFICATIONS

Number of fields 2 # of lines per field 4 Length of lines 80 Ft.

Width of ditches 3 ft. Depth of ditches 50 inches

French Drain: Linear feet required - Depth of gravel -

No wastewater system shall be covered or placed into use by any person until an inspection by the Harnett County Health Department has determined that the system has been installed according to the conditions of the Improvement Permit and that a valid Operations Permit has been issued.

James E. Manhart
Signature of Authorized Agent for Harnett County of Harnett

3-25-03
Date