

IMPROVEMENT PERMIT

03-5-6569

Be it ordained by the Harnett County Board of Health as follows: Section III, Item B. "No Person shall begin construction of any building at which a septic tank system is to be used for disposal of sewage without first obtaining a written permit from the Harnett County Health Department."

Name: (owner) Jimmy Pierce Home Co
Property Location: SR# 1115
New Installation
Septic Tank
Repairs
Nitrification Line

Subdivision Peachtree Lot # 40

Tax ID # Quadrant #

Number of Bedrooms Proposed: 3 (50x28) Lot Size: 0.461 Ac

Basement with Plumbing: Garage:
Water Supply: Well Public Community
Distance From Well: 50 ft.

Following is the minimum specifications for sewage disposal system on above captioned property. Subject to final approval.

Type of system: Conventional Other

Size of tank: Septic Tank: 1000 gallons Pump Tank: gallons

Subsurface Drainage Field No. of ditches 1 exact length 240 width of ditches 3 depth of ditches 18 1/4 in.

French Drain Required: Linear feet

Date: 03-17-03
Signed: J. W. ... Environmental Health Specialist

This permit is subject to revocation if site plans or intended use change.

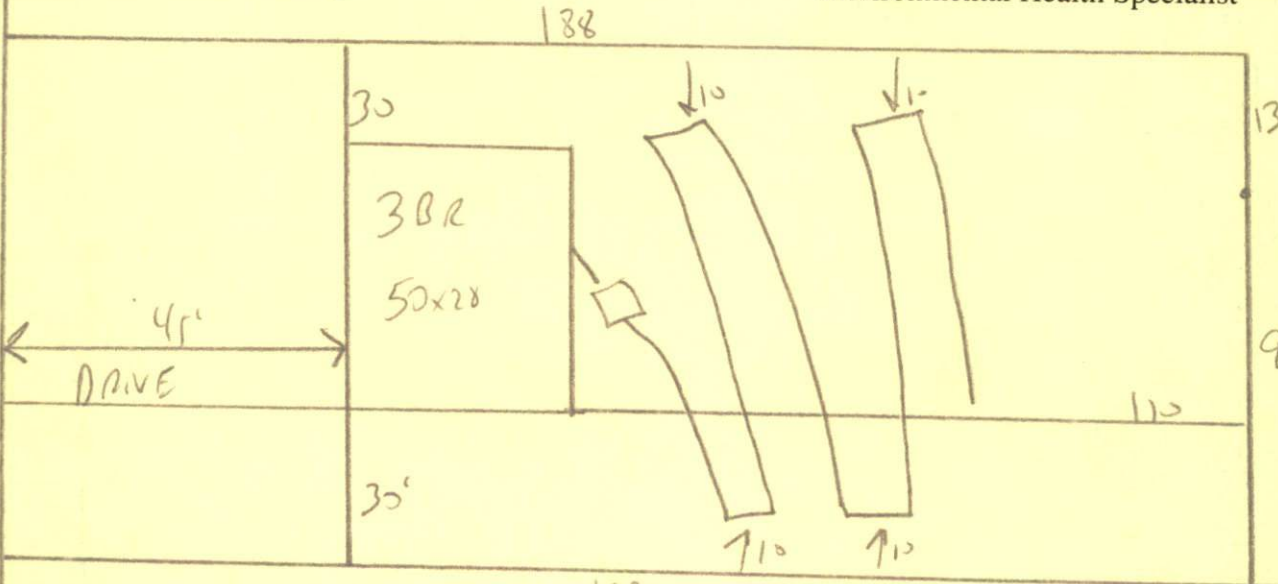

Stub out Plumbing shallow where shown
Maintain all set backs
Do not drive or park on septic system

HARNETT COUNTY HEALTH DEPARTMENT  
AUTHORIZATION TO CONSTRUCT

Authorization is hereby given to construct a wastewater system to the specifications described by Harnett County Health Department, Improvement Permit # 19268. This authorization shall be valid for a period not to exceed five (5) years from the date of issuance. This authorization will be invalid if ownership, site plans, or intended use change.

Jimmy Peace/Horco  
Name

328-5257  
Telephone#

Address

1115

Property Location SR#

Peachtree

Road Name

Subdivision

40  
Lot #

3(50x28)  
# Bedrooms Proposed

46/AC  
Lot Size

**TYPE OF SYSTEM**

New Installation     Repair     Septic Tank     Nitrification Lines

Conventional     Other \_\_\_\_\_

Basement     With Plumbing     Without Plumbing

Water Supply:  Well     Public Water Supply    Minimum Well Setback: \_\_\_\_\_ Ft.

Septic Tank 1000 gal Pump Chamber \_\_\_\_\_ gal

**NITRIFICATION FIELD SPECIFICATIONS**

Number of fields 1 # of lines per field 1 Length of lines 240 Ft.

Width of ditches 3 ft. Depth of ditches 18 inches

French Drain: Linear feet required \_\_\_\_\_ Depth of gravel \_\_\_\_\_

No wastewater system shall be covered or placed into use by any person until an inspection by the Harnett County Health Department has determined that the system has been installed according to the conditions of the Improvement Permit and that a valid Operations Permit has been issued.

[Signature]  
Signature of Authorized Agent for Harnett County of Harnett

03-17-03  
Date