

IMPROVEMENT PERMIT

03-5-6553

Be it ordained by the Harnett County Board of Health as follows: Section III, Item B. "No Person shall begin construction of any building at which a septic tank system is to be used for disposal of sewage without first obtaining a written permit from the Harnett County Health Department."

Name: (owner) Johnnie Canady New Installation Septic Tank
Property Location: SR# 1115 Repairs Nitrification Line

Subdivision LAKE CRESTVIEW Lot # 11

Tax ID # _____ Quadrant # _____

Number of Bedrooms Proposed: 3 (50x30) Lot Size: 100x388x158x477

Basement with Plumbing: Garage: Meet onsite before

Water Supply: Well Public Community INSTALLING septic system

Distance From Well: 50 ft.

Following is the minimum specifications for sewage disposal system on above captioned property. Subject to final approval.

Type of system: Conventional Other _____

Size of tank: Septic Tank: 1000 gallons Pump Tank: _____ gallons

Subsurface Drainage Field No. of ditches 1 exact length 240 width of ditches 3 depth of ditches 18" x 4"

French Drain Required: Appx 500 Linear feet

Date: 3.31-03

This permit is subject to revocation if site plans or intended use change.

Signed: Jr Waters Environmental Health Specialist

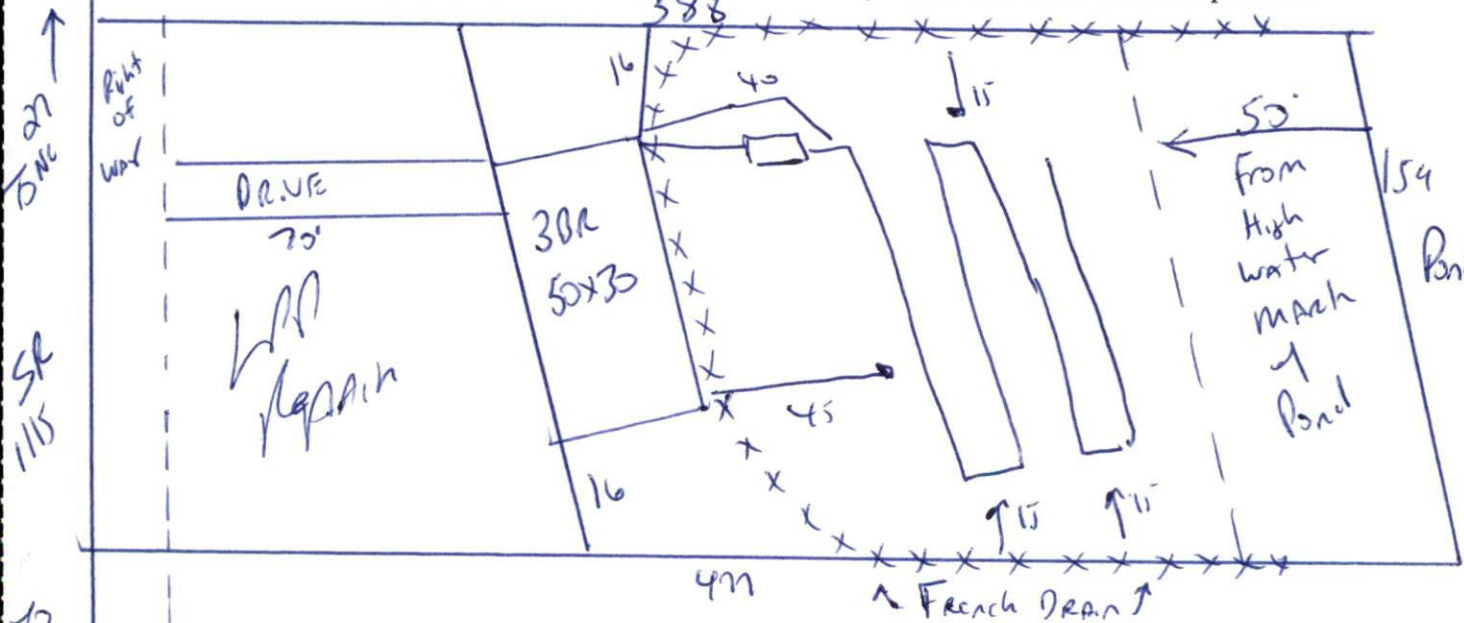

Lines must be at least 40' from rear of house & 50' from high water mark of the pond. Maintain all set backs. Do not drive or park on septic system - keep lines 15' from curbside drain.

HARNETT COUNTY HEALTH DEPARTMENT
AUTHORIZATION TO CONSTRUCT

Authorization is hereby given to construct a wastewater system to the specifications described by Harnett County Health Department, Improvement Permit # 19288. This authorization shall be valid for a period not to exceed five (5) years from the date of issuance. This authorization will be invalid if ownership, site plans, or intended use change.

Johnnie Canady 919-422-8113
Name Telephone#

Address _____

1115
Property Location SR# _____ Road Name _____

Lake Crestview 11 3(50x70) 65Ac
Subdivision Lot # # Bedrooms Proposed Lot Size

TYPE OF SYSTEM

New Installation Repair Septic Tank Nitrification Lines
 Conventional Other _____

Basement With Plumbing Without Plumbing

Water Supply: Well Public Water Supply Minimum Well Setback: 50 Ft.

Septic Tank 1000 gal Pump Chamber _____ gal

NITRIFICATION FIELD SPECIFICATIONS

Number of fields 1 # of lines per field 1 Length of lines 270 Ft.

Width of ditches 3 ft. Depth of ditches 18-24 inches

French Drain: Linear feet required _____ Depth of gravel _____

No wastewater system shall be covered or placed into use by any person until an inspection by the Harnett County Health Department has determined that the system has been installed according to the conditions of the Improvement Permit and that a valid Operations Permit has been issued.

[Signature] 03-31-03
Signature of Authorized Agent for Harnett County of Harnett Date