

IMPROVEMENT PERMIT

03-5-6344

Be it ordained by the Harnett County Board of Health as follows: Section III, Item B. "No Person shall begin construction of any building at which a septic tank system is to be used for disposal of sewage without first obtaining a written permit from the Harnett County Health Department."

Name: (owner) Kent Pierce

New Installation  Septic Tank

Property Location: SR# 1115

Repairs  Nitrification Line

Subdivision Peach Tree Lot # 168

Tax ID # \_\_\_\_\_ Quadrant # \_\_\_\_\_

Number of Bedrooms Proposed: 3 (28 x 50) Lot Size: .47 Ac

Basement with Plumbing:  Garage:

Water Supply:  Well  Public  Community

Distance From Well: 50 ft.

3 Bedrooms

Following is the minimum specifications for sewage disposal system on above captioned property. Subject to final approval.

Type of system:  Conventional  Other Pump to Conventional

Size of tank: Septic Tank: 1000 gallons Pump Tank: 1000 gallons

Subsurface Drainage Field No. of exact length width of depth of  
Ditches 1 of each ditch 240 ft. ditches 3 ft. ditches 18 1/2 in.

French Drain Required: \_\_\_\_\_ Linear feet

Date: 02-03-03

This permit is subject to revocation if site plans or intended use change.

Signed: [Signature]  
Environmental Health Specialist

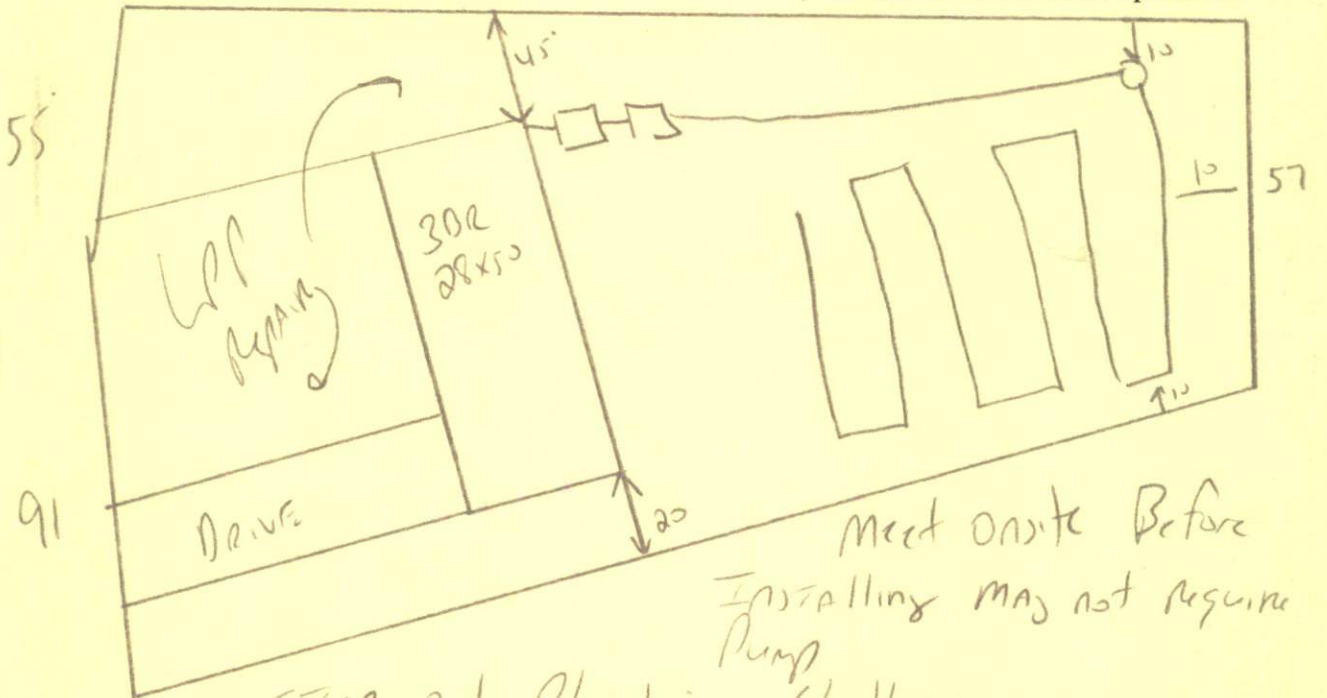

STUB out Plumbing shallow

Maintain All set Backs

Do not DRIVE or Park on septic system

HARNETT COUNTY HEALTH DEPARTMENT  
AUTHORIZATION TO CONSTRUCT

Authorization is hereby given to construct a wastewater system to the specifications described by Harnett County Health Department, Improvement Permit # 19239. This authorization shall be valid for a period not to exceed five (5) years from the date of issuance. This authorization will be invalid if ownership, site plans, or intended use change.

Name Kent Price Telephone# 424 1294

Address \_\_\_\_\_

Property Location SR# 1115 Road Name \_\_\_\_\_

Subdivision Peach Tree Lot # 168 # Bedrooms Proposed 3(28x10) Lot Size 47ac

**TYPE OF SYSTEM**

New Installation  Repair  Septic Tank  Nitrification Lines

Conventional  Other Plugs to Concrete

Basement  With Plumbing  Without Plumbing

Water Supply:  Well  Public Water Supply Minimum Well Setback: 50 Ft.

Septic Tank 1000 Pump Chamber 1000

**NITIRFICATION FIELD SPECIFICATIONS**

Number of fields 1 # of lines per field 1 Length of lines 240 Ft.

Width of ditches 3 ft. Depth of ditches 18-24 inches

French Drain: Linear feet required \_\_\_\_\_ Depth of gravel \_\_\_\_\_

No wastewater system shall be covered or placed into use by any person until an inspection by the Harnett County Health Department has determined that the system has been installed according to the conditions of the Improvement Permit and that a valid Operations Permit has been issued.

Signature of Authorized Agent for Harnett County of Harnett [Signature] Date 02-02-03