

# IMPROVEMENT PERMIT

035-6278

Be it ordained by the Harnett County Board of Health as follows: Section III, Item B. "No Person shall begin construction of any building at which a septic tank system is to be used for disposal of sewage without first obtaining a written permit from the Harnett County Health Department."

Name: (owner) Danny Morris New Century Home  New Installation  Septic Tank  
 Property Location: SR# 1115  Repairs  Nitrification Line

Subdivision PeachTree Crossing Lot # 127

Tax ID # \_\_\_\_\_ Quadrant # \_\_\_\_\_

Number of Bedrooms Proposed: 3(48x41) Lot Size: 0.462 AC

Basement with Plumbing:  Garage:  Please note change in house location

Water Supply:  Well  Public  Community Home was moved so that Pump system would not be needed.

Distance From Well: \_\_\_\_\_ ft.

Following is the minimum specifications for sewage disposal system on above captioned property. Subject to final approval.

Type of system:  Conventional  Other \_\_\_\_\_

Size of tank: Septic Tank: 1000 gallons Pump Tank: \_\_\_\_\_ gallons

Subsurface Drainage Field No. of ditches 2 exact length of each ditch 120 ft. width of ditches 3 ft. depth of ditches 18 1/4 in.

French Drain Required: \_\_\_\_\_ Linear feet

Date: 01-22-03

This permit is subject to revocation if site plans or intended use change.

Signed: Jerry WARS  
 Environmental Health Specialist

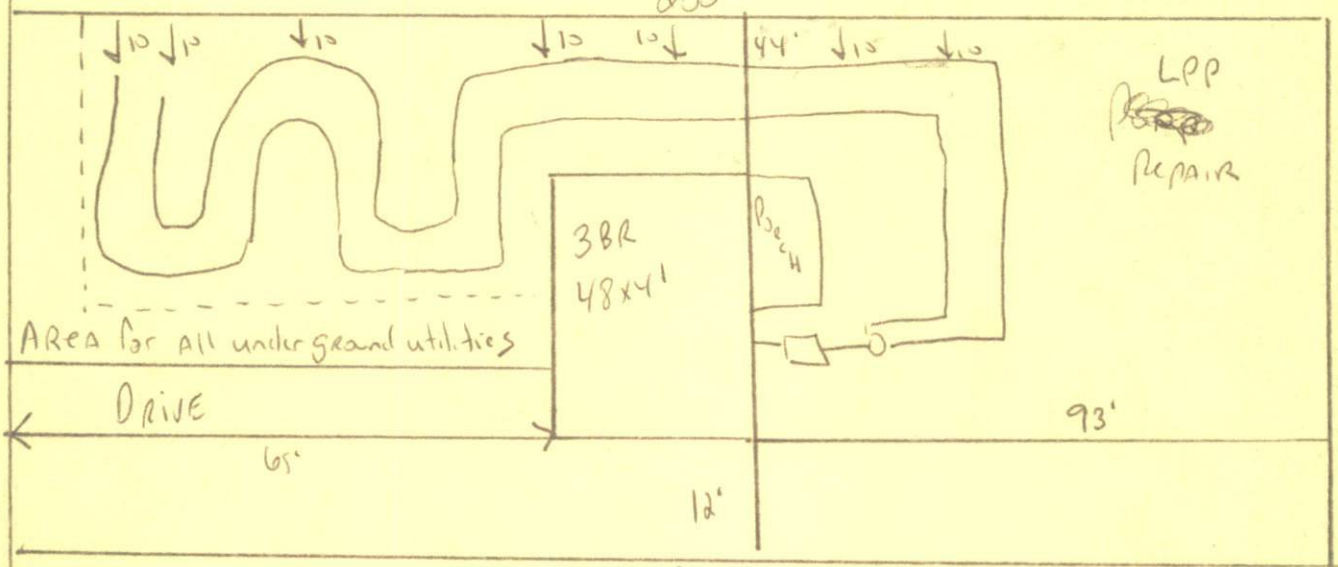

Please note change in house location. House was moved so that Pump system would not be needed. If house is not as shown on this permit Pump will be required. All underground utilities must not cross Area of septic system. Do not drive or park on septic system. Must meet on site. Maintain all setbacks.

HARNETT COUNTY HEALTH DEPARTMENT  
AUTHORIZATION TO CONSTRUCT

Authorization is hereby given to construct a wastewater system to the specifications described by Harnett County Health Department, Improvement Permit # 17227. This authorization shall be valid for a period not to exceed five (5) years from the date of issuance. This authorization will be invalid if ownership, site plans, or intended use change.

Danny Nokes New Century Home 892-4345  
Name Telephone #

Address

1115  
Property Location SR# Road Name

Peach Tree 127 3 (48x41)  
Subdivision Lot # # Bedrooms Proposed Lot size

TYPE OF SYSTEM

New Installation  Repair  Septic Tank  Nitrification Lines  
 Conventional Other \_\_\_\_\_  Basement  With Plumbing  Without Plumbing

Water Supply:  Well  Public - Minimum Well Setback: \_\_\_\_\_ Ft.  
Septic Tank 1050 Pump Chamber \_\_\_\_\_

NITRIFICATION FIELD SPECIFICATIONS

Number of fields 1 # of lines per field 2 Length of lines 120 Ft.

Width of ditches 3 ft. Depth of ditches 18-24 inches

French Drain: Linear feet required \_\_\_\_\_ Depth of gravel \_\_\_\_\_

No wastewater system shall be covered or placed into use by any person until an inspection by the Harnett County Health Department has determined that the system has been installed according to the conditions of the Improvement Permit and that a valid Operations Permit has been issued.

[Signature] 01-22-03  
Signature of Authorized Agent for Harnett County Date