

03-5-6118

IMPROVEMENT PERMIT

Be it ordained by the Harnett County Board of Health as follows: Section III, Item B. "No Person shall begin construction of any building at which a septic tank system is to be used for disposal of sewage without first obtaining a written permit from the Harnett County Health Department."

Name: (owner) QUEST DEV. CO. INC. New Installation Septic Tank
Property Location: SR# 1437 BALLARD RD Repairs Nitrification Line

Subdivision BALLARD WOODS Lot # 50

Tax ID # _____ Quadrant # _____

Number of Bedrooms Proposed: 3 Lot Size: _____

Basement with Plumbing: Garage:

Water Supply: Well Public Community

Distance From Well: 100 ft.

Following is the minimum specifications for sewage disposal system on above captioned property. Subject to final approval.

Type of system: Conventional Other _____

Size of tank: Septic Tank: 1000 gallons Pump Tank: _____ gallons

Subsurface Drainage Field No. of ditches 4 exact length of each ditch 75 ft. width of ditches 3 ft. depth of ditches 30-34 in.

French Drain Required: _____ Linear feet

Date: 1/15/03

Signed: [Signature] RS (OLIVER TOLKOFF)
Environmental Health Specialist

This permit is subject to revocation if site plans or intended use change.

* MAINTAIN ALL SETBACKS

* START LINES 30" DEEP AND
END 24" DEEP

* CALL WITH ANY QUESTIONS PRIOR
TO INSTALLATION

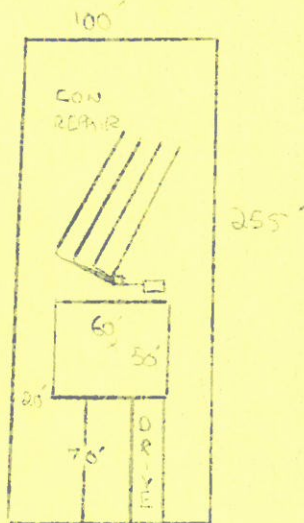

HARNETT COUNTY HEALTH DEPARTMENT
AUTHORIZATION TO CONSTRUCT

Authorization is hereby given to construct a wastewater system to the specifications described by Harnett County Health Department, Improvement Permit # 19814. This authorization shall be valid for a period not to exceed five (5) years from the date of issuance. This authorization will be invalid if ownership, site plans, or intended use change.

QUEST DEV. CO. INC. 890-2119
Name Telephone#

PO Box 2121 DUNN NC 28335
Address

1437 BALLARD RD.
Property Location SR# Road Name

BALLARD WOODS 50 3
Subdivision Lot # # Bedrooms Proposed Lot Size

TYPE OF SYSTEM

New Installation Repair Septic Tank Nitrification Lines

Conventional Other _____

Basement With Plumbing Without Plumbing

Water Supply: Well Public Water Supply Minimum Well Setback: 100 Ft.

Septic Tank 1000 gal Pump Chamber _____

NITRIFICATION FIELD SPECIFICATIONS

Number of fields 1 # of lines per field 4 Length of lines 75 Ft.

Width of ditches 3 ft. Depth of ditches 30-24 inches

French Drain: Linear feet required _____ Depth of gravel _____

No wastewater system shall be covered or placed into use by any person until an inspection by the Harnett County Health Department has determined that the system has been installed according to the conditions of the Improvement Permit and that a valid Operations Permit has been issued.

[Signature] RS 1/15/03
Signature of Authorized Agent for Harnett County of Harnett Date