

HARNETT COUNTY HEALTH DEPARTMENT

No 19877

IMPROVEMENT PERMIT

Be it ordained by the Harnett County Board of Health as follows: Section III, Item B. "No Person shall begin construction of any building at which a septic tank system is to be used for disposal of sewage without first obtaining a written permit from the Harnett County Health Department."

Name: (owner) Keith Bullock Builders Inc [X] New Installation [X] Septic Tank
Property Location: SR# 1535 Mitchell [ ] Repairs [X] Nitrification Line

Subdivision H & R Acres Lot # 2

Tax ID # \_\_\_\_\_ Quadrant # \_\_\_\_\_

Number of Bedrooms Proposed: 3 Lot Size: 1 Acre

Basement with Plumbing: [ ] Garage: [ ]

Water Supply: [ ] Well [X] Public [ ] Community

Distance From Well: 50' ft.

Following is the minimum specifications for sewage disposal system on above captioned property. Subject to final approval.

Type of system: [X] Conventional [ ] Other \_\_\_\_\_

Size of tank: Septic Tank: 1000 gallons Pump Tank: \_\_\_\_\_ gallons

Subsurface Drainage Field No. of 6 exact length 50 width of 3 depth of 8-20 in.
Ditches 5 of each ditch 60 ft. ditches 3 ft. ditches

French Drain Required: - Linear feet

Date: 1-9-03

This permit is subject to revocation if site plans or intended use change.

Signed: James E. Monahan, Environmental Health Specialist

\* WATER LINE TO BE 16' off any part of septic system.

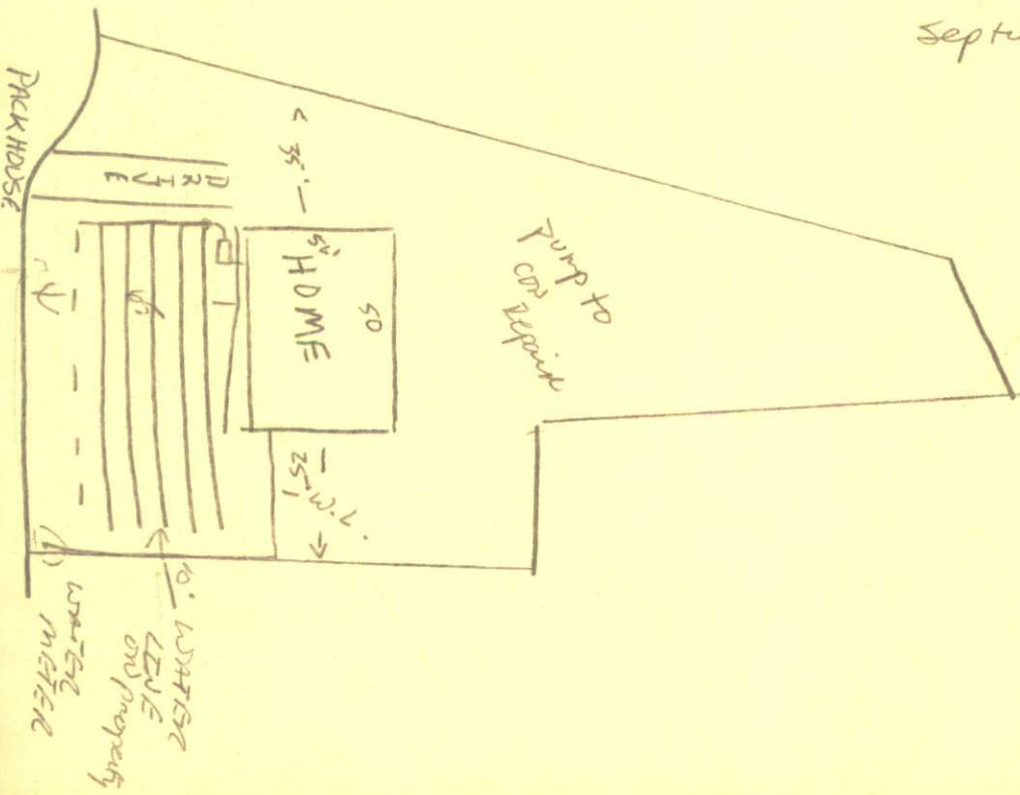

HARNETT COUNTY HEALTH DEPARTMENT  
AUTHORIZATION TO CONSTRUCT

Authorization is hereby given to construct a wastewater system to the specifications described by Harnett County Health Department, Improvement Permit # 19877. This authorization shall be valid for a period not to exceed five (5) years from the date of issuance. This authorization will be invalid if ownership, site plans, or intended use change.

Keith Bullock Builders 639-7424  
Name Telephone#

72 Overlook CT ANGIER N.C. 27507  
Address

1535 Mitchell  
Property Location SR# Road Name

HTR Acres 2 3 1 ac  
Subdivision Lot # # Bedrooms Proposed Lot Size

**TYPE OF SYSTEM**

New Installation  Repair  Septic Tank  Nitrification Lines

Conventional  Other \_\_\_\_\_

Basement  With Plumbing  Without Plumbing

Water Supply:  Well  Public Water Supply Minimum Well Setback: \_\_\_\_\_ Ft.

Septic Tank 1000 Pump Chamber \_\_\_\_\_

**NITRIFICATION FIELD SPECIFICATIONS**

Number of fields 2 # of lines per field 5 Length of lines 50 60 Ft.

Width of ditches 3 ft. Depth of ditches 18-22 inches

French Drain: Linear feet required - Depth of gravel -

No wastewater system shall be covered or placed into use by any person until an inspection by the Harnett County Health Department has determined that the system has been installed according to the conditions of the Improvement Permit and that a valid Operations Permit has been issued.

James E. Marshall  
Signature of Authorized Agent for Harnett County of Harnett

1-9-03  
Date