

Initial Application Date: 12-9-02

Application # 23-500060602

COUNTY OF HARNETT LAND USE APPLICATION

Central Permitting

102 E. Front Street, Lillington, NC 27546

Phone: (910) 893-4759

Fax: (910) 893-2793

LANDOWNER: ANDERSON ENTERPRISES Mailing Address: 2024 BAPTIST GROVE RD  
City: FUQUAY-VARINA State: N.C. Zip: 27526 Phone #: 552-3383 (919)

APPLICANT: LANCET HOMES, INC. Mailing Address: P.O. Box 1329  
City: FUQUAY-VARINA State: N.C. Zip: 27526 Phone #: 557-3686 (919)

PROPERTY LOCATION: SR #: 1443 SR Name: LA FAYETTE RD  
Parcel: 08-0653-0105-55 PIN: 0663-04-4726-006 0663-04-4726  
Zoning: R-30 Subdivision: VICTORIA HILLS II Lot #: 207 Lot Size: 1.00AC.  
Flood Plain: X Panel: 50 Watershed: NA Deed Book/Page: 1386/247 Plat Book/Page: OTP

DIRECTIONS TO THE PROPERTY FROM LILLINGTON: TAKE 401 N. TOWARDS FUQUAY-VARINA - TAKE A RIGHT ON LA FAYETTE RD. GO ABOUT 2 MILES - SUB LOCATED ON RIGHT - GO IN TAKE 1<sup>ST</sup> RIGHT + 1<sup>ST</sup> LEFT - LOT LOCATED ON LEFT SIDE OF STREET

PROPOSED USE:

- Sg. Family Dwelling (Size 38<sup>8</sup> x 52) # of Bedrooms 3 # Baths 2 Basement (w/wo bath) N/A Garage 13'9" x 21<sup>5</sup> Deck 10 x 12
- Multi-Family Dwelling No. Units \_\_\_\_\_ No. Bedrooms/Unit \_\_\_\_\_
- Manufactured Home (Size \_\_\_\_\_ x \_\_\_\_\_) # of Bedrooms \_\_\_\_\_ Garage \_\_\_\_\_ Deck \_\_\_\_\_

Comments: \_\_\_\_\_

- Number of persons per household 2
- Business Sq. Ft. Retail Space \_\_\_\_\_ Type \_\_\_\_\_
- Industry Sq. Ft. \_\_\_\_\_ Type \_\_\_\_\_
- Home Occupation (Size \_\_\_\_\_ x \_\_\_\_\_) # Rooms \_\_\_\_\_ Use \_\_\_\_\_
- Accessory Building (Size \_\_\_\_\_ x \_\_\_\_\_) Use \_\_\_\_\_
- Addition to Existing Building (Size \_\_\_\_\_ x \_\_\_\_\_) Use \_\_\_\_\_
- Other \_\_\_\_\_

offer to purchase on file  
CJU

Water Supply:  County  Well (No. dwellings \_\_\_\_\_)  Other \_\_\_\_\_  
Sewage Supply:  New Septic Tank  Existing Septic Tank  County Sewer  Other \_\_\_\_\_

Erosion & Sedimentation Control Plan Required? YES  NO

Structures on this tract of land: Single family dwellings 1 SFD proposed Manufactured homes \_\_\_\_\_ Other (specify) \_\_\_\_\_

Property owner of this tract of land own land that contains a manufactured home w/in five hundred feet (500') of tract listed above? YES  NO

Required Property Line Setbacks:	Minimum	Actual	Minimum	Actual
Front	<u>35'</u>	<u>50</u>	Rear	<u>25'</u>
Side	<u>10'</u>	<u>25</u>	Corner	<u>180</u>
Nearest Building	<u>—</u>	<u>—</u>		<u>—</u>

If permits are granted I agree to conform to all ordinances and the laws of the State of North Carolina regulating such work and the specifications or plans submitted. I hereby swear that the foregoing statements are accurate and correct to the best of my knowledge.

[Signature]  
Signature of Applicant

12-9-02  
Date

\*\*This application expires 6 months from the date issued if no permits have been issued\*\*

928 12/9 N

# Lam<sup>bert</sup> Homes, Inc.

Lot # 207 Subdivision: Victoria Hills II  
Address: 135 MOONEY DR. FARMWAY - VARINA, N.C. 27526  
Recorded - Book: 1386 Page: 247 Tax Map: 0663-04-4726.000  
Zoning: R-30 Lot Size: 30,138 sq.ft. Scale: 1" = 100'

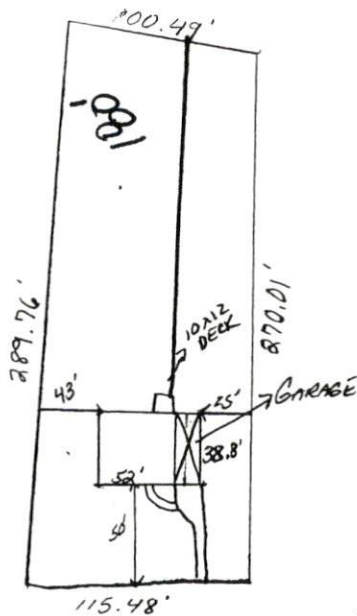

## SITE PLAN APPROVAL

DISTRICT RIA30 USE SFD

#BEDROOMS 3

12-9-02 C. J. Williams

Date Zoning Administrator

# Harnett County - Property Description Inquiry

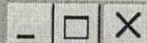

Functions Help



12/09/2002 1:03:27 PM

Location ID	69001
PARCEL NUMBER	08-0653- -0105-55-
PIN	0663-04-4726.000
Location address	135 MOONEY DR 08
Primary related party	ANDERSON ENTERPRISES INC

Property description

LOT#207 VICTORIA HILLS PH 2
MAP#2000/567 1 LOT

OK Exit Cancel Rel party data