

# IMPROVEMENT PERMIT

03-5-6045

Be it ordained by the Harnett County Board of Health as follows: Section III, Item B. "No Person shall begin construction of any building at which a septic tank system is to be used for disposal of sewage without first obtaining a written permit from the Harnett County Health Department."

Name: (owner) Kent Proce Inc  New Installation  Septic Tank  
Property Location: SR# 115  Repairs  Nitrification Line

Subdivision CRESTVIEW Est. Lot # 113

Tax ID # \_\_\_\_\_ Quadrant # \_\_\_\_\_

Number of Bedrooms Proposed: 3 (50x48) Lot Size: .48 AC

Basement with Plumbing:  Garage:   
Water Supply:  Well  Public  Community  
Distance From Well: 50 ft.

Following is the minimum specifications for sewage disposal system on above captioned property. Subject to final approval.

Type of system:  Conventional  Other Pump to Conventional  
Size of tank: Septic Tank: 1000 gallons Pump Tank: 1000 gallons  
Subsurface Drainage Field No. of ditches 3 exact length 80 ft. width of 3 ft. depth of 18-24 in.  
French Drain Required: \_\_\_\_\_ Linear feet

Date: 12-19-02  
Signed: Jon W. DREI  
Environmental Health Specialist

This permit is subject to revocation if site plans or intended use change.

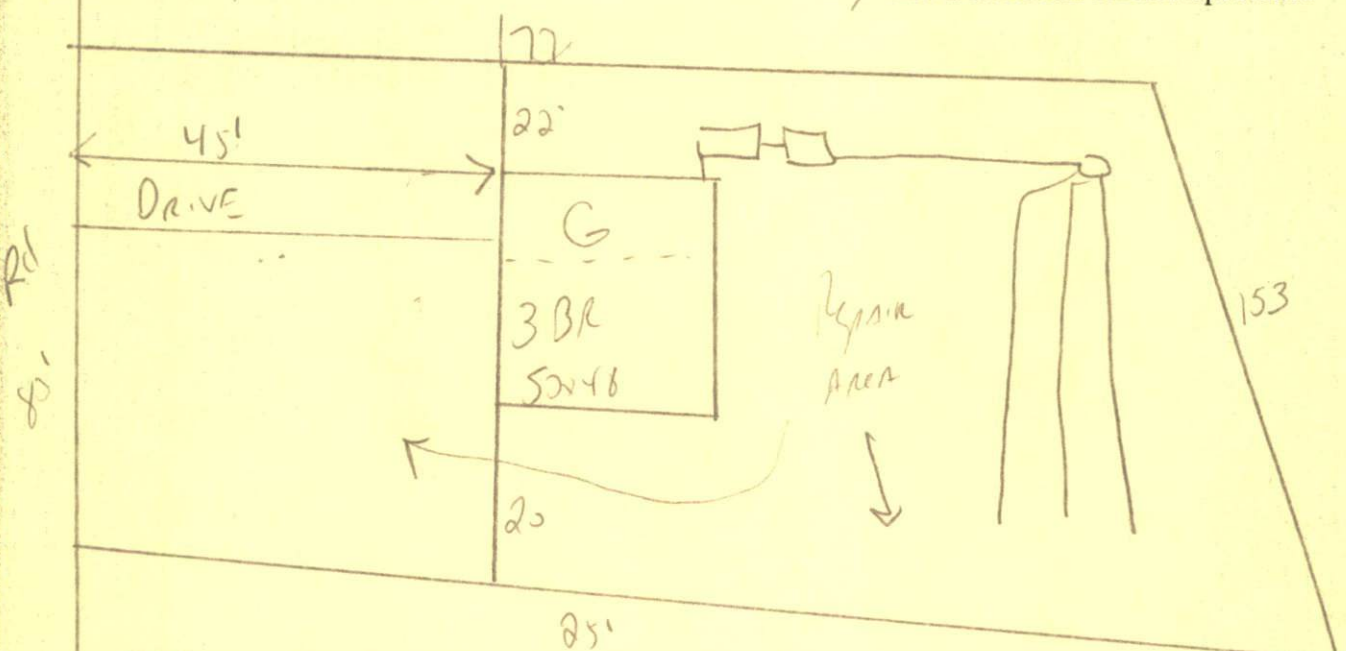

STUB out shallow where shown  
Meet onsite MAINTAIN all set Backs  
Do not Drive or park on septic system

HARNETT COUNTY HEALTH DEPARTMENT  
AUTHORIZATION TO CONSTRUCT

Authorization is hereby given to construct a wastewater system to the specifications described by Harnett County Health Department, Improvement Permit # 19933. This authorization shall be valid for a period not to exceed five (5) years from the date of issuance. This authorization will be invalid if ownership, site plans, or intended use change.

Kent Pierce 424-1294  
Name Telephone #

Address

1115  
Property Location SR# Road Name

Crestview 713 3(50x48) 4848  
Subdivision Lot # # Bedrooms Proposed Lot size

TYPE OF SYSTEM

New Installation [ ] Repair [ ] Septic Tank [ ] Nitrification Lines  
[ ] Conventional Other Pump [ ] Basement [ ] With Plumbing [ ] Without Plumbing

Water Supply: [ ] Well [ ] Public - Minimum Well Setback: 50 Ft.  
Septic Tank 4000 Pump Chamber 1000

NITRIFICATION FIELD SPECIFICATIONS

Number of fields 1 # of lines per field 3 Length of lines 80 Ft.

Width of ditches 3 ft. Depth of ditches 12.24 inches

French Drain: Linear feet required \_\_\_\_\_ Depth of gravel \_\_\_\_\_

No wastewater system shall be covered or placed into use by any person until an inspection by the Harnett County Health Department has determined that the system has been installed according to the conditions of the Improvement Permit and that a valid Operations Permit has been issued.

[Signature] 12-19-02  
Signature of Authorized Agent for Harnett County Date