

HARNETT COUNTY HEALTH DEPARTMENT

No 19868

IMPROVEMENT PERMIT

Be it ordained by the Harnett County Board of Health as follows: Section III, Item B. "No Person shall begin construction of any building at which a septic tank system is to be used for disposal of sewage without first obtaining a written permit from the Harnett County Health Department."

Name: (owner) Whittenton Builders

New Installation  Septic Tank

Property Location: SR# Hwy 421

Repairs  Nitrification Line

Subdivision Myrtlewood Lot # 18

Tax ID # \_\_\_\_\_ Quadrant # \_\_\_\_\_

Number of Bedrooms Proposed: 3 Lot Size: 1 Acre

Basement with Plumbing:  Garage:

Water Supply:  Well  Public  Community

Distance From Well: 50' ft.

Following is the minimum specifications for sewage disposal system on above captioned property. Subject to final approval.

Type of system:  Conventional  Other \_\_\_\_\_

Size of tank: Septic Tank: 1000 gallons Pump Tank: \_\_\_\_\_ gallons

Subsurface Drainage Field No. of ditches 2 exact length of each ditch 170 ft. width of ditches 3 ft. depth of ditches 18-20 in.

French Drain Required: - Linear feet

Date: 12-17-02

This permit is subject to revocation if site plans or intended use change.

Signed: James E. Manhart  
Environmental Health Specialist

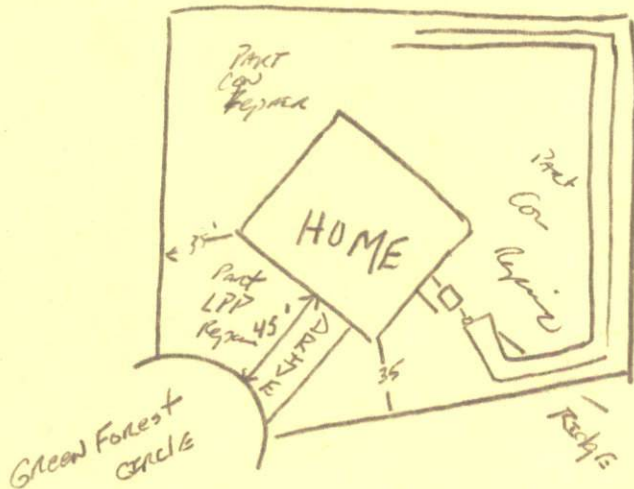

#03-5-6035

HARNETT COUNTY HEALTH DEPARTMENT  
AUTORIZATION TO CONSTRUCT

Authorization is hereby given to construct a wastewater system to the specifications described by Harnett County Health Department, Improvement Permit # 19868. This authorization shall be valid for a period not to exceed five (5) years from the date of issuance. This authorization will be invalid if ownership, site plans, or intended use change.

Whittemton Builders 919-894-5591  
Name Telephone #

1055 Tilghman Rd DUNN N.C. 28339  
Address

421 Hwy 421  
Property Location SR# Road Name

Myrtlewood 18 3 1 acre  
Subdivision Lot # # Bedrooms Proposed Lot size

TYPE OF SYSTEM

New Installation  Repair  Septic Tank  Nitrification Lines

Conventional Other \_\_\_\_\_  Basement  With Plumbing  Without Plumbing

Water Supply:  Well  Public - Minimum Well Setback: 50' Ft.  
Septic Tank 1000 Pump Chamber \_\_\_\_\_

NITRIFICATION FIELD SPECIFICATIONS

Number of fields 2 # of lines per field 2 Length of lines 170 Ft.

Width of ditches 3 ft. Depth of ditches 18-20 inches

French Drain: Linear feet required \_\_\_\_\_ Depth of gravel \_\_\_\_\_

No wastewater system shall be covered or placed into use by any person until an inspection by the Harnett County Health Department has determined that the system has been installed according to the conditions of the Improvement Permit and that a valid Operations Permit has been issued.

James E. Marshall 12-17-02  
Signature of Authorized Agent for Harnett County Date