

HTE 03-5-5843

IMPROVEMENT PERMIT

Be it ordained by the Harnett County Board of Health as follows: Section III, Item B. "No Person shall begin construction of any building at which a septic tank system is to be used for disposal of sewage without first obtaining a written permit from the Harnett County Health Department."

Name: (owner) COMFORT HOMES INC New Installation Septic Tank
 Property Location: SR# 1412 CHRISTIAN LIGHT RD Repairs Nitrification Line

Subdivision FOREST TRAILS Lot # 36

Tax ID # _____ Quadrant # _____

Number of Bedrooms Proposed: 3 Lot Size: .59 AC

Basement with Plumbing: Garage:

Water Supply: Well Public Community

Distance From Well: 100 ft.

Following is the minimum specifications for sewage disposal system on above captioned property. Subject to final approval.

Type of system: Conventional Other 25% REDUCTION SYSTEM

Size of tank: Septic Tank: 1000 gallons Pump Tank: _____ gallons

Subsurface Drainage Field No. of ditches 3 exact length of each ditch 100 ft. width of ditches 3 ft. depth of ditches 18 in.

French Drain Required: _____ Linear feet

Date: 2/5/04

This permit is subject to revocation if site plans or intended use change.

Signed: [Signature] RS (OLIVER TOLKSOFF)
 Environmental Health Specialist

- * MAINTAIN ALL SETBACKS
- * CALL WITH ANY QUESTIONS PRIOR TO INSTALLATION

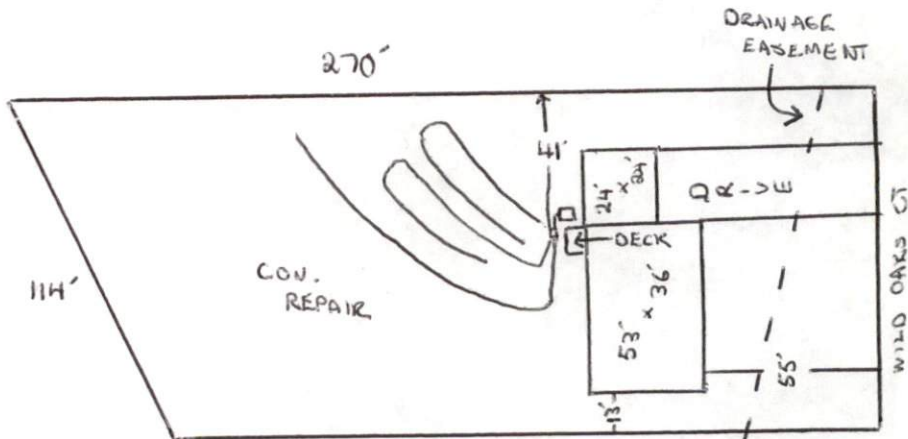

HARNETT COUNTY HEALTH DEPARTMENT
AUTHORIZATION TO CONSTRUCT

Authorization is hereby given to construct a wastewater system to the specifications described by Harnett County Health Department, Improvement Permit # 21045. This authorization shall be valid for a period not to exceed five (5) years from the date of issuance. This authorization will be invalid if ownership, site plans, or intended use change.

Name COMFORT HOMES INC Telephone# 919-553-3242

Address PO Box 369 CLAYTON NC 27520

Property Location SR# 1412 CHRISTIAN LIGHT RD

Subdivision FOREST TRAILS Lot # 36 # Bedrooms Proposed 3 Road Name 59AC Lot Size

TYPE OF SYSTEM

New Installation Repair Septic Tank Nitrification Lines

Conventional Other 25% REDUCTION SYSTEM

Basement With Plumbing Without Plumbing

Water Supply: Well Public Water Supply Minimum Well Setback: 100 Ft.

Septic Tank 1000 gal Pump Chamber gal

NITRIFICATION FIELD SPECIFICATIONS

Number of fields 1 # of lines per field 3 Length of lines 100 Ft.

Width of ditches 3 ft. Depth of ditches 12 inches

French Drain: Linear feet required Depth of gravel

No wastewater system shall be covered or placed into use by any person until an inspection by the Harnett County Health Department has determined that the system has been installed according to the conditions of the Improvement Permit and that a valid Operations Permit has been issued.

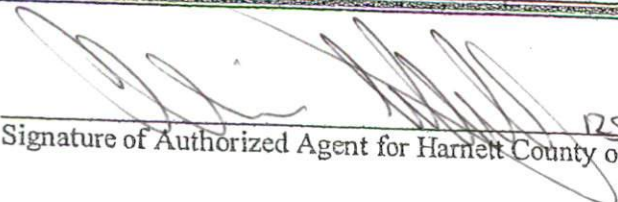
 Signature of Authorized Agent for Harnett County of Harnett

2/5/04 Date