

# IMPROVEMENT PERMIT

03-5-5842

Be it ordained by the Harnett County Board of Health as follows: Section III, Item B. "No Person shall begin construction of any building at which a septic tank system is to be used for disposal of sewage without first obtaining a written permit from the Harnett County Health Department."

Name: (owner) Johnnie Canady  New Installation  Septic Tank  
Property Location: SR# 1115  Repairs  Nitrification Line

Subdivision Cherokee Lake Lot # 16

Tax ID # \_\_\_\_\_ Quadrant # \_\_\_\_\_

Number of Bedrooms Proposed: 3 (50x43) Lot Size: 0.787

Basement with Plumbing:  Garage:  Please note change in house location. Home had to be moved because of slope & topography  
Water Supply:  Well  Public  Community  
Distance From Well: \_\_\_\_\_ ft.

Following is the minimum specifications for sewage disposal system on above captioned property. Subject to final approval.

Type of system:  Conventional  Other Pump to Conventional

Size of tank: Septic Tank: 1000 gallons Pump Tank: 1000 gallons

Subsurface Drainage Field No. of ditches 4 exact length of each ditch 60 ft. width of ditches 3 ft. depth of ditches 18" in.

French Drain Required: \_\_\_\_\_ Linear feet

Date: 12-4-02

This permit is subject to revocation if site plans or intended use change. Lot 15

Signed: [Signature]  
Environmental Health Specialist

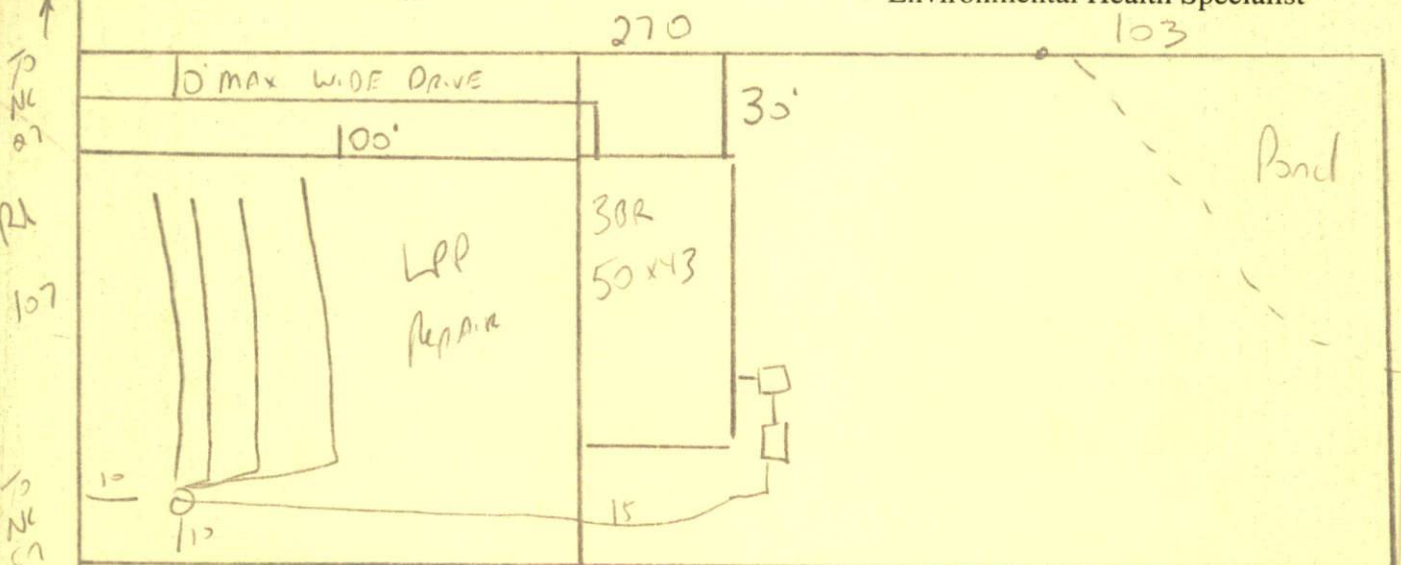

Please note change in house & Drive location / Drive must be along Lot 16/15 Property Line, 10' wide max. House had to be moved due to slope & topography of lot. Meet onsite maintain all set backs - must meet onsite Do not Drive or Park on septic system

HARNETT COUNTY HEALTH DEPARTMENT  
AUTORIZATION TO CONSTRUCT

Authorization is hereby given to construct a wastewater system to the specifications described by Harnett County Health Department, Improvement Permit # 19914. This authorization shall be valid for a period not to exceed five (5) years from the date of issuance. This authorization will be invalid if ownership, site plans, or intended use change.

Johnnie Canady

919-422-8413

Name

Telephone #

Address

1115

Property Location SR#

Road Name

Crestview Lakes

16

3(50x43)

0.787 AC

Subdivision

Lot #

# Bedrooms Proposed

Lot size

TYPE OF SYSTEM

New Installation [ ] Repair  Septic Tank  Nitrification Lines

[ ] Conventional Other Pump & Sewer [ ] Basement [ ] With Plumbing [ ] Without Plumbing

Water Supply: [ ] Well  Public - Minimum Well Setback: 50 Ft.  
Septic Tank 1000 Pump Chamber 1000

NITRIFICATION FIELD SPECIFICATIONS

Number of fields 1 # of lines per field 4 Length of lines 60 Ft.

Width of ditches 3 ft. Depth of ditches 18-24 inches

French Drain: Linear feet required \_\_\_\_\_ Depth of gravel \_\_\_\_\_

No wastewater system shall be covered or placed into use by any person until an inspection by the Harnett County Health Department has determined that the system has been installed according to the conditions of the Improvement Permit and that a valid Operations Permit has been issued.

Joe Wentz

12-4-02

Signature of Authorized Agent for Harnett County

Date