

IMPROVEMENT PERMIT

03-5-5742

Be it ordained by the Harnett County Board of Health as follows: Section III, Item B. "No Person shall begin construction of any building at which a septic tank system is to be used for disposal of sewage without first obtaining a written permit from the Harnett County Health Department."

Name: (owner) Kent Pierce
Property Location: SR# 1115
New Installation, Septic Tank, Repairs, Nitrification Line

Subdivision Peach Tree Lot # 108

Tax ID # Quadrant #

Number of Bedrooms Proposed: 3 (27x48) Lot Size: .50 AC

Basement with Plumbing: Garage:
Water Supply: Well, Public, Community
Distance From Well: 50 ft.

Following is the minimum specifications for sewage disposal system on above captioned property. Subject to final approval.

Type of system: Conventional, Other

Size of tank: Septic Tank: 1000 gallons Pump Tank: gallons

Subsurface Drainage Field No. of ditches 1 exact length of each ditch 240 ft. width of ditches 3 ft. depth of ditches 18.24 in.

French Drain Required: 101 Linear feet

Date: 10-29-02
Signed: J. W. ... Environmental Health Specialist

This permit is subject to revocation if site plans or intended use change.

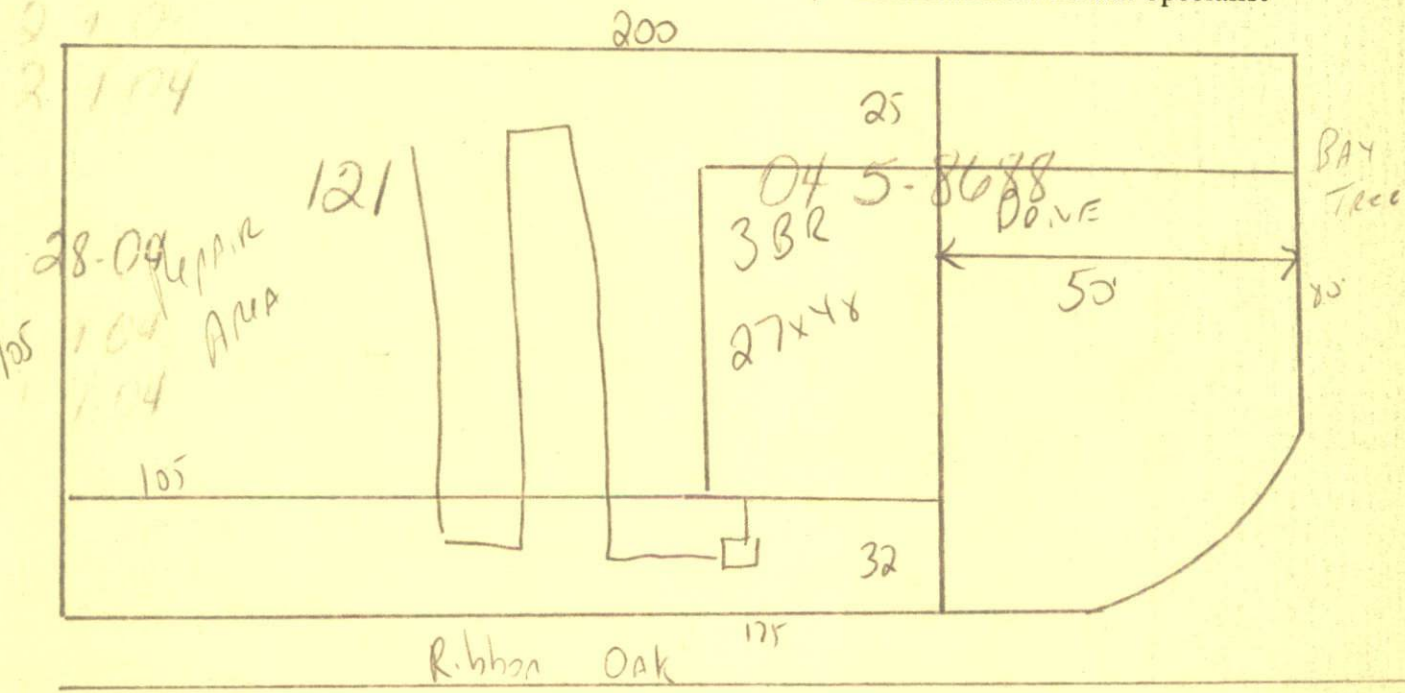

STUB out Plumbing shallow
Do not Drive or park on septic SYSTEM

HARNETT COUNTY HEALTH DEPARTMENT
AUTHORIZATION TO CONSTRUCT

Authorization is hereby given to construct a wastewater system to the specifications described by Harnett County Health Department, Improvement Permit # 19779. This authorization shall be valid for a period not to exceed five (5) years from the date of issuance. This authorization will be invalid if ownership, site plans, or intended use change.

Name Kent Pierce Telephone # 424-1294

Address _____

Property Location SR# 1115 Road Name _____

Subdivision Peach Tree Lot # 108 # Bedrooms Proposed 3(27x48) Lot size 50AC

TYPE OF SYSTEM

New Installation [] Repair Septic Tank Nitrification Lines

Conventional Other _____

[] Basement [] With Plumbing [] Without Plumbing

Water Supply: [] Well Public - Minimum Well Setback: 50 Ft.
Septic Tank 1000 Pump Chamber _____

NITRIFICATION FIELD SPECIFICATIONS

Number of fields 1 # of lines per field 1 Length of lines 240 Ft.

Width of ditches 3 ft. Depth of ditches 18 inches

French Drain: Linear feet required _____ Depth of gravel _____

No wastewater system shall be covered or placed into use by any person until an inspection by the Harnett County Health Department has determined that the system has been installed according to the conditions of the Improvement Permit and that a valid Operations Permit has been issued.

Signature of Authorized Agent for Harnett County [Signature] Date 10-29-02