

03-5-5645

NETT COUNTY HEALTH DEPARTMENT
ENVIRONMENTAL HEALTH SECTION

No 15484

OPERATIONS PERMIT

Name: (owner) Staniel Blvd. New Installation Septic Tank
 Property Location: SR# 1403 Repairs Nitrification Line
 Subdivision Cokesbury Park Lot # 15
 TAX ID# _____ Quadrant # _____
 Contractor: Staniel Blvd. Registration # _____

Basement with Plumbing: Garage:
 Water Supply: Well Public Community
 Distance From Well: 50 ft.

Following are the specifications for the sewage disposal system on above captioned property.

Type of system: Conventional Other _____
 Size of tank: Septic Tank: 1000 gallons Pump Tank: _____ gallons
 Subsurface Drainage Field: No. of ditches 2 exact length of each ditch 75 ft. width of ditches 3 ft. depth of ditches 18-20 in.
 French Drain: _____ Linear feet

PERMIT NO. 19725

Date: 1/28/2003
 Inspected by: Barry Lewis
 Environmental Health Specialist

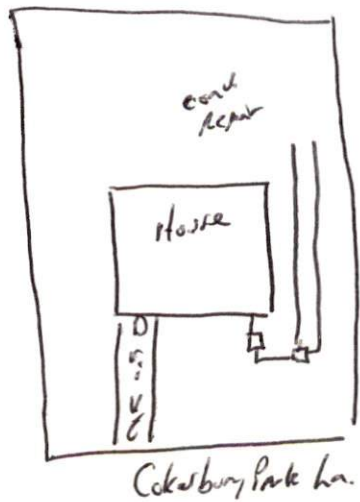

* Barry Lewis Elec.
 Truck parked on drain lines
 2/13/2003
 Bm