

03-5-5551

HARNETT COUNTY HEALTH DEPART NT

No 19656

IMPROVEMENT PERMIT

Be it ordained by the Harnett County Board of Health as follows: Section III, Item B. "No Person shall begin construction of any building at which a septic tank system is to be used for disposal of sewage without first obtaining a written permit from the Harnett County Health Department."

Name: (owner) SHOWCASE CONSTRUCTION Co. New Installation Septic Tank
Property Location: SR# 1106 HILLMAN GROVE RD Repairs Nitrification Line

Subdivision BUFFALO CREEKS ESTATE Lot # 3

Tax ID # _____ Quadrant # _____

Number of Bedrooms Proposed: 4 Lot Size: 7.23 AC

Basement with Plumbing: Garage:

Water Supply: Well Public Community

Distance From Well: 100 ft.

Following is the minimum specifications for sewage disposal system on above captioned property. Subject to final approval.

Type of system: Conventional Other _____

Size of tank: Septic Tank: 1000 gallons Pump Tank: _____ gallons

Subsurface No. of exact length width of depth of
Drainage Field ditches 4 of each ditch 50 ft. ditches 3 ft. ditches 24 in.

French Drain Required: _____ Linear feet

Date: 9/24/02

This permit is subject to revocation if site plans or intended use change.

Signed: [Signature] OLIVER TOLKSDORF
Environmental Health Specialist

* MAINTAIN ALL SETBACKS

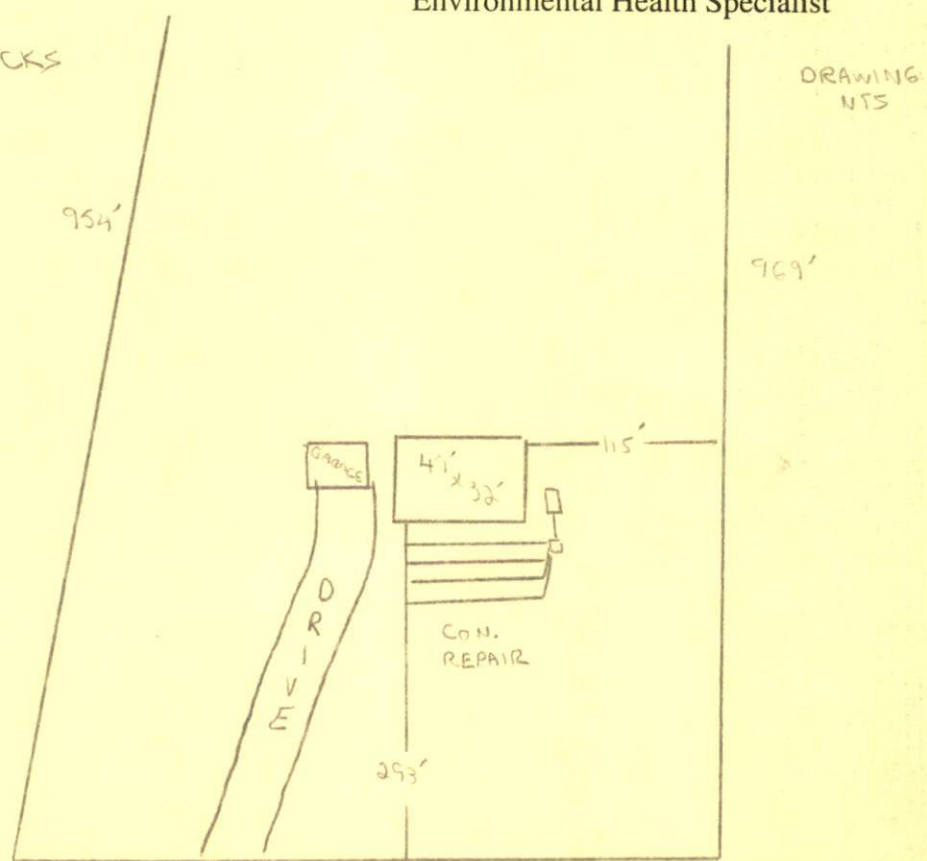

SR 1106

HARNETT COUNTY HEALTH DEPARTMENT
AUTHORIZATION TO CONSTRUCT

Authorization is hereby given to construct a wastewater system to the specifications described by Harnett County Health Department, Improvement Permit # 19656. This authorization shall be valid for a period not to exceed five (5) years from the date of issuance. This authorization will be invalid if ownership, site plans, or intended use change.

SHOWCASE CONSTRUCTION Co. 910-864-0900
Name Telephone #

PO Box 11104 FAYETTEVILLE NC 28303
Address

1106 HILLMAN GROVE RD
Property Location SR# Road Name

BUFFALO CREEKS ESTATE 3 4 7.23 AC
Subdivision Lot # # Bedrooms Proposed Lot size

TYPE OF SYSTEM

New Installation [] Repair Septic Tank Nitrification Lines

Conventional Other _____ [] Basement [] With Plumbing [] Without Plumbing

Water Supply: [] Well Public - Minimum Well Setback: 100 Ft.
Septic Tank 1000 gal Pump Chamber _____

NITRIFICATION FIELD SPECIFICATIONS

Number of fields 1 # of lines per field 4 Length of lines 50 Ft.

Width of ditches 3 ft. Depth of ditches 24 inches

French Drain: Linear feet required _____ Depth of gravel _____

No wastewater system shall be covered or placed into use by any person until an inspection by the Harnett County Health Department has determined that the system has been installed according to the conditions of the Improvement Permit and that a valid Operations Permit has been issued.

Signature of Authorized Agent for Harnett County 9/24/02
Date