

03-5-5533

# IMPROVEMENT PERMIT

Be it ordained by the Harnett County Board of Health as follows: Section III, Item B. "No Person shall begin construction of any building at which a septic tank system is to be used for disposal of sewage without first obtaining a written permit from the Harnett County Health Department."

Name: (owner) Robert Jones Cont.  New Installation  Septic Tank  
Property Location: SR# 1415 Rowles Ch. Rd.  Repairs  Nitrification Line

Subdivision \_\_\_\_\_ Lot # 2

Tax ID # \_\_\_\_\_ Quadrant # \_\_\_\_\_

Number of Bedrooms Proposed: 3 Lot Size: 25,230 ft<sup>2</sup>

Basement with Plumbing:  Garage:

Water Supply:  Well  Public  Community

Distance From Well: 50 ft.

Following is the minimum specifications for sewage disposal system on above captioned property. Subject to final approval.

Type of system:  Conventional  Other \_\_\_\_\_

Size of tank: Septic Tank: 1000 gallons Pump Tank: \_\_\_\_\_ gallons

Subsurface Drainage Field No. of ditches 5 exact length of each ditch 60 ft. width of ditches 3 ft. depth of ditches 1-20 in.

French Drain Required: \_\_\_\_\_ Linear feet

Date: 9/30/2002

This permit is subject to revocation if site plans or intended use change.

Signed: Bryan McJannet R.S.  
Environmental Health Specialist

\* Maintain all setbacks  
\* Run ditches on center

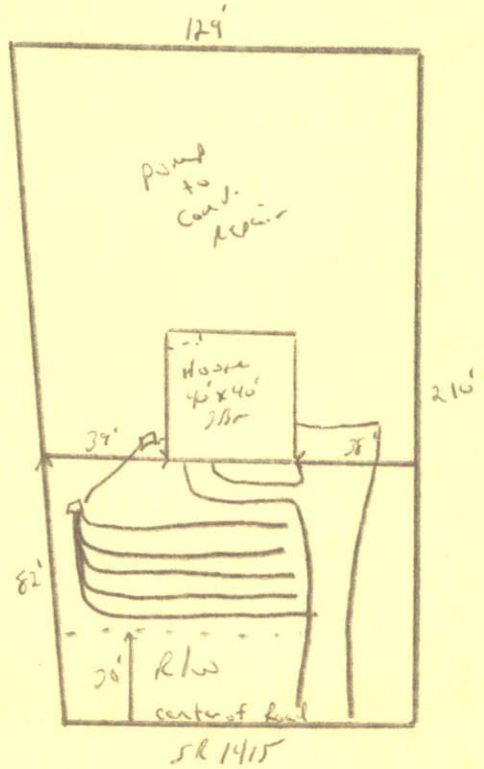

HARNETT COUNTY HEALTH DEPARTMENT  
AUTORIZATION TO CONSTRUCT

Authorization is hereby given to construct a wastewater system to the specifications described by Harnett County Health Department, Improvement Permit # 19710. This authorization shall be valid for a period not to exceed five (5) years from the date of issuance. This authorization will be invalid if ownership, site plans, or intended use change.

Robert Jones Gen. Cont. 814-0383  
Name Telephone #

P.O. Box 183 Boies Creek, N.C. 27506  
Address

1415 Boies Cr.  
Property Location SR# Road Name

2 3 25,230 ft<sup>2</sup>  
Subdivision Lot # # Bedrooms Proposed Lot size

TYPE OF SYSTEM

New Installation [ ] Repair [  ] Septic Tank [  ] Nitrification Lines

Conventional Other \_\_\_\_\_ [ ] Basement [ ] With Plumbing [ ] Without Plumbing

Water Supply: [ ] Well [  ] Public - Minimum Well Setback: 50 Ft.  
Septic Tank 1000 Pump Chamber \_\_\_\_\_

NITRIFICATION FIELD SPECIFICATIONS

Number of fields 1 # of lines per field 5 Length of lines 60 Ft.

Width of ditches 3 ft. Depth of ditches 18.20 inches

French Drain: Linear feet required \_\_\_\_\_ Depth of gravel \_\_\_\_\_

No wastewater system shall be covered or placed into use by any person until an inspection by the Harnett County Health Department has determined that the system has been installed according to the conditions of the Improvement Permit and that a valid Operations Permit has been issued.

Bryan McLean R.T. 9/20/2002  
Signature of Authorized Agent for Harnett County Date