

Initial Application Date: 9-11-02

Application # 03-5-5528

145 Cresthaven
COUNTY OF HARNETT LAND USE APPLICATION

Planning Department

102 E. Front Street, Lillington, NC 27546

Phone: (910) 893-7525

Fax: (910) 893-2793

LANDOWNER: HUTAFF CONSTRUCTION & DEVELOPMENT Address: 6000 RUSH RD
City: Fayetteville State: NC Zip: 28305 Phone #: 910-404-5848

APPLICANT: HUTAFF CONSTRUCTION & DEVELOPMENT Address: 6000 RUSH RD
City: Fayetteville State: NC Zip: 28305 Phone #: 910-404-5848

PROPERTY LOCATION: SR #: 1115 SR Name: CRESTHAVEN DR Buffalo Lake Rd.
Parcel: 03958704002031 PIN: 9587-70-7426
Zoning: RA20R Subdivision: CRESTVIEW ESTATES PHS Lot #: 66 Lot Size: .35
Flood Plain: X Panel: 75 Watershed: NA Deed Book/Page: OTP Plat Book/Page: 2001-301

DIRECTIONS TO THE PROPERTY FROM LILLINGTON: HWY 275 TURN LEFT ON BUFFALO LK RD
1 mi TURN LEFT INTO CRESTVIEW EST.

PROPOSED USE:

- Sg. Family Dwelling (Size 54 x ⁴²30) # of Bedrooms 3 Basement NO Garage 24x30 Deck 18x14
- Multi-Family Dwelling No. Units _____ No. Bedrooms/Unit _____
- Manufactured Home (Size ___ x ___) # of Bedrooms _____ Garage _____ Deck _____
- Comments: _____
- Number of persons per household SPEC
- Business Sq. Ft. Retail Space _____ Type _____
- Industry Sq. Ft. _____ Type _____
- Home Occupation (Size ___ x ___) # Rooms _____ Use _____
- Accessory Building (Size ___ x ___) Use _____
- Addition to Existing Building (Size ___ x ___) Use _____
- Other _____

included in total size
included in total size

Water Supply: County Well (No. dwellings _____) Other _____
Sewer: Septic Tank/ Existing: YES NO County Other _____
Erosion & Sedimentation Control Plan Required? YES NO
Structures on this tract of land: Single family dwellings 1 Manufactured homes _____ Other (specify) _____
Property owner of this tract of land own land that contains PROPOSED a manufactured home w/in five hundred feet (500') of tract listed above? YES NO

Required Property Line Setbacks:	Minimum	Actual	Minimum	Actual
Front	<u>35</u>	<u>45</u>	Rear	<u>25</u> <u>63</u>
Side	<u>10/15</u>	<u>20/20</u>	Corner	_____
Nearest Building	<u>10</u>	_____		

If permits are granted I agree to conform to all ordinances and the laws of the State of North Carolina regulating such work and the specifications or plans submitted. I hereby swear that the foregoing statements are accurate and correct to the best of my knowledge.

Henry H. Kibbey Jr.
Signature of Applicant

9-11-02
Date

#758 9-18 S

HL - FF CONSTRUCTION ✓

66 CRESTVIEW

.35 AC

Required Property Line Setbacks

	Minimum	Actual
Front	<u>35'</u>	<u>45'</u>
Side	<u>10'</u>	<u>20'</u>
Corner	<u> </u>	<u> </u>
Rear	<u>25'</u>	<u>63'</u>
Nearest Building	<u>10'</u>	<u> </u>

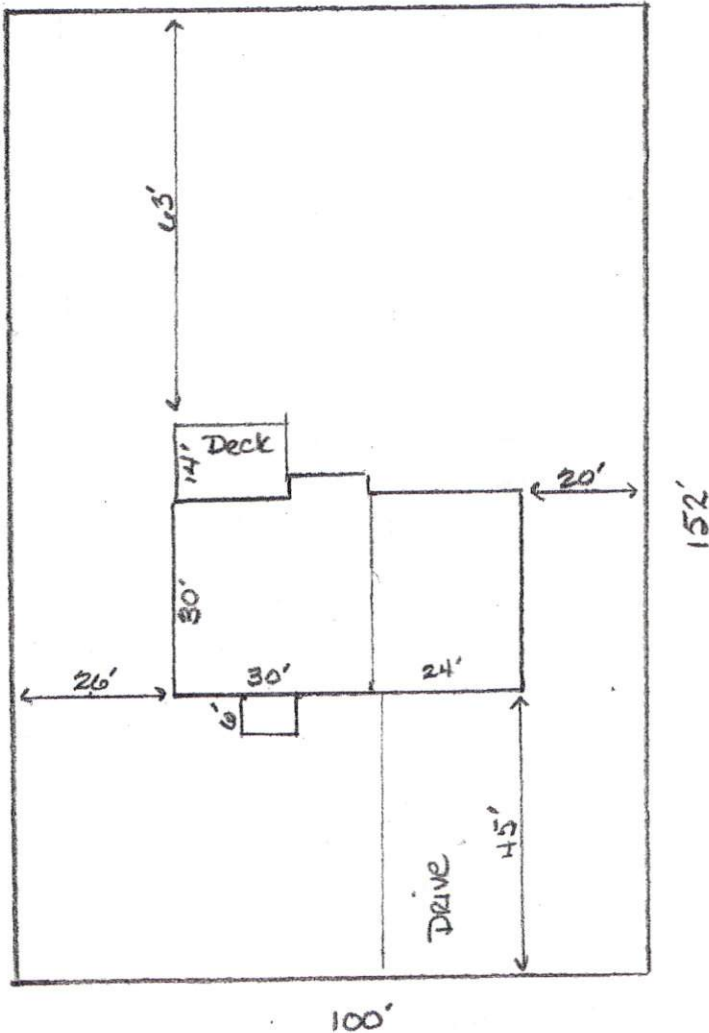

SITE PLAN APPROVAL

DISTRICT RAZOR USE SF.D

#BEDROOMS 3

Date 9-12-02 D Johnson
Zoning Administrator

1" = 30'

HARNETT COUNTY CASH RECEIPTS

*** CUSTOMER RECEIPT ***

Oper: DJOHNSON Type: CP Drawer: 1
Date: 9/12/02 00 Receipt no: 53229

Customer	Location Name	Amount
68447	71100 HUTAFF CONSTRUCTION	
U4	UT-METER CHARGE	\$70.00
	2003 50005528	
B4	BP - ENV HEALTH 1	\$150.00
	NEW	
68447	71100 HUTAFF CONSTRUCTION	
U8	UT-TRANSFER SET	\$10.00

Tender detail		
CK CHECK PAY	1299	\$230.00
Total tendered		\$230.00
Total payment		\$230.00

Trans date: 9/12/02 Time: 9:26:43

** THANK YOU FOR YOUR PAYMENT **