

Initial Application Date: 9-5-02

Application # 13-5-5526

City of Weddwood Court
COUNTY OF HARNETT LAND USE APPLICATION

Central Permitting

102 E. Front Street, Lillington, NC 27546

Phone: (910) 893-4759

Fax: (910) 893-2793

LANDOWNER: B.C.P. Development Mailing Address: P.O. Box 727
City: Durham State: NC Zip: 28335 Phone #: 910-897-4693

APPLICANT: Dorrey Norris Mailing Address: P.O. Box 727
City: Durham State: NC Zip: 28335 Phone #: 910-892-4345

PROPERTY LOCATION: SR #: 1115 SR Name: Buffalo Lake Rd.
Parcel: C3-9581-07-0020-06 PIN: 5
Zoning: KA20K Subdivision: Crestview Lot #: 5 Lot Size: 0.34 AC
Flood Plain: Y Panel: 0075 Watershed: N/A Deed Book/Page: 1320-491 Plat Book/Page: 98-455

DIRECTIONS TO THE PROPERTY FROM LILLINGTON: Take 27W to Buffalo Lake Rd. Turn left go approx 2 miles. Sub on left.

PROPOSED USE:
 Sg. Family Dwelling (Size 54 x 40) # of Bedrooms 3 # Baths 2 1/2 Basement (w/wo bath) — Garage 24x26 Deck 18x10 ^{Patio}

Multi-Family Dwelling No. Units _____ No. Bedrooms/Unit _____
 Manufactured Home (Size _____ x _____) # of Bedrooms _____ Garage _____ Deck _____

Comments: _____
 Number of persons per household 4
 Business Sq. Ft. Retail Space _____ Type _____
 Industry Sq. Ft. _____ Type _____
 Home Occupation (Size _____ x _____) # Rooms _____ Use _____
 Accessory Building (Size _____ x _____) Use _____
 Addition to Existing Building (Size _____ x _____) Use _____
 Other _____

included in total size

Water Supply: County Well (No. dwellings _____) Other _____

Sewage Supply: New Septic Tank Existing Septic Tank County Sewer Other _____

Erosion & Sedimentation Control Plan Required? YES NO

Structures on this tract of land: Single family dwellings _____ Manufactured homes _____ Other (specify) _____

Property owner of this tract of land own land that contains a manufactured home within five hundred feet (500') of tract listed above? YES NO

Required Property Line Setbacks:	Minimum	Actual	Minimum	Actual
Front	<u>35</u>	<u>37</u>	Rear	<u>25</u>
Side	<u>10</u>	<u>22</u>	Corner	<u>—</u>
Nearest Building	<u>10</u>	<u>—</u>		

If permits are granted I agree to conform to all ordinances and the laws of the State of North Carolina regulating such work and the specifications or plans submitted. I hereby swear that the foregoing statements are accurate and correct to the best of my knowledge.

Dorrey Pate
Signature of Applicant

9-5-02
Date

This application expires 6 months from the date issued if no permits have been issued

9/27 1776 S

Southeastern Soil & Environmental Associates, Inc.

Soil - Environmental Consultant

P.O. Box 9321 • Fayetteville, NC 28311
Phone/Fax: (910) 822-4540

P.O. Box 808 • Fuquay-Varina, NC 27526
Phone/Fax: (919) 567-3017

CREST VIEW
LOT 5

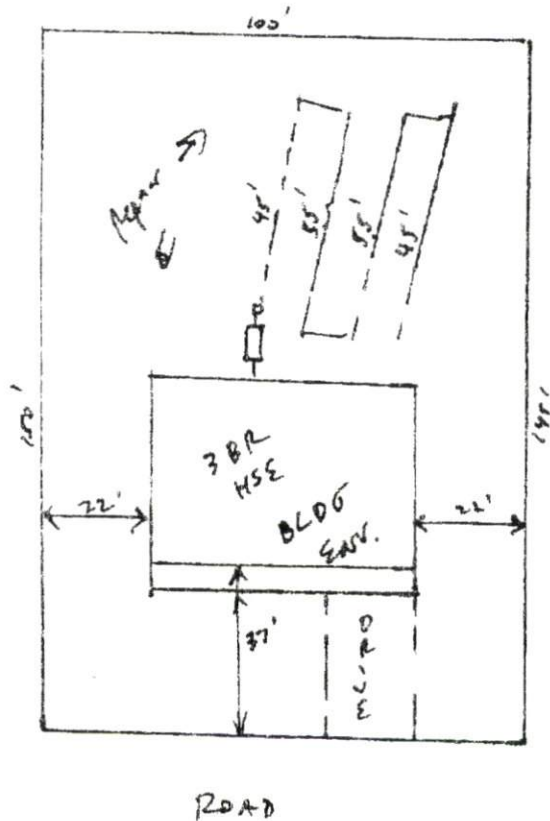

Typ Soil

- 0-10 CS
- 10-36+ SLAM
- 0.6 CLAR
- 1 X 200' CANV

1" = 40'

9904362

FILED
BOOK 336 PAGE 57-58

'89 MAR 9 PM 12 54
KIMBERLY S. HARGROVE
REGISTER OF DEEDS
HARNETT COUNTY, NC

Excise Tax

0.00

Recording Time, Book and Page

Tax Lot No. _____ Parcel Identifier No. _____

Verified by _____ County on the _____ day of _____

Mail after recording to Ray McLean, Attorney, P.O. Drawer 668, Coats, NC 27521

This instrument was prepared by Ray McLean, Attorney

Brief description for the Index
lots 4, 5, 6, 7, 20, 21, 22, 30, 31, & 38, Crestview S/D

NORTH CAROLINA GENERAL WARRANTY DEED

THIS DEED made this 5 day of March, 1990, by and between

GRANTOR

GRANTEE

Barry C. Pate
and wife,
Judy M. Pate
P.O. Box 81
Erwin, NC 28339

Mainstreet Cabinets, Inc.
P.O. Box 81
Erwin, NC 28339

Enter in appropriate block for each party: name, address, and, if appropriate, character of entity, e.g. corporation or partnership.

The designation Grantor and Grantee as used herein shall include said parties, their heirs, successors, and assigns, and shall include singular, plural, masculine, feminine or neuter as required by context.

WITNESSETH, that the Grantor, for a valuable consideration paid by the Grantee, the receipt of which is hereby acknowledged, has and by these presents does grant, bargain, sell and convey unto the Grantee in fee simple, all that certain lot or parcel of land situated in the City of _____ County, North Carolina and more particularly described as follows:

BEING all of Lots 4, 5, 6, 7, 20, 21, 22, 30, 31, and 38 of Crestview Subdivision, as shown recorded in Book 90, Page 455, of the Harnett County Registry.

03-9887-07-0020	05+ - 66+ - 07+ - 0
03-9887-07-0020	21+ - 22
03-9887-07-0020	31
	32
	39

3/9 BY Ray

FILED
BOOK 1320 PAGE 491-492
'98 DEC 30 PM 4 20
KIMBERLY S. HARGROVE
REGISTER OF DEEDS
HARNETT COUNTY, NC

12-30-98
HARNETT COUNTY NC
12/30/98
\$220.00
\$226.00
Real Estate
Excise Tax

Excise Tax 226.00 Recording Time, Book and Page

Tax Lot No. _____ Parcel Identifier No. _____
Verified by _____ County on the _____ day of _____
by _____

Mail after recording to Ray McLean, P.O. Drawer 668, Coats, NC 27521

This instrument was prepared by Ray McLean, Attorney

Brief description for the Index: Lots 4, 5, 6, 7, 20, 21, 22, 30, 31 & 38, Chestview S/D

NORTH CAROLINA GENERAL WARRANTY DEED

THIS DEED made this 30 day of December, 1998, by and between

GRANTOR
Crestview Development, a North
Carolina Limited Liability Company
P.O. Box 727
Dunn, NC 28335

GRANTEE
Barry C. Pate
and wife,
Judy M. Pate
9825 Hwy. 421
Erwin, N.C. 28339

Enter in appropriate block for each party: name, address, and, if appropriate, character of entity, e.g. corporation or partnership.
The designation Grantor and Grantee as used herein shall include said parties, their heirs, successors, and assigns, and shall include singular, plural, masculine, feminine or neuter as required by context.
WITNESSETH, that the Grantor, for a valuable consideration paid by the Grantee, the receipt of which is hereby acknowledged, has and by these presents does grant, bargain, sell and convey unto the Grantee in fee simple, all that certain lot or parcel of land situated in the City of _____ Township, _____ County, North Carolina and more particularly described as follows:

BRING all of Lots 4, 5, 6, 7, 20, 21, 30, 31 and 38, of Crestview Subdivision, as shown recorded in Book 98, page 455, of the Harnett County Registry.

HARNETT COUNTY, NORTH CAROLINA
FILED DATE 12-30-98 TIME 8:33 P.M.
BOOK 1320 PAGE 491-492
REGISTER OF DEEDS
KIMBERLY S. HARGROVE

HARNETT COUNTY TAX 108
To be assigned
12/30 BY 807

773