

03-5-5321

HARNETT COUNTY HEALTH DEPARTMENT

No 13896

IMPROVEMENT PERMIT

Be it ordained by the Harnett County Board of Health as follows: Section III, Item B. "No Person shall begin construction of any building at which a septic tank system is to be used for disposal of sewage without first obtaining a written permit from the Harnett County Health Department."

Name: (owner) Kenneth Moss

New Installation Septic Tank

Property Location: SR# 1443 Lafayette Rd.

Repairs Nitrification Line

Subdivision Victoria Hills II Lot # 194

Tax ID # _____ Quadrant # _____

Number of Bedrooms Proposed: 3 Lot Size: _____

Basement with Plumbing: Garage:

Water Supply: Well Public Community

Distance From Well: 50 min ft.

Following is the minimum specifications for sewage disposal system on above captioned property. Subject to final approval.

Type of system: Conventional Other _____

Size of tank: Septic Tank: 1000 gallons Pump Tank: _____ gallons

Subsurface Drainage Field No. of ditches 3 exact length of each ditch 100 ft. width of ditches 3 ft. depth of ditches 18-24 in.

French Drain Required: _____ Linear feet

Date: 8/14/2002

This permit is subject to revocation if site plans or intended use change.

Signed: Roger M. P.S.
Environmental Health Specialist

* Maintain all setbacks
* Run ditches on contour

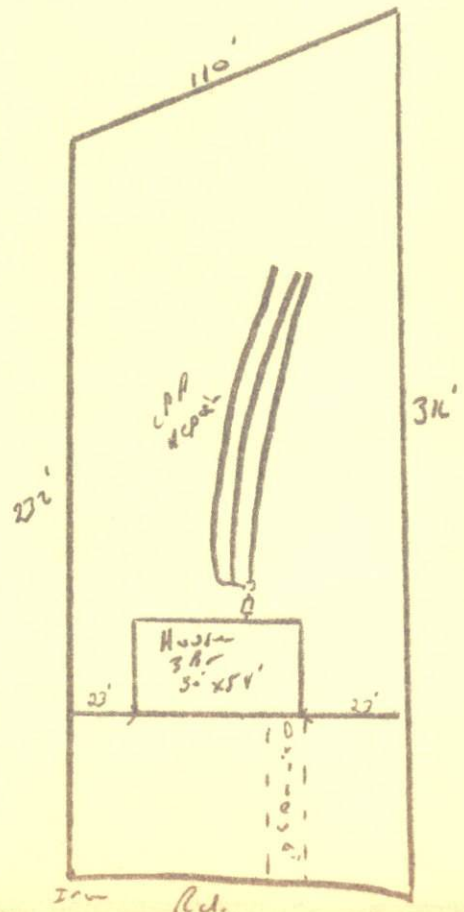

HA TT COUNTY HEALTH DEPARTMENT
AUTHORIZATION TO CONSTRUCT

Authorization is hereby given to construct a wastewater system to the specifications described by Harnett County Health Department, Improvement Permit # 13896. This authorization shall be valid for a period not to exceed five (5) years from the date of issuance. This authorization will be invalid if ownership, site plans, or intended use change.

Name Kenneth Mos Telephone # 893-4875
Address P.O. Box 577 Lillington, N.C. 27546
Property Location SR# 1443 Road Name Lafayette
Subdivision Victoria Hills II Lot # 194 # Bedrooms Proposed 3 Lot size _____

TYPE OF SYSTEM

New Installation Repair Septic Tank Nitrification Lines
 Conventional Other _____ Basement With Plumbing Without Plumbing
Water Supply: Well Public - Minimum Well Setback: 50 Ft.
Septic Tank 1000 Pump Chamber _____

NITRIFICATION FIELD SPECIFICATIONS

Number of fields 1 # of lines per field 3 Length of lines 100 Ft.
Width of ditches 3 ft. Depth of ditches 18-24 inches
French Drain: Linear feet required _____ Depth of gravel _____

No wastewater system shall be covered or placed into use by any person until an inspection by the Harnett County Health Department has determined that the system has been installed according to the conditions of the Improvement Permit and that a valid Operations Permit has been issued.

Signature of Authorized Agent for Harnett County Bryan M. Dixon R.S. Date 8/14/2002