

02-5-4737

IMPROVEMENT PERMIT

Be it ordained by the Harnett County Board of Health as follows: Section III, Item B. "No Person shall begin construction of any building at which a septic tank system is to be used for disposal of sewage without first obtaining a written permit from the Harnett County Health Department."

Name: (owner) Keith Bullock Builders

New Installation Septic Tank

Property Location: SR# 1479 Wood Dening Rd.

Repairs Nitrification Line

Subdivision Johnson Farms II Lot # 8

Tax ID # _____ Quadrant # _____

Number of Bedrooms Proposed: 4 Lot Size: 1.08 Ac

Basement with Plumbing: Garage:

Water Supply: Well Public Community

Distance From Well: 50 mi - ft.

Following is the minimum specifications for sewage disposal system on above captioned property. Subject to final approval.

Type of system: Conventional Other Pump to Conventional

Size of tank: Septic Tank: 1000 gallons Pump Tank: 1000 gallons

Subsurface Drainage Field No. of ditches 5 exact length of each ditch 110 ft. width of ditches 3 ft. depth of ditches 20-18 in.

French Drain Required: _____ Linear feet

Date: 6/3/2002

This permit is subject to revocation if site plans or intended use change.

Signed: Bryan M. J. P. S.
Environmental Health Specialist

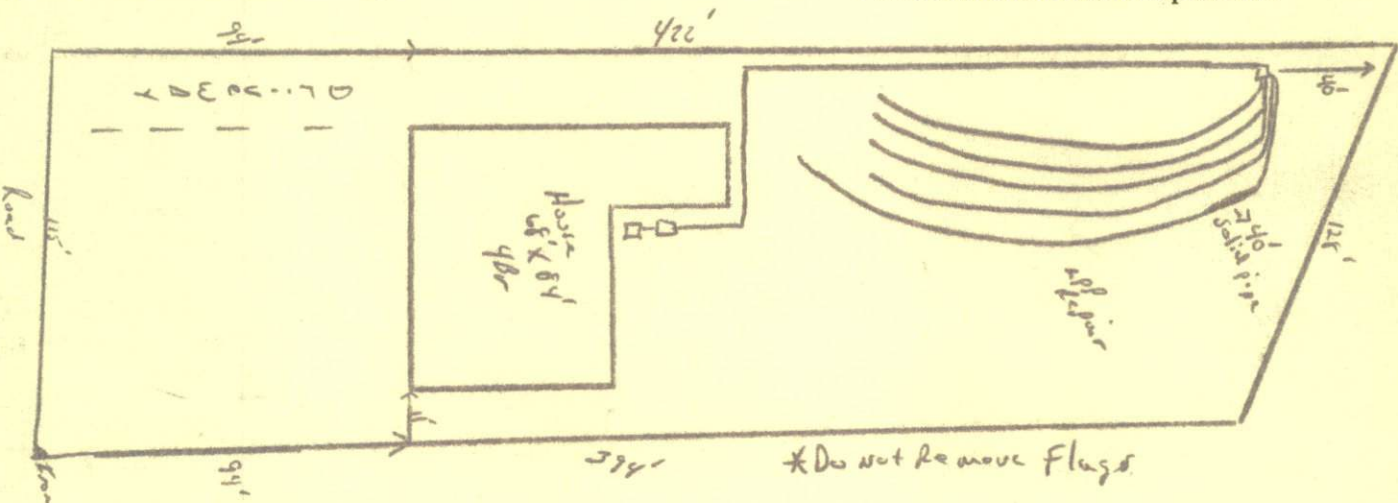

- * Maintain all setbacks
- * Contractor to meet on-site prior to installing system
- * Run lines on contour start ditches at 20 inches & run to 18 inches
- * System will be installed as drawn or permit will be revoked

**HARNETT COUNTY HEALTH DEPARTMENT
AUTHORIZATION TO CONSTRUCT**

Authorization is hereby given to construct a wastewater system to the specifications described by Harnett County Health Department, Improvement Permit # 13877. This authorization shall be valid for a period not to exceed five (5) years from the date of issuance. This authorization will be invalid if ownership, site plans, or intended use change.

Keith Bullock 639-7424
Name Telephone#

72 Overlook Ct. Angier, N.C. 27501
Address

1439 Wed Deary
Property Location SR# Road Name

Johansen Farm II 8 4 1.08 ac
Subdivision Lot # # Bedrooms Proposed Lot Size

TYPE OF SYSTEM

New Installation Repair Septic Tank Nitrification Lines

Conventional Other Pump to Conventional

Basement With Plumbing Without Plumbing

Water Supply: Well Public Water Supply Minimum Well Setback: 50 Ft.

Septic Tank 1000 Pump Chamber 1000

NITRIFICATION FIELD SPECIFICATIONS

Number of fields 1 # of lines per field 5 Length of lines 110 Ft.

Width of ditches 3 ft. Depth of ditches 20-18 inches

French Drain: Linear feet required _____ Depth of gravel _____

No wastewater system shall be covered or placed into use by any person until an inspection by the Harnett County Health Department has determined that the system has been installed according to the conditions of the Improvement Permit and that a valid Operations Permit has been issued.

Bryce M. Lewis R.S. 6/3/2002
Signature of Authorized Agent for Harnett County of Harnett Date