

02-5-4728

IMPROVEMENT PERMIT

Be it ordained by the Harnett County Board of Health as follows: Section III, Item B. "No Person shall begin construction of any building at which a septic tank system is to be used for disposal of sewage without first obtaining a written permit from the Harnett County Health Department."

Name: (owner) MICHAEL JOHNSON New Installation Septic Tank
Property Location: SR# 2026 BYROS POND RD Repairs Nitrification Line

Subdivision BYRO POND EST. Lot # 5

Tax ID # _____ Quadrant # _____

Number of Bedrooms Proposed: 3 Lot Size: .535 AC

Basement with Plumbing: Garage:

Water Supply: Well Public Community

Distance From Well: 100 ft.

Following is the minimum specifications for sewage disposal system on above captioned property. Subject to final approval.

Type of system: Conventional Other _____

Size of tank: Septic Tank: 1000 gallons Pump Tank: _____ gallons

Subsurface Drainage Field No. of ditches 4 exact length of each ditch 85 ft. width of ditches 3 ft. depth of ditches 12-14 in.

French Drain Required: _____ Linear feet

Date: 6/7/02

This permit is subject to revocation if site plans or intended use change.

Signed: _____

Environmental Health Specialist

- * MAINTAIN ALL SET-BACKS
- * 6" OF COVER NEEDED OVER ENTIRE SYSTEM
- * CALL WITH ANY QUESTIONS PRIOR TO INSTALLATION

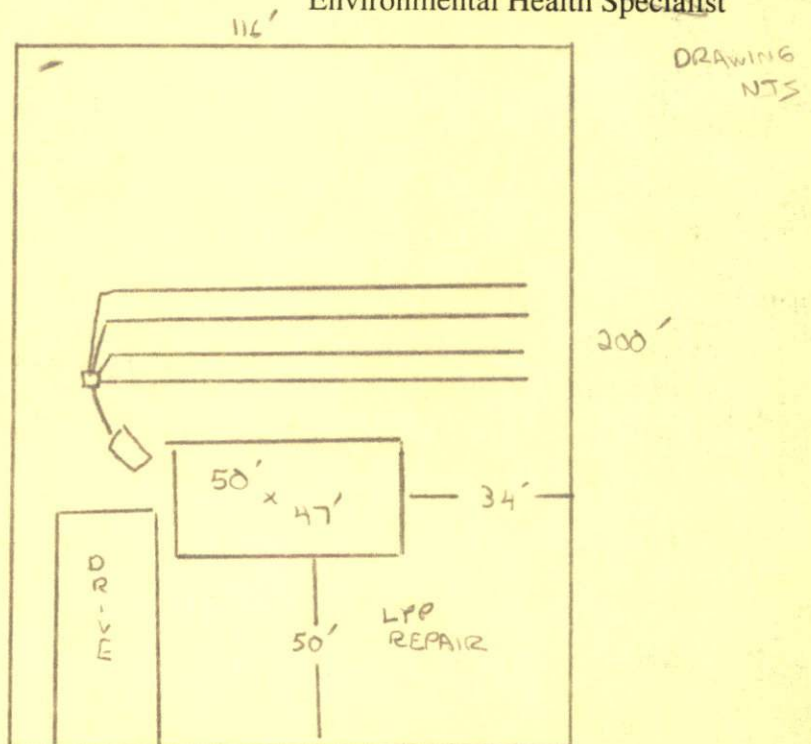

HARNETT COUNTY HEALTH DEPARTMENT
AUTHORIZATION TO CONSTRUCT

Authorization is hereby given to construct a wastewater system to the specifications described by Harnett County Health Department, Improvement Permit # 19501. This authorization shall be valid for a period not to exceed five (5) years from the date of issuance. *This authorization will be invalid if ownership, site plans, or intended use change.*

MICHAEL JOHNSON 910-237-1785
Name Telephone #

PO Box 2298 DUNN NC 28335
Address

BYRD POND RD 2026
Property Location SR# Road Name

BYRD POND EST 5 3 1536AC
Subdivision Lot # # Bedrooms Proposed Lot size

TYPE OF SYSTEM

New Installation [] Repair Septic Tank Nitrification Lines

Conventional Other _____ [] Basement [] With Plumbing [] Without Plumbing

Water Supply: [] Well Public - Minimum Well Setback: 100 Ft.
Septic Tank 1000 Pump Chamber _____

NITRIFICATION FIELD SPECIFICATIONS

Number of fields 1 # of lines per field 4 Length of lines 85 Ft.

Width of ditches 3 ft. Depth of ditches 12-14 inches

French Drain: Linear feet required _____ Depth of gravel _____

No wastewater system shall be covered or placed into use by any person until an inspection by the Harnett County Health Department has determined that the system has been installed according to the conditions of the Improvement Permit and that a valid Operations Permit has been issued.

[Signature] 6/8/02
Signature of Authorized Agent for Harnett County Date