

02-5-4455

HARNETT COUNTY HEALTH DEPARTMENT

No 19134

IMPROVEMENT PERMIT

Be it ordained by the Harnett County Board of Health as follows: Section III, Item B. "No Person shall begin construction of any building at which a septic tank system is to be used for disposal of sewage without first obtaining a written permit from the Harnett County Health Department."

Name: (owner) ROGER EDWARDS

New Installation Septic Tank

Property Location: SR# 1443 LAFAYETTE RD

Repairs Nitrification Line

Subdivision VICTORIA HILLS III

Lot # 77

Tax ID # _____

Quadrant # _____

Number of Bedrooms Proposed: 3

Lot Size: 36947 ft²

Basement with Plumbing:

Garage:

Water Supply: Well Public

Community

Distance From Well: 100 ft.

Following is the minimum specifications for sewage disposal system on above captioned property. Subject to final approval.

Type of system: Conventional

Other _____

Size of tank: Septic Tank: 1000 gallons

Pump Tank: _____ gallons

Subsurface
Drainage Field

No. of
ditches 5
exact length
of each ditch 80 ft.

width of
ditches 3 ft. depth of
ditches 18-20 in.

French Drain Required: _____ Linear feet

Date: 5/7/02

Signed: _____

Environmental Health Specialist

This permit is subject to revocation if site plans or intended use change.

DRAWING
NTS

* MAINTAIN ALL SETBACKS

11-22-02 * RUN LINES ON CONTOUR

* CALL WITH ANY QUESTIONS
PRIOR TO INSTALLATION

1-13-03

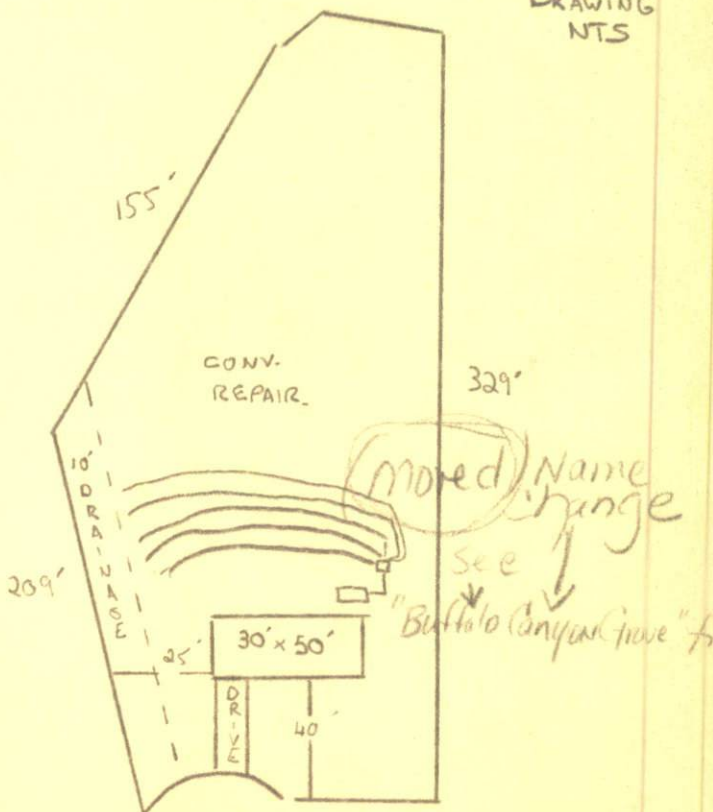

HA TT COUNTY HEALTH DEPARTMENT
AUTHORIZATION TO CONSTRUCT

Authorization is hereby given to construct a wastewater system to the specifications described by Harnett County Health Department, Improvement Permit # 19134. This authorization shall be valid for a period not to exceed five (5) years from the date of issuance. *This authorization will be invalid if ownership, site plans, or intended use change.*

ROGER EDWARDS 919-669-5353
Name Telephone #
1879 GOAT ISLAND RD SUMMERTON SC 29148
Address
1443 LAFAYETTE RD
Property Location SR# Road Name
VICTORIA HILLS 77 3 36947ft²
Subdivision Lot # # Bedrooms Proposed Lot size

TYPE OF SYSTEM

New Installation [] Repair Septic Tank Nitrification Lines

Conventional Other _____ [] Basement [] With Plumbing [] Without Plumbing

Water Supply: [] Well Public - Minimum Well Setback: 100 Ft.
Septic Tank 1000 Pump Chamber _____

NITRIFICATION FIELD SPECIFICATIONS

Number of fields 1 # of lines per field 5 Length of lines 80 Ft.

Width of ditches 3 ft. Depth of ditches 18 inches

French Drain: Linear feet required _____ Depth of gravel _____

No wastewater system shall be covered or placed into use by any person until an inspection by the Harnett County Health Department has determined that the system has been installed according to the conditions of the Improvement Permit and that a valid Operations Permit has been issued.

[Signature] 5/6/02
Signature of Authorized Agent for Harnett County Date