

02-5-4450

HARNETT COUNTY HEALTH DEPARTMENT

No 19144

IMPROVEMENT PERMIT

Be it ordained by the Harnett County Board of Health as follows: Section III, Item B. "No Person shall begin construction of any building at which a septic tank system is to be used for disposal of sewage without first obtaining a written permit from the Harnett County Health Department."

Name: (owner) ROGER EDWARDS

New Installation Septic Tank

Property Location: SR# 1443 LAFAYETTE RD

Repairs Nitrification Line

Subdivision VICTORIA HILLS III Lot # 93

Tax ID # _____ Quadrant # _____

Number of Bedrooms Proposed: 3 Lot Size: 43254ft²

Basement with Plumbing: Garage:

Water Supply: Well Public Community

Distance From Well: 100 ft.

Following is the minimum specifications for sewage disposal system on above captioned property. Subject to final approval.

Type of system: Conventional Other PUMP TO CONVENTIONAL

Size of tank: Septic Tank: 1000 gallons Pump Tank: 1000 gallons

Subsurface Drainage Field No. of ditches 5 exact length of each ditch 80 ft. width of ditches 3 ft. depth of ditches 18-20 in.

French Drain Required: _____ Linear feet

Date: 5/13/02

This permit is subject to revocation if site plans or intended use change.

Signed: [Signature]
Environmental Health Specialist

- * MAINTAIN ALL SETBACKS
- * RUN LINES ON CONTOUR
- * IF FALL CAN BE ACHIEVED WITHOUT A PUMP IT MAY BE OMITTED
- * CALL WITH ANY QUESTIONS PRIOR TO INSTALLATION

26-03

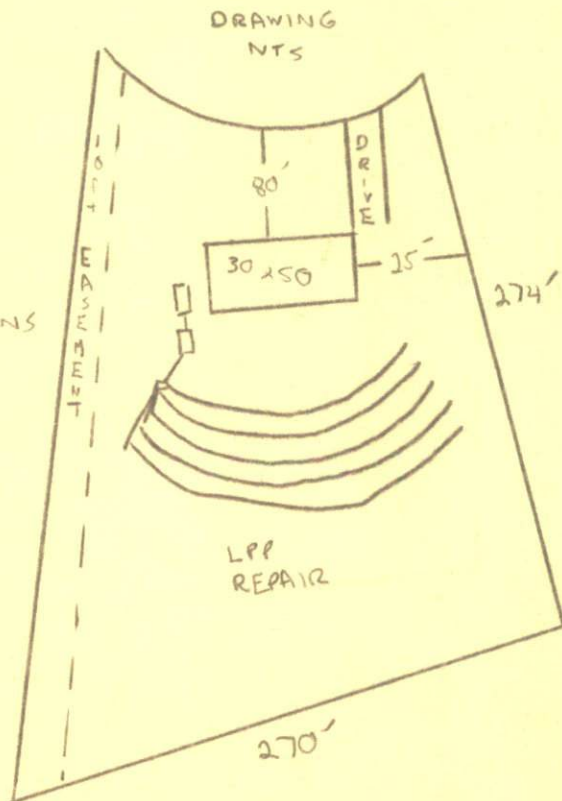

HARNETT COUNTY HEALTH DEPARTMENT
AUTHORIZATION TO CONSTRUCT

Authorization is hereby given to construct a wastewater system to the specifications described by Harnett County Health Department, Improvement Permit # 19144. This authorization shall be valid for a period not to exceed five (5) years from the date of issuance. *This authorization will be invalid if ownership, site plans, or intended use change.*

ROGER EDWARDS 919-669-53-53
Name Telephone #
1879 GOAT ISLAND RD SUMMERTON SC 29148
Address
1743 LAFAYETTE RD
Property Location SR# Road Name
VICTORIA HILLS III 93 3 43254ft²
Subdivision Lot # # Bedrooms Proposed Lot size

TYPE OF SYSTEM

New Installation [] Repair Septic Tank Nitrification Lines
[] Conventional Other Pump To Conv. [] Basement [] With Plumbing [] Without Plumbing
Water Supply: [] Well Public - Minimum Well Setback: 100 Ft.
Septic Tank 1000 Pump Chamber 1000

NITRIFICATION FIELD SPECIFICATIONS

Number of fields 1 # of lines per field 45 Length of lines 80 Ft.
Width of ditches 3 ft. Depth of ditches 18-20 inches
French Drain: Linear feet required _____ Depth of gravel _____

No wastewater system shall be covered or placed into use by any person until an inspection by the Harnett County Health Department has determined that the system has been installed according to the conditions of the Improvement Permit and that a valid Operations Permit has been issued.

[Signature] 5/13/02
Signature of Authorized Agent for Harnett County Date