

02-5-4362

IMPROVEMENT PERMIT

Be it ordained by the Harnett County Board of Health as follows: Section III, Item B. "No Person shall begin construction of any building at which a septic tank system is to be used for disposal of sewage without first obtaining a written permit from the Harnett County Health Department."

Name: (owner) Robert Jones

New Installation Septic Tank

Property Location: SR# 1430 Olive Branch Rd

Repairs Nitrification Line

Subdivision Ernest Webster Lot # 1

Tax ID # _____ Quadrant # _____

Number of Bedrooms Proposed: 3 Lot Size: .806 Ac

Basement with Plumbing: Garage:

Water Supply: Well Public Community

Distance From Well: 50 min ft.

Following is the minimum specifications for sewage disposal system on above captioned property. Subject to final approval.

Type of system: Conventional Other _____

Size of tank: Septic Tank: 1000 gallons Pump Tank: _____ gallons

Subsurface Drainage Field No. of ditches 4 exact length of each ditch 100 ft. width of ditches 3 ft. depth of ditches 18-20 in.

French Drain Required: _____ Linear feet

Date: 4/18/2002

This permit is subject to revocation if site plans or intended use change.

Signed: Sharon M. Jordan R.S.
Environmental Health Specialist

* Maintain all setbacks
* Run ditches on contour +
NO DEEPER than 20 inches

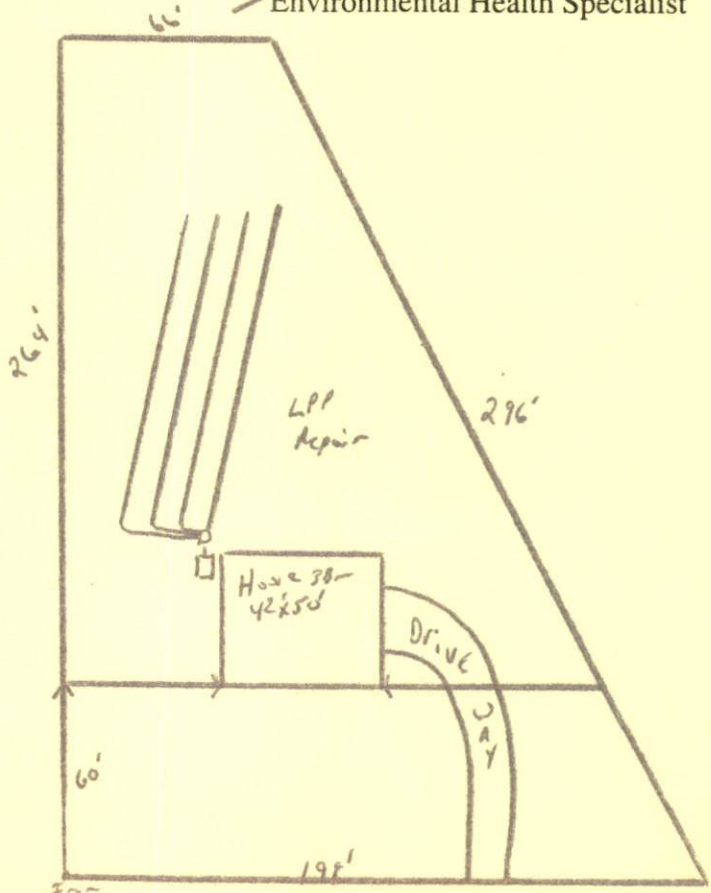

SR 1430

HARNETT COUNTY HEALTH DEPARTMENT
AUTHORIZATION TO CONSTRUCT

Authorization is hereby given to construct a wastewater system to the specifications described by Harnett County Health Department, Improvement Permit # 13857. This authorization shall be valid for a period not to exceed five (5) years from the date of issuance. *This authorization will be invalid if ownership, site plans, or intended use change.*

Robert Jones 814-0383
Name Telephone #

P.O. Box 183 Brier Creek N.C. 27506
Address

1430 Oliver Branch
Property Location SR# Road Name

Ernest Webster 1 3 806 sq
Subdivision Lot # # Bedrooms Proposed Lot size

TYPE OF SYSTEM

New Installation Repair Septic Tank Nitrification Lines

Conventional Other _____

Basement With Plumbing Without Plumbing

Water Supply: Well Public - Minimum Well Setback: 50 Ft.

NITRIFICATION FIELD SPECIFICATIONS

Number of fields 1 # of lines per field 4 Length of lines 105 Ft.

Width of ditches 3 ft. Depth of ditches 18-20 inches

French Drain: Linear feet required _____ Depth of gravel _____

No wastewater system shall be covered or placed into use by any person until an inspection by the Harnett County Health Department has determined that the system has been installed according to the conditions of the Improvement Permit and that a valid Operations Permit has been issued.

Bryan McLean R.S.
Signature of Authorized Agent for Harnett County

4/18/2002
Date