

# IMPROVEMENT PERMIT

Be it ordained by the Harnett County Board of Health as follows: Section III, Item B. "No Person shall begin construction of any building at which a septic tank system is to be used for disposal of sewage without first obtaining a written permit from the Harnett County Health Department."

Name: (owner) Gene Britton  New Installation  Septic Tank  
 Property Location: SR# 1415 Pauls Church  Repairs  Nitrification Line

Subdivision Woodland Ridge Lot # 3

Tax ID # \_\_\_\_\_ Quadrant # \_\_\_\_\_

Number of Bedrooms Proposed: 3 Lot Size: .96

Basement with Plumbing:  Garage:

Water Supply:  Well  Public  Community

Distance From Well: \_\_\_\_\_ ft.

Following is the minimum specifications for sewage disposal system on above captioned property. Subject to final approval.

Type of system:  Conventional  Other Pump to Conventional

Size of tank: Septic Tank: 1000 gallons Pump Tank: 1000 gallons

Subsurface Drainage Field No. of ditches 5 exact length of each ditch 70 ft. width of ditches 3 ft. depth of ditches 16-18 in.

French Drain Required: — Linear feet

Date: 3-25-02

This permit is subject to revocation if site plans or intended use change.

Signed: James E. Marshall  
 Environmental Health Specialist

\* Maintain all setbacks

\* System Layout + Type may change, PENDING ON CONTRACTOR TO MEET ON SITE PRIOR TO INSTALLATION

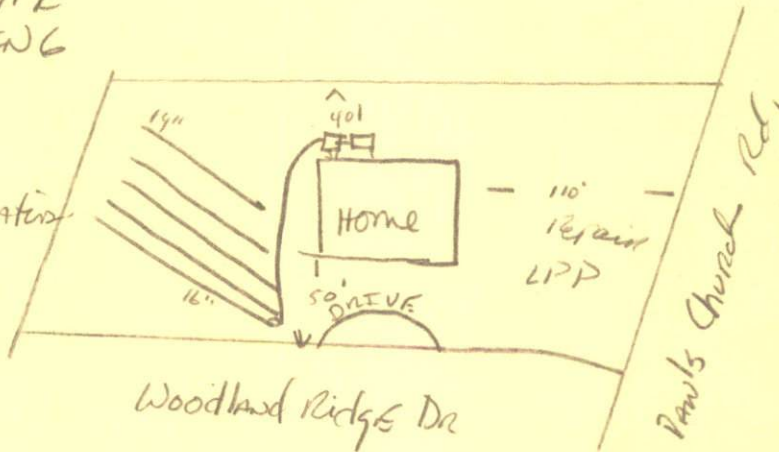

ARNETT COUNTY HEALTH DEPARTMENT  
AUTHORIZATION TO CONSTRUCT

Authorization is hereby given to construct a wastewater system to the specifications described by Harnett County Health Department, Improvement Permit # 18799. This authorization shall be valid for a period not to exceed five (5) years from the date of issuance. This authorization will be invalid if ownership, site plans, or intended use change.

Name Gene Patton Telephone # 919-567-1916

Address 200 Cassie Road E.V. N.C. 27540

Property Location SR# 1415 Road Name Pauls Chapel

Subdivision Woodland Ridge Lot # 3 # Bedrooms Proposed 3 Lot size .56

TYPE OF SYSTEM

New Installation  Repair  Septic Tank  Nitrification Lines

Conventional Other \_\_\_\_\_

Basement  With Plumbing  Without Plumbing

Water Supply:  Well  Public - Minimum Well Setback: \_\_\_\_\_ Ft.

NITRIFICATION FIELD SPECIFICATIONS

Number of fields 2 # of lines per field 5 Length of lines 70 Ft.

Width of ditches 3 ft. Depth of ditches 14-16 inches  
18-20

French Drain: Linear feet required \_\_\_\_\_ Depth of gravel \_\_\_\_\_

No wastewater system shall be covered or placed into use by any person until an inspection by the Harnett County Health Department has determined that the system has been installed according to the conditions of the Improvement Permit and that a valid Operations Permit has been issued.

Signature of Authorized Agent for Harnett County James E. Markham Date 3-25-02