

IMPROVEMENT PERMIT

40000124

Be it ordained by the Harnett County Board of Health as follows: Section III, Item B. "No Person shall begin construction of any building at which a septic tank system is to be used for disposal of sewage without first obtaining a written permit from the Harnett County Health Department."

Name: (owner) Cumberland Home Drngy Aeris
Property Location: SR# 1115
New Installation
Septic Tank
Repairs
Nitrification Line

Subdivision Peach Tree Lot # 46

Tax ID # Quadrant #

Number of Bedrooms Proposed: 3 (33x48) Lot Size: 0.461 AC Lot 46

Basement with Plumbing: Garage: MUST meet onsite

Water Supply: Well Public Community MUST use filter & marker

Distance From Well: ft. *NOTE change in house location

Following is the minimum specifications for sewage disposal system on above captioned property. Subject to final approval.

Type of system: Conventional Other

Size of tank: Septic Tank: 1000 gallons Pump Tank: gallons

Subsurface Drainage Field No. of ditches 1 exact length of each ditch 270 ft. width of ditches 3 ft. depth of ditches 18 in.

French Drain Required: Linear feet

Date: 02-21-2000

This permit is subject to revocation if site plans or intended use change.

Signed: Environmental Health Specialist

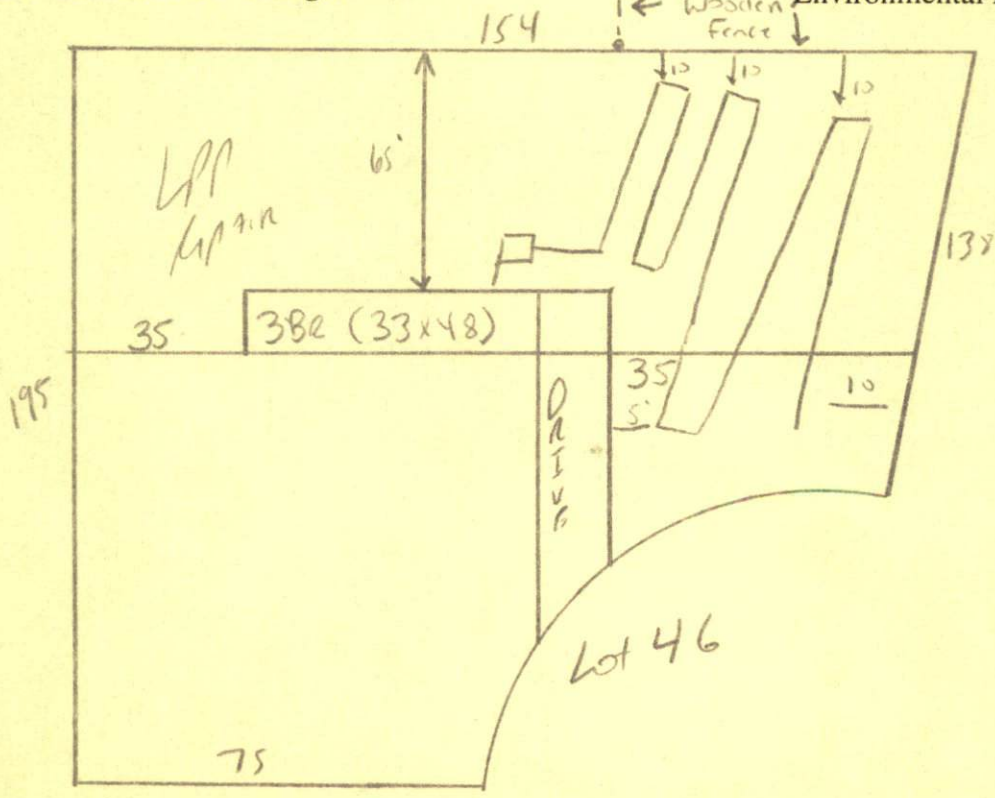

Meet onsite
18" D. to 4' depth
stub out
Plumbing
shallow

HARNETT COUNTY HEALTH DEPARTMENT
AUTHORIZATION TO CONSTRUCT

Authorization is hereby given to construct a wastewater system to the specifications described by Harnett County Health Department Improvement Permit # 17202. This authorization shall be valid for a period not to exceed five (5) years from the date of issuance. This authorization will be invalid if ownership, site plans, or intended use change.

Owner or Authorized Agent Cumberland Homes - Danny Nixey

Name: _____ Telephone # 892-4345

Address: _____

Property Location: SR # 1115 Road Name _____

New Installation Repair _____ Septic Tank Nitrification Lines

Subdivision Peach Tree Lot # 46

Number of Bedrooms Proposed: 3 Lot size: 461 AC

Basement _____ With Plumbing _____ Without Plumbing _____

Water Supply: Well _____ Public Minimum Well Setback: _____ ft.

Type of System: Conventional Other _____

Tank Volume: Septic Tank 1000 gallons Pump Chamber _____ gallons

Nitrification Field Specifications

Number of fields 1 Number of Lines per Field 1 Length of lines 270

Width of ditches 3 ft. Depth of ditches 18 inches

French Drain: Linear feet required _____ Depth of gravel _____

No wastewater system shall be covered or placed into use by any person until an inspection by the Harnett County Health Department has determined that the system has been installed according to the conditions of the improvement permit and that a valid operations permit has been issued.

Authorized Agent for Harnett County Health Department

Name: [Signature] Date: 2-24-2000