

IMPROVEMENT PERMIT

Be it ordained by the Harnett County Board of Health as follows: Section III, Item B. "No Person shall begin construction of any building at which a septic tank system is to be used for disposal of sewage without first obtaining a written permit from the Harnett County Health Department."

Name: (owner) MAK Development New Installation Septic Tank
Property Location: SR# 27 Repairs Nitrification Line

Subdivision Arbor Crest Lot # 10

Tax ID # _____ Quadrant # _____

Number of Bedrooms Proposed: 3 Lot Size: .81 Ac

Basement with Plumbing: Garage:

Water Supply: Well Public Community

Distance From Well: 50 min ft.

Following is the minimum specifications for sewage disposal system on above captioned property. Subject to final approval.

Type of system: Conventional Other Pump to Conventional

Size of tank: Septic Tank: 1000 gallons Pump Tank: 1000 gallons

Subsurface Drainage Field No. of ditches 3 exact length of each ditch 80 ft. width of ditches 3 ft. depth of ditches 18-24 in.

French Drain Required: _____ Linear feet

Date: 7/21/2000

This permit is subject to revocation if site plans or intended use change.

Signed: Bayron M. Jwan R.S.
Environmental Health Specialist

* Maintain setbacks
* House to be moved back
as drawn on permit

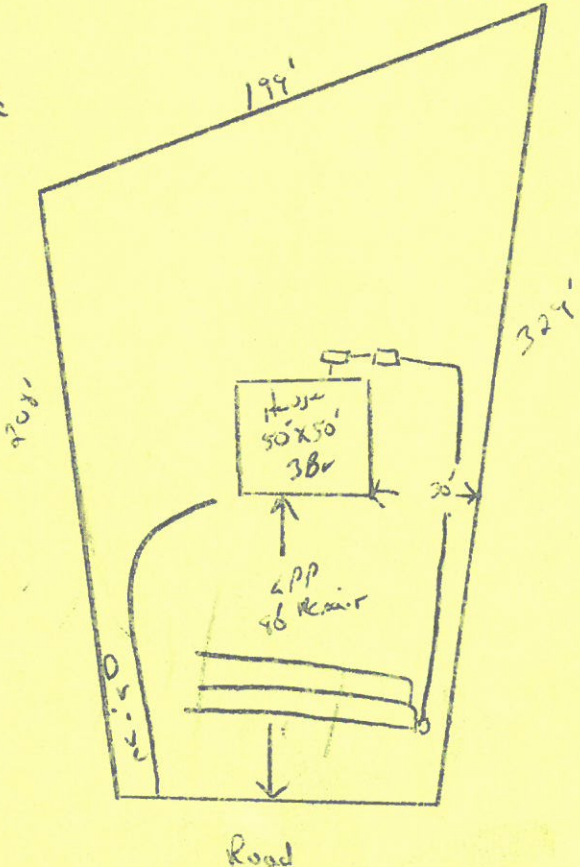

HARNETT COUNTY HEALTH DEPARTMENT
AUTHORIZATION TO CONSTRUCT

Authorization is hereby given to construct a wastewater system to the specifications described by Harnett County Health Department Improvement Permit # 17531. This authorization shall be valid for a period not to exceed five (5) years from the date of issuance. This authorization will be invalid if ownership, site plans, or intended use change.

Owner or Authorized Agent _____

Name: MAK Development Telephone # 639-8880
639-2011

Address: 1281 Jackson King Rd Willow Springs NC 27592

Property Location: SR # 27 Road Name _____

New Installation Repair Septic Tank Nitrification Lines

Subdivision Arbor Crest Lot # 10

Number of Bedrooms Proposed: 3 Lot size: .81Ac

Basement With Plumbing Without Plumbing

Water Supply: Well Public Minimum Well Setback: 50 ft.

Type of System: Conventional Other Pump to conventional

Tank Volume: Septic Tank 1000 gallons Pump Chamber 1000 gallons

Nitrification Field Specifications

Number of fields 1 Number of Lines per Field 3 Length of lines 80 ft.

Width of ditches 3 ft. Depth of ditches 18-24 inches

French Drain: Linear feet required _____ Depth of gravel _____

No wastewater system shall be covered or placed into use by any person until an inspection by the Harnett County Health Department has determined that the system has been installed according to the conditions of the improvement permit and that a valid operations permit has been issued.

Authorized Agent for Harnett County Health Department

Name: Dwayne M. Smith L.S. Date: 7/21/2000