

02-5-3834

IMPROVEMENT PERMIT

Be it ordained by the Harnett County Board of Health as follows: Section III, Item B. "No Person shall begin construction of any building at which a septic tank system is to be used for disposal of sewage without first obtaining a written permit from the Harnett County Health Department."

Name: (owner) A.L. CHAMPION New Installation Septic Tank
Property Location: SR# 1443 LAFAYETTE RD Repairs Nitrification Line

Subdivision Victoria Hills Lot # 72

Tax ID # _____ Quadrant # _____

Number of Bedrooms Proposed: 3 Lot Size: 39573 sq ft

Basement with Plumbing: Garage:

Water Supply: Well Public Community

Distance From Well: 100 ft.

Following is the minimum specifications for sewage disposal system on above captioned property. Subject to final approval.

Type of system: Conventional Other POLYSTYRENE AGGREGATE TRENCH

Size of tank: Septic Tank: 1000 gallons Pump Tank: SEE BELOW gallons

Subsurface Drainage Field No. of ditches 3 exact length of each ditch 100 ft. width of ditches 3 ft. depth of ditches 18 in.

French Drain Required: _____ Linear feet

Date: 3/22/02

Signed: _____

Environmental Health Specialist

This permit is subject to revocation if site plans or intended use change.

- * MAINTAIN ALL SETBACKS
- * RUN LINES ON CONTOUR
- * CALL WITH ANY QUESTIONS PRIOR TO INSTALLATION
- * A PUMP MAY BE REQUIRED IF DITCH DEPTHS AND PROPER FALL CANNOT BE MAINTAINED

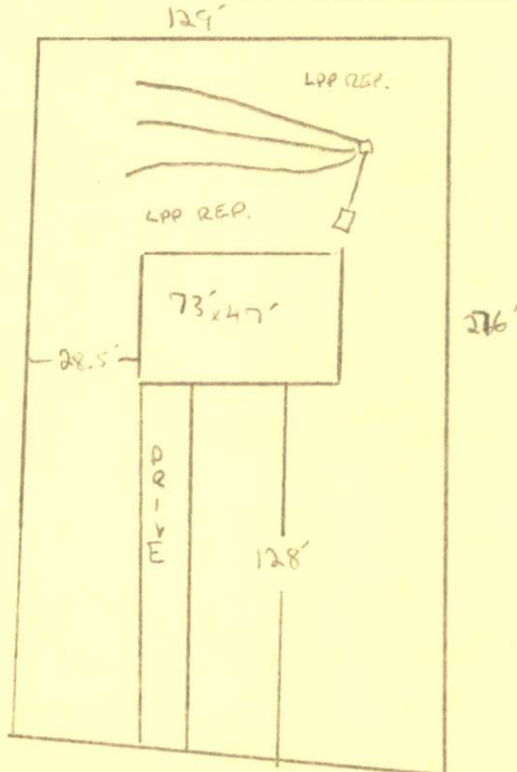

HARNETT COUNTY HEALTH DEPARTMENT
AUTHORIZATION TO CONSTRUCT

Authorization is hereby given to construct a wastewater system to the specifications described by Harnett County Health Department, Improvement Permit # 19000. This authorization shall be valid for a period not to exceed five (5) years from the date of issuance. This authorization will be invalid if ownership, site plans, or intended use change.

A.L. CHAMPION 919-639-3020
Name Telephone #
88 COLBY LN ANGIER NC 27501
Address
1443 LAFAYETTE RD
Property Location SR# Road Name
VICTORIA HILLS 72 3 39557 sq ft
Subdivision Lot # # Bedrooms Proposed Lot size

TYPE OF SYSTEM

New Installation Repair Septic Tank Nitrification Lines

Conventional Other POLYSTYRENE AGGREGATE TRENCH

Basement With Plumbing Without Plumbing

Water Supply: Well Public - Minimum Well Setback: 100 Ft.

NITRIFICATION FIELD SPECIFICATIONS

Number of fields 1 # of lines per field 3 Length of lines 100 Ft.

Width of ditches 3 ft. Depth of ditches 18 inches

French Drain: Linear feet required _____ Depth of gravel _____

No wastewater system shall be covered or placed into use by any person until an inspection by the Harnett County Health Department has determined that the system has been installed according to the conditions of the Improvement Permit and that a valid Operations Permit has been issued.

[Signature] 3/22/02
Signature of Authorized Agent for Harnett County Date