

IMPROVEMENT PERMIT

02-5-3757 Rev.

Be it ordained by the Harnett County Board of Health as follows: Section III, Item B. "No Person shall begin construction of any building at which a septic tank system is to be used for disposal of sewage without first obtaining a written permit from the Harnett County Health Department."

Name: (owner) William Gilchrist

New Installation Septic Tank

Property Location: SR# 1244

Repairs Nitrification Line

Subdivision Bogie Landing

Wayne Farrelsth

Lot # 1

Tax ID #

Quadrant #

Number of Bedrooms Proposed: 4 (40x45)

Lot Size: 3.31 Ac (Combination of 1A(1.00) 1B(1.15) 1C(1.16))

Basement with Plumbing:

Garage: Please note Pump may not

Water Supply: Well Public

Community Be Required STUB out Plumbing

Distance From Well: 50 ft.

Shallow Where shown - MUST meet contractor on site

Following is the minimum specifications for sewage disposal system on above captioned property. Subject to final approval.

Type of system: Conventional

Other Pump to Conventional

Please note changes

Size of tank: Septic Tank: 1000 gallons

Pump Tank: 1000 gallons

Subsurface Drainage Field

No. of ditches 1

exact length of each ditch 400 ft.

width of ditches 3 ft.

depth of ditches 18 in.

in house work MAT

French Drain Required: Linear feet

This permit is subject to revocation if site plans or intended use change.

Date: 6-28-02

Signed: [Signature]

Environmental Health Specialist

Please note change in house location. No part of house to be any closer than 50' from front property line.

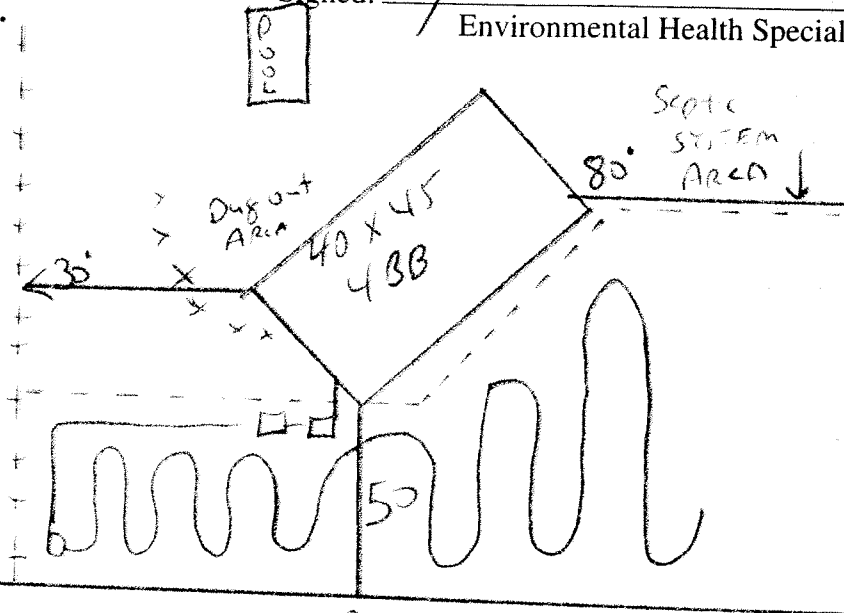

The Reason for the Pump is Because of some Digging in the House site location

Bogie Landing Drive

Please note The home must be 50' from The Front Property Line NO PART of The home CAN be Any closer Than 50' from Front Property Line MAY not Require Pump- MUST meet on site Before Installing- MUST meet All set Back e still meet 18" Ditch Depth

**HARNETT COUNTY HEALTH DEPARTMENT
AUTHORIZATION TO CONSTRUCT**

Authorization is hereby given to construct a wastewater system to the specifications described by Harnett County Health Department, Improvement Permit # 19475. This authorization shall be valid for a period not to exceed five (5) years from the date of issuance. *This authorization will be invalid if ownership, site plans, or intended use change.*

William Gilchrist

893-1112

Name

Telephone #

Address

1244

Property Location SR#

Road Name

Wayne Hancock

1

4(40x45)

3.31 Ac

Subdivision

Lot #

Bedrooms Proposed

Lot size

TYPE OF SYSTEM

*lot 1 is a combination
of lots 1A - 1.00 acres
1B - 1.15 acres
1C - 1.16 acres
total
3.31 ac*

New Installation Repair Septic Tank Nitrification Lines

Conventional Other Pump to Conv. Basement With Plumbing Without Plumbing

Water Supply: Well Public - Minimum Well Setback: 50 Ft.

Septic Tank

1000

Pump Chamber

1000

NITRIFICATION FIELD SPECIFICATIONS

Number of fields 1 # of lines per field 1 Length of lines 400 Ft.

Width of ditches 3 ft. Depth of ditches 18 in inches

French Drain: Linear feet required _____ Depth of gravel _____

No wastewater system shall be covered or placed into use by any person until an inspection by the Harnett County Health Department has determined that the system has been installed according to the conditions of the Improvement Permit and that a valid Operations Permit has been issued.

[Signature]

6-28-02

Signature of Authorized Agent for Harnett County

Date