

# IMPROVEMENT PERMIT

01-5-3398

Be it ordained by the Harnett County Board of Health as follows: Section III, Item B. "No Person shall begin construction of any building at which a septic tank system is to be used for disposal of sewage without first obtaining a written permit from the Harnett County Health Department."

Name: (owner) PRG Holdings  New Installation  Septic Tank  
Property Location: SR# 1116  Repairs  Nitrification Line

Subdivision Colonial Hills Lot # 76

Tax ID # \_\_\_\_\_ Quadrant # \_\_\_\_\_

Number of Bedrooms Proposed: 3 (65x36) Lot Size: 649 AC

Basement with Plumbing:  Garage:

Water Supply:  Well  Public  Community

Distance From Well: 50 ft.

Following is the minimum specifications for sewage disposal system on above captioned property. Subject to final approval.

Type of system:  Conventional  Other \_\_\_\_\_

Size of tank: Septic Tank: 1000 gallons Pump Tank: \_\_\_\_\_ gallons

Subsurface Drainage Field No. of ditches 1 exact length 240 ft. width of ditches 3 ft. depth of ditches 18 1/4 in.

French Drain Required: \_\_\_\_\_ Linear feet

Date: 11-14-01

This permit is subject to revocation if site plans or intended use change.

Signed: [Signature]  
Environmental Health Specialist

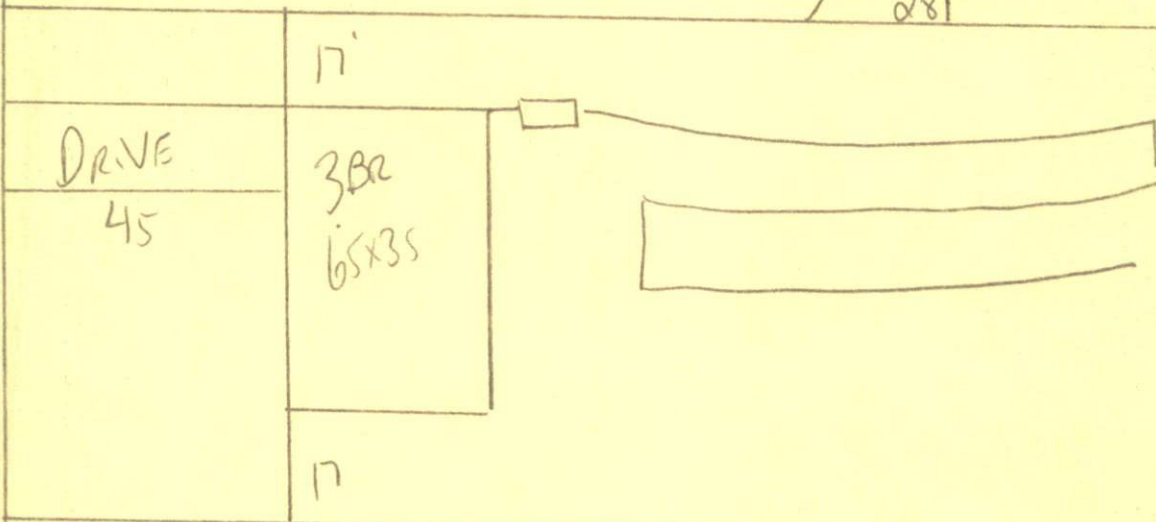

LPP  
Repair

Please Note - STUB out Plumbing shallow where shown OR pump will Be Required  
MAINTAIN ALL SETBACKS Do not DRIVE OR park on septic system - ~~do~~ Follow contours

HARNETT COUNTY HEALTH DEPARTMENT  
AUTHORIZATION TO CONSTRUCT

Authorization is hereby given to construct a wastewater system to the specifications described by Harnett County Health Department, Improvement Permit # 18936. This authorization shall be valid for a period not to exceed five (5) years from the date of issuance. *This authorization will be invalid if ownership, site plans, or intended use change.*

PRG Holdings 252-321-6237  
Name Telephone #  
4108 Country Down Greenville NC  
Address  
1116  
Property Location SR# 76 Road Name 3(65x36)  
Colonial Hills 649ac  
Subdivision Lot # # Bedrooms Proposed Lot size

TYPE OF SYSTEM

New Installation [ ] Repair [ ] Septic Tank [ ] Nitrification Lines

Conventional Other \_\_\_\_\_ [ ] Basement [ ] With Plumbing [ ] Without Plumbing

Water Supply: [ ] Well  Public - Minimum Well Setback: 50 Ft.

NITRIFICATION FIELD SPECIFICATIONS

Number of fields 1 # of lines per field 1 Length of lines 240 Ft.

Width of ditches 3 ft. Depth of ditches 18-24 inches

French Drain: Linear feet required \_\_\_\_\_ Depth of gravel \_\_\_\_\_

No wastewater system shall be covered or placed into use by any person until an inspection by the Harnett County Health Department has determined that the system has been installed according to the conditions of the Improvement Permit and that a valid Operations Permit has been issued.

[Signature]  
Signature of Authorized Agent for Harnett County

11-14-01  
Date