

IMPROVEMENT PERMIT

01-5-3025

Be it ordained by the Harnett County Board of Health as follows: Section III, Item B. "No Person shall begin construction of any building at which a septic tank system is to be used for disposal of sewage without first obtaining a written permit from the Harnett County Health Department."

Name: (owner) Price Const.
Property Location: SR# 1116
New Installation, Septic Tank, Repairs, Nitrification Line

Subdivision Colonial Hills Lot # 77

Tax ID # Quadrant #

Number of Bedrooms Proposed: 3 (37x56) Lot Size: .62 AC

Basement with Plumbing: Garage:
Water Supply: Well, Public, Community
Distance From Well: 50 ft.

Following is the minimum specifications for sewage disposal system on above captioned property. Subject to final approval.

Type of system: Conventional, Other

Size of tank: Septic Tank: 1000 gallons Pump Tank: gallons

Subsurface Drainage Field No. of ditches 1 exact length 240 ft. width of ditches 3 ft. depth of ditches 18 1/2 in.

French Drain Required: Linear feet

Date: 10.3.01
Signed: J. W. [Signature]
Environmental Health Specialist

This permit is subject to revocation if site plans or intended use change.

Rel 100

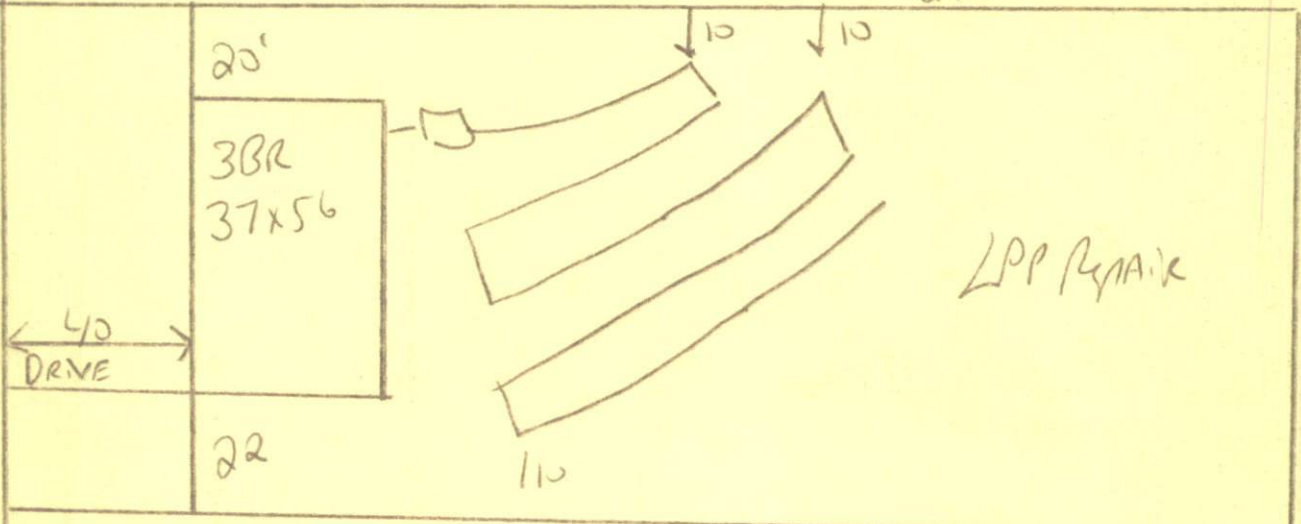

LPP Repair

281

STUB out Plumbing shallow - 18 to 24" Depth
MAintain All set Backs Do not Drive or park septic system

100

HARNETT COUNTY HEALTH DEPARTMENT
AUTHORIZATION TO CONSTRUCT

Authorization is hereby given to construct a wastewater system to the specifications described by Harnett County Health Department Improvement Permit # 18549. This authorization shall be valid for a period not to exceed five (5) years from the date of issuance. This authorization will be invalid if ownership, site plans, or intended use change.

Owner or Authorized Agent Price Const.

Name: _____ Telephone # 910 574-7100

Address: _____

Property Location: SR # 1116 Road Name _____

New Installation Repair _____ Septic Tank Nitrification Lines

Subdivision Colonial Hills Lot # 77

Number of Bedrooms Proposed: 3 (37x56) Lot size: .62 AC

Basement _____ With Plumbing _____ Without Plumbing _____

Water Supply: Well _____ Public Minimum Well Setback: _____ ft.

Type of System: Conventional Other _____

Tank Volume: Septic Tank 1000 gallons Pump Chamber _____ gallons

Nitrification Field Specifications

Number of fields 1 Number of Lines per Field 1 Length of lines 240

Width of ditches 3 ft. Depth of ditches 18-24 inches

French Drain: Linear feet required _____ Depth of gravel _____

No wastewater system shall be covered or placed into use by any person until an inspection by the Harnett County Health Department has determined that the system has been installed according to the conditions of the improvement permit and that a valid operations permit has been issued.

Authorized Agent for Harnett County Health Department

Name: [Signature] Date: 10-3-01