

HTE# 01-5-2862R

IMPROVEMENT PERMIT 22577

Be it ordained by the Harnett County Board of Health as follows: Section III, Item B. "No person shall begin construction of any building at which a septic tank system is to be used for disposal of sewage without first obtaining a written permit from the Harnett County Health Department."

Name: (owner) Jerry McDaniel New Installation Septic Tank Repair

Property Location: SR# 1440 James Morris Rd Nitrification Line Expansion

Subdivision Neills Creek Farms Lot # 132

Tax ID# _____ Quadrant # _____

Number of Bedrooms Proposed: 3 (360 sq ft) Lot Size: 7.3 Ac

Basement with Plumbing: Garage:

Water Supply: Well Public Community

Distance From Well: 50 ft.

Following is the minimum specifications for sewage disposal system on above captioned property. Subject to final approval.

Type of system: Conventional Other _____

Size of tank: Septic Tank: 1000 gallons Pump Tank: _____ gallons

Subsurface Drainage Field No. of ditches 4 exact length of each ditch 100 ft. width of ditches 3 ft. depth of ditches 18-27 in.

French Drain Required: _____ Linear feet

Date: 5/12/2006

PERMIT EXPIRES 5 YEARS FROM ABOVE DATE

This permit is subject to revocation if site plans or intended use change.

Signed: Bryan McSwain R.S.
Environmental Health Specialist

- * Maintain all setbacks
- * Run ditches on contour
- * 1st ditch can be as deep as 27 inches but NO DEEPER
- * A step down will be needed on the fourth line

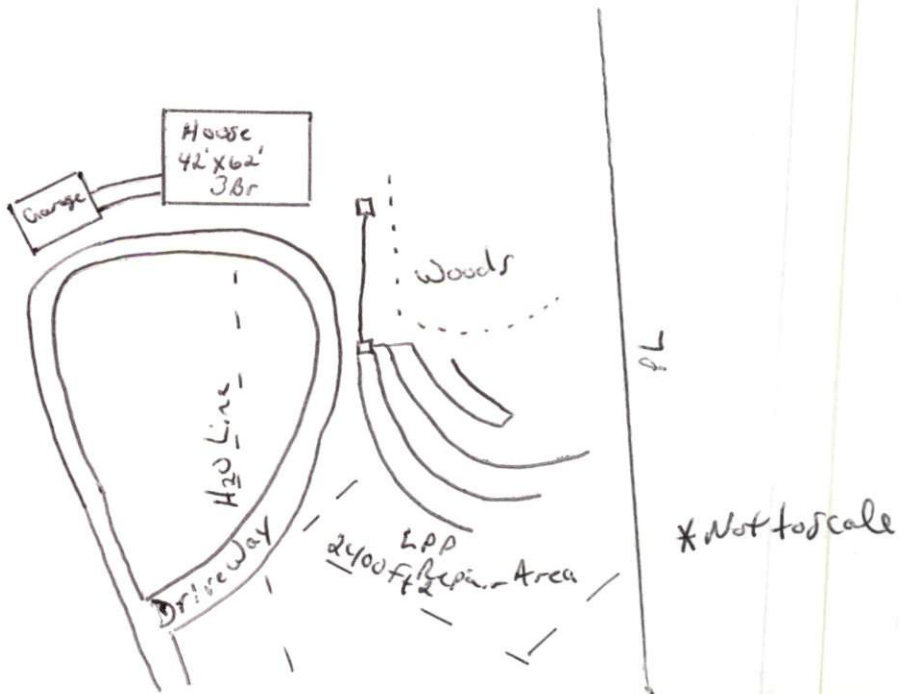

HARNETT COUNTY DEPARTMENT OF PUBLIC HEALTH AUTHORIZATION TO CONSTRUCT

Authorization is hereby given to construct a wastewater system to the specifications described by Harnett County Department of Public Health, Improvement Permit # 22577. This authorization shall be valid for a period not to exceed five (5) years from the date of issuance. ***This authorization will be invalid if ownership, site plans, or intended use change.***

Jerry McDaniel 919 557 6000
Name Telephone #

P.O. Box 1091 Fuquay Varina, N.C. 27526
Address

1440 Jones Morris
Property Location SR# Road Name

Mills Creek Farms 132 3 (360 sq. ft.) 7.3 Ac
Subdivision Lot # # Bedrooms Proposed Lot Size

TYPE OF SYSTEM

New Installation Repair Septic Tank Nitrification Lines
 Conventional Other _____

Basement With Plumbing Without Plumbing

Water Supply: Well Public Water Supply Minimum Well Setback: 50 Ft.

Septic Tank 1000 gal Pump Chamber _____ gal

NITRIFICATION FIELD SPECIFICATIONS

Number of fields 1 # of lines per field 4 Length of lines 100 Ft.

Width of ditches 3 ft. Depth of ditches 18-27 inches

French Drain: Linear feet required _____ Depth of gravel _____

No wastewater system shall be covered or placed into use by any person until an inspection by the Harnett County Health Department has determined that the system has been installed according to the conditions of the Improvement Permit and that a valid Operations Permit has been issued.

[Signature]
Signature of Authorized Agent for Harnett County

5/2/2006
Date