

01-5-2796

HARNETT COUNTY HEALTH DEPARTMENT

No 18676

IMPROVEMENT PERMIT

Be it ordained by the Harnett County Board of Health as follows: Section III, Item B. "No Person shall begin construction of any building at which a septic tank system is to be used for disposal of sewage without first obtaining a written permit from the Harnett County Health Department."

Name: (owner) WILSHAR LLC New Installation Septic Tank
Property Location: SR# 401 Repairs Nitrification Line

Subdivision WOODVIEW Lot # 26

Tax ID # _____ Quadrant # _____

Number of Bedrooms Proposed: 3 Lot Size: 30000 Ft²

Basement with Plumbing: Garage:

Water Supply: Well Public Community

Distance From Well: 100 ft.

Following is the minimum specifications for sewage disposal system on above captioned property. Subject to final approval.

Type of system: Conventional Other PUMP TO POLYSTYRENE AGGREGATE TRENCH

Size of tank: Septic Tank: 1000 gallons Pump Tank: 1000 gallons

Subsurface Drainage Field No. of ditches 2 exact length of each ditch 120 ft. width of ditches 3 ft. depth of ditches 12-14 in.

French Drain Required: _____ Linear feet

Date: 11/26/01

This permit is subject to revocation if site plans or intended use change.

Signed: [Signature]
Environmental Health Specialist

- *MAINTAIN ALL SETBACKS
- *RUN LINES ON CONTOUR
- *6" OF COVER NEEDED OVER SYSTEM
- *CALL BEFORE INSTALLATION

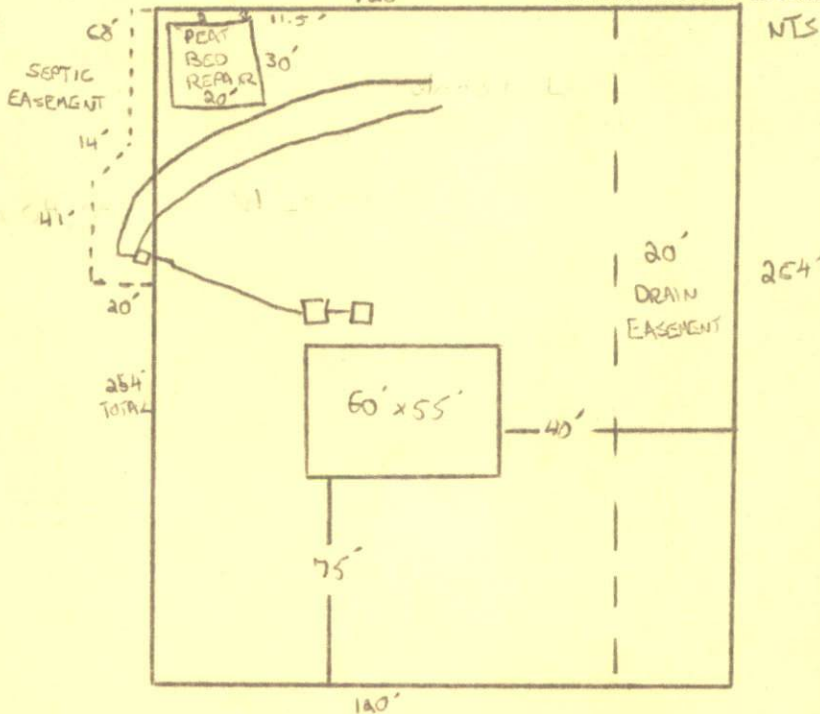

ARNETT COUNTY HEALTH DEPARTMENT
AUTHORIZATION TO CONSTRUCT

Authorization is hereby given to construct a wastewater system to the specifications described by Harnett County Health Department, Improvement Permit # 18676. This authorization shall be valid for a period not to exceed five (5) years from the date of issuance. *This authorization will be invalid if ownership, site plans, or intended use change.*

WILSHAR LLC 919-215-9861
Name Telephone #

184 JAN ST ANGIER 27501
Address

HWV 401 _____
Property Location SR# Road Name

WOODVIEW 26 3 30,000A²
Subdivision Lot # # Bedrooms Proposed Lot size

TYPE OF SYSTEM

New Installation [] Repair Septic Tank Nitrification Lines
[] Conventional Other X [] Basement [] With Plumbing [] Without Plumbing
Water Supply: [] Well Public - Minimum Well Setback: 100 Ft.

NITRIFICATION FIELD SPECIFICATIONS

Number of fields 1 # of lines per field 2 Length of lines 120 Ft.
Width of ditches 3 ft. Depth of ditches 18 inches
French Drain: Linear feet required _____ Depth of gravel _____

No wastewater system shall be covered or placed into use by any person until an inspection by the Harnett County Health Department has determined that the system has been installed according to the conditions of the Improvement Permit and that a valid Operations Permit has been issued.

[Signature] 11/26/01
Signature of Authorized Agent for Harnett County Date